







SWL kg (lb)

	B mm (inch)	B mm (inch)						
		100 (4")	150 (6")	200 (8")	300 (12")	400 (16")	500 (20")	600 (24")
 <p>3 6 9A 9B</p>		276 (609)	260 (573)	253 (558)	207 (456)	506 (1116)	460 (1014)	414 (912)
 <p>3 6 9A 9B</p>		250 (551) x 1	250 (551) x 1	250 (551) x 1	250 (551) x 2	250 (551) x 2	250 (551) x 2	250 (551) x 3
 <p>3 6</p>		176 (388)	176 (388)	176 (388)	176 (388)	161 (354)	115 (253)	87 (191)
 <p>3 6</p>		470 (1037)	400 (882)	347 (766)	275 (607)	228 (503)	195 (430)	170 (375)
 <p>6</p>		267 (589)	232 (512)	205 (452)	166 (366)	140 (309)	121 (267)	106 (234)
 <p>6 9A 9B</p>		431 (951)	368 (812)	321 (708)	255 (563)	212 (468)	182 (402)	160 (353)
 <p>6</p> <p>9A 9B</p>		837 (1846)	748 (1650)	675 (1489)	566 (1248)	487 (1074)	428 (944)	381 (840)
		875 (1929)	783 (1726)	708 (1560)	594 (1309)	428 (1128)	450 (992)	401 (884)

SV



	B		e	SWL		GS	GC	i304	i316
	mm	inch		kg	lb	REF	REF	REF	REF
SV 100	100	4"	1,5	276	609	201046	201050	201062	217828
SV 150	150	6"	1,5	260	573	201047	201051	201063	218428
SV 200	200	8"	1,5	253	558	201048	201052	201064	218429
SV 300	300	12"	1,5	207	456	201049	201053	201065	218430
SV 400	400	16"	1,5	506	1116	203413	203418	217822	218431
SV 500	500	20"	1,5	460	1014	203414	203419		
SV 600	600	24"	1,5	414	912	203415	203420	2017823	2018432

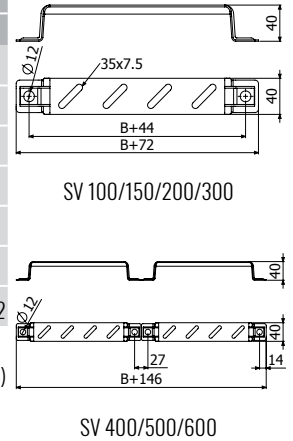

B1 (204356-EZ / 206826-GC / 204925-i304 / 218388-i316)
 CTBF (204362-EZ / 207132-GC / 204923-i304 / 208229-i316)

PBF

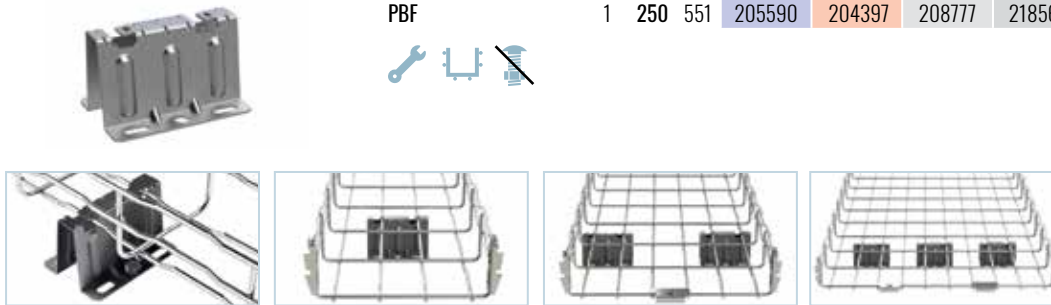

	e	SWL		GS	GC	i304	i316
		mm	kg	lb	REF	REF	REF
PBF	1	250	551	205590	204397	208777	218565

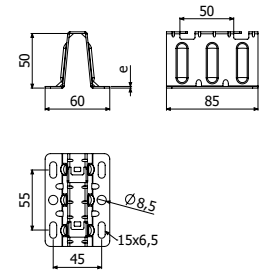

SFS + C-SVO



	B		e	SWL		GS	GC	e	i304
	mm	inch		kg	lb	REF	REF		mm
C-SVO 100	100	4"	1,5	176	388	203630	206280	1,5	206285
C-SVO 150	150	6"	1,5	176	388	201073	201078	1,5	201087
C-SVO 200	200	8"	2	176	388	201074	201079	1,5	201088
C-SVO 300	300	12"	2	176	388	201076	201081	1,5	201090
C-SVO 400	400	16"	2	161	354	203629	205719	1,5	206286
C-SVO 450	450	18"	2	115	354	201075	-	-	-
C-SVO 500	500	20"	2	115	253	201077	201082	1,5	206287
C-SVO 600	600	24"	2	87	192	205941	205720	1,5	206288
SFS 70	-	-	2	-	-	225381	-	-	-
SFS 140	-	-	2	-	-	205602	-	-	-

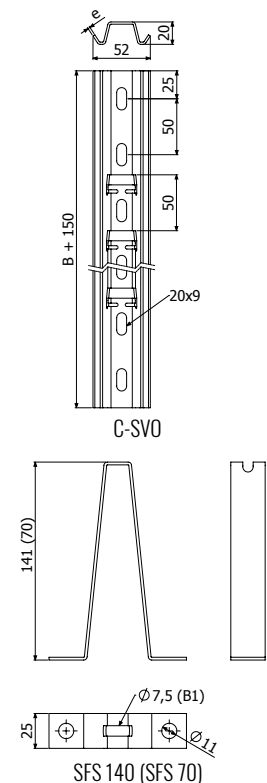

TFSO PE (200894)

	B		e	SWL		GS	GC	e	i304
	mm	inch		kg	lb	REF	REF		mm
C-SVO 3M	-	-	-	-	-	201101	207436	-	206415

2/100 x B1 (204356 EZ / 206826 GC / 204925-i304)

SP4



TF41

	L		ep	Fmáx	Mmáx	Cd	EZ	GC	e	i304	i316
	mm	inch									
SP4 400	400	16"	4	725	55,15	0,203	206832	201036	2	218132	218466
SP4 500	500	20"	6	725	55,15	0,265	206833	201037	2	218666	218669
SP4 600	600	24"	6	725	55,15	0,326	206834	204938	2	218667	218669
SP4 800	800	32"	6	725	55,15	0,509	206835	201038	-	-	-
SP4 1000	1000	40"	6	725	55,15	0,721	-	205086	-	-	-

TF41 PVC (205627)

SCR/SRB(GG)+2xTEPM10x30(217567-EZ)/
SCR/SRB+2xTM41M8(217583-GC/218524-i304/217611-i316)
+2xDIN933M8x30(205964 i304)+2xDIN125M8(217544- i304)
+2x4182K(218515-GC/218758-i304)

SHL/SP/SHR+2xDIN933M10x30(217547-i304/217600-i316)
+2xTM41M10(217584-GC/218525-i304/217612-
i316)+2xDIN125M10(217542-i304/218741-i316)

SCR/SRB+2/100xB2(206792-GC/205392-i304/218443-i316)

SHL+2/50xB3(208827-GC/212096-i304/215575-i316)

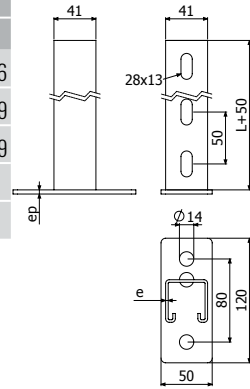

SZ



	L		e	ep	Fmáx	Mmáx	Cd	GC
	mm	inch						
SZ 300	300	12"	3	3	556	54,1	0,224	201069
SZ 400	400	16"	3	3	556	54,1	0,259	201070
SZ 500	500	20"	3	3	556	54,1	0,345	201071
SZ 600	600	24"	3	3	556	54,1	0,483	201072

SCR/SRB/SHL + 2/100 x B2 (206792-GC)

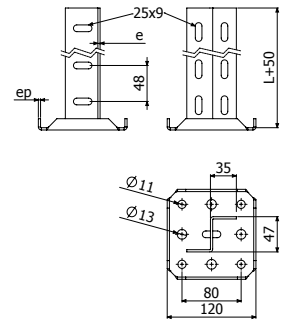

SU



SU



	L		e	ep	Fmáx	Mmáx	Cd	GC	i304	i316
	mm	inch								
SU 400	400	16"	2,5	6	656	51,55	0,191	207142	217148	218473
SU 600	600	24"	2,5	6	656	51,55	0,287	207143	217149	218474
SU 800	800	32"	2,5	6	656	51,55	0,398	207144	217150	218475

TFSU PVC (212114)

SCR/SRB/SHL/SHR + 2/100 x B2 (204926-EZ / 206792-GC /
205392-i304 / 218443-i316)

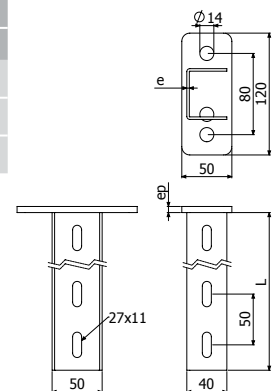

TFSU



SP4D



TF41

	L		e	ep	Fmáx	Mmáx	Cd	GC	e	Fmáx	Mmáx	Cd	i304	i316
	mm	inch	mm	mm	kg	kg-m	mm/kg-m	REF	mm	kg	kg-m	mm/kg-m	REF	REF
SP4D 500	500	20"	2,5	8	1100	133	0,147	206272	2	1144	141	0,139	218134	218468
SP4D 600	600	24"	2,5	8	1100	133	0,179	205621	2	1144	141	0,17	218135	218469
SP4D 700	700	28"	2,5	8	1100	133	0,211	206273	2	1144	141	0,2	218136	218470
SP4D 800	800	32"	2,5	8	1100	133	0,263	206274	2	1144	141	0,249	218137	218471
SP4D 1000	1000	40"	2,5	8	1100	133	0,316	204641	2	1144	141	0,299	218138	218472
SP4D 1500	1500	60"	2,5	8	1100	133	-	204642	-	-	-	-	-	-
SP4D 2000	2000	80"	2,5	8	1100	133	-	218740	-	-	-	-	-	-

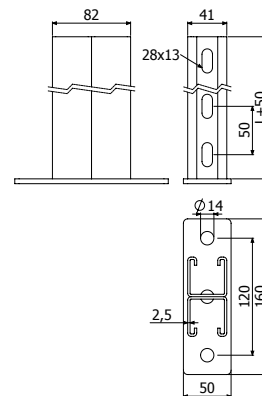

TF41 PVC (205627)

-  SCR/SRB (€€) + 2 x TEP M10x30 (217567-EZ)
-  SCR/SRB + 2 x TM41 M8 (217583-GC / 218524-i304 / 217611-i316) + 2 x DIN933 M8x30 (205964-i304) + 2 x DIN125 M8 (217544-i304) + 2 x 4182K (218515-GC / 218758-i304)
-  SHL/SHR/SP4/SP4D + 2 x DIN933 M10x30 (217547-i304) + 2 x TM41 M10 (217584-GC / 218525-i304 / 217612-i316) 217600-i316 (217600-i316) + 2 x DIN125 M10 (217542-i304 / 218741-i316)







SWL kg (lb)

	B mm (inch)									
	50 (2")	100 (4")	150 (6")	200 (8")	300 (12")	400 (16")	500 (20")	600 (24")	700 (28")	800 (32")
 C-PC+C-SR GS i304 i316	-	-	-	102 (225)	90 (198)	159 (351)	134 (295)	117 (258)	-	-
 PC+C-SR GC	-	-	-	250 (551)	250 (551)	250 (551)	200 (441)	175 (386)	-	-
 BI8+I8+SHV GC	-	-	-	200 (441)	200 (441)	200 (441)	200 (441)	200 (441)	200 (441)	200 (441)
 KCT30+CT30 (SCR/SRB) GS GC	235 (518)	186 (410)	154 (340)	131 (289)	101 (223)	82 (181)	69 (152)	60 (132)	-	-
 KLPC+C-PC (SCR/SRB) GS	183 (404)	153 (337)	132 (291)	115 (254)	93 (205)	77 (170)	66 (146)	58 (128)	-	-
 KPC+C-PC (C-SR) GS i304 i316	191 (421)	156 (344)	132 (291)	114 (251)	90 (198)	74 (163)	63 (139)	55 (121)	-	-
 KPC+2 x C-PC (C-SR) GS i304 i316	260 (573)	221 (487)	192 (423)	170 (375)	138 (304)	117 (258)	101 (223)	89 (196)	-	-
 KAPC+PC (C-SR) GC	144 (318)	127 (280)	113 (249)	102 (225)	85 (187)	73 (161)	64 (141)	57 (126)	-	-
 KI8+I8 (SHV) GC	-	-	-	832 (1835)	700 (1544)	604 (1332)	531 (1171)	474 (1045)	428 (944)	390 (881)

SWL kg (lb)

	B mm (inch)									
	50 (2")	100 (4")	150 (6")	200 (8")	300 (12")	400 (16")	500 (20")	600 (24")	700 (28")	800 (32")
 <p>KLPC+C-PC (SCR/SRB) GS</p>	172 (379)	142 (313)	121 (267)	105 (232)	83 (183)	69 (152)	59 (130)	51 (112)	-	-
 <p>KAPC+PC (C-SR) GC</p>	191 (421)	156 (344)	132 (291)	114 (251)	90 (198)	74 (163)	63 (139)	55 (121)	-	-
 <p>KA18+18 (SHV) GC</p>	-	-	-	242 (534)	186 (410)	151 (333)	127 (280)	110 (243)	96 (212)	86 (190)