

# BasorTrav / IL / IS / IR

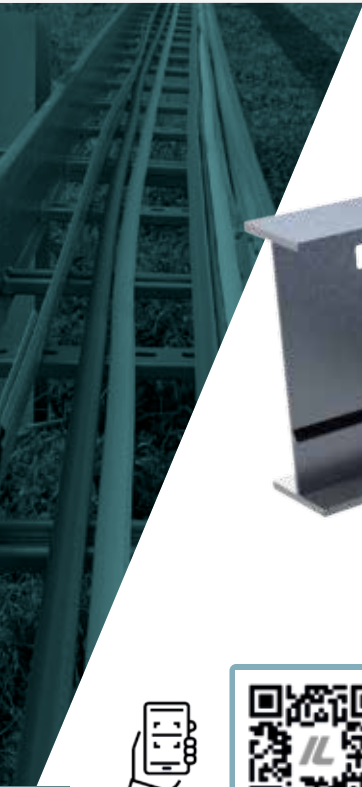

BasorTRAV

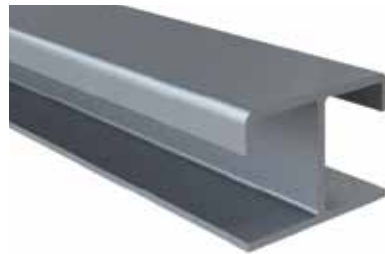

1"



B		Filling Area					
		H4"		H5"		H6"	
inch	mm	in <sup>2</sup>	cm <sup>2</sup>	in <sup>2</sup>	cm <sup>2</sup>	in <sup>2</sup>	cm <sup>2</sup>
6"	150	17,0	109	23,0	148	29,0	187
9"	230	25,5	164	34,5	222	43,5	280
12"	300	34,1	219	46,1	297	58,1	374
18"	450	51,1	329	69,1	445	87,1	561
24"	600	68,2	439	92,2	594	116,2	749
30"	750	85,2	549	115,2	743	145,2	936
36"	900	102,3	659	138,3	892	174,3	1124

	NEMA VE 1 - SAFE WORKING LOAD CLASSIFICATION			
	2,4 m (8 ft)	3,7 m (12 ft)	4,9 m (16 ft)	6,0 m (20 ft)
IL H4"	8C+	12C	16A	20AA
IL H5"	8C+	12C	16A	20AA
IL H6"	-	12C	16B	20A
IS H4"	-	12C	16B	20A
IS H5"	-	12C	16B	20A
IS H6"	-	12C	16C	20B
IR H4"	-	12C+	16B	20B
IR H5"	-	12C+	16B	20B
IR H6"	-	-	16C+	20C

**IL H4**  
(NEMA 16A / 12C)



L = 6 m (20 ft)

	B		H		AL		
					p = 6" (150 mm)	p = 9" (230 mm)	p = 12" (300 mm)
	inch	mm	inch	mm	REF	REF	REF
IL 6x4-p 6M	6	150	4	100	210305	210324	210343
IL 9x4-p 6M	9	230	4	100	210306	210325	210344
IL 12x4-p 6M	12	300	4	100	210307	210326	210345
IL 18x4-p 6M	18	450	4	100	210308	210327	210346
IL 24x4-p 6M	24	600	4	100	210309	210328	210347
IL 30x4-p 6M	30	750	4	100	210310	210329	210348
IL 36x4-p 6M	36	900	4	100	210311	210330	210349

2 x JUI 4 ( 211220)

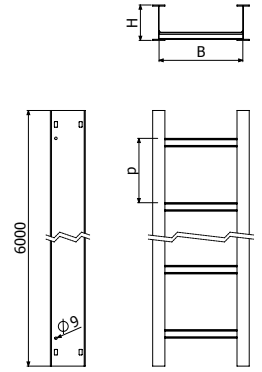

**IL H5**  
(NEMA 16A / 12C)



L = 6 m (20 ft)

	B		H		AL		
					p = 6" (150 mm)	p = 9" (230 mm)	p = 12" (300 mm)
	inch	mm	inch	mm	REF	REF	REF
IL-6x5-p 6M	6	150	5	125	214942	214943	214944
IL 9x5-p 6M	9	230	5	125	210312	210331	210350
IL 12x5-p 6M	12	300	5	125	210313	210332	210351
IL 18x5-p 6M	18	450	5	125	210314	210333	210352
IL 24x5-p 6M	24	600	5	125	210315	210334	210353
IL 30x5-p 6M	30	750	5	125	210316	210335	210354
IL 36x5-p 6M	36	900	5	125	210317	210336	210355

2 x JUI 5 ( 211221)

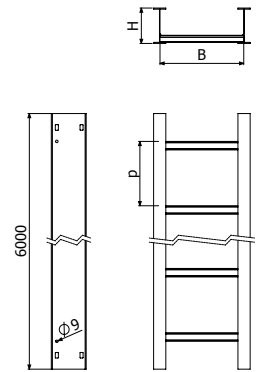

**IL H6**  
(NEMA 20A / 16B / 12C)



L = 6 m (20 ft)

	B		H		AL		
					p = 6" (150 mm)	p = 9" (230 mm)	p = 12" (300 mm)
	inch	mm	inch	mm	REF	REF	REF
IL 9x6-p 6M	9	230	6	150	210318	210337	210356
IL 12x6-p 6M	12	300	6	150	210319	210338	210357
IL 18x6-p 6M	18	450	6	150	210320	210339	210358
IL 24x6-p 6M	24	600	6	150	210321	210340	210359
IL 30x6-p 6M	30	750	6	150	210322	210341	210360
IL 36x6-p 6M	36	900	6	150	210323	210342	210361

2 x JUI 6 ( 211222)

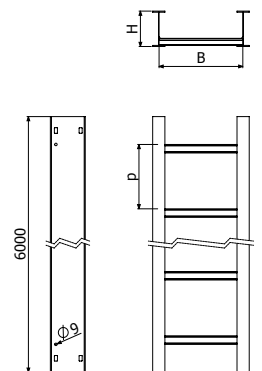

### IS H4 (NEMA 20A / 16B)



L = 6 m (20 ft)

	B		H		AL		
					p = 6" (150 mm)	p = 9" (230 mm)	p = 12" (300 mm)
	inch	mm	inch	mm	REF	REF	REF
IS 6x4-p 6M	6	150	4	100	210362	210381	210400
IS 9x4-p 6M	9	230	4	100	210363	210382	210401
IS 12x4-p 6M	12	300	4	100	210364	210383	210402
IS 18x4-p 6M	18	450	4	100	210365	210384	210403
IS 24x4-p 6M	24	600	4	100	210366	210385	210404
IS 30x4-p 6M	30	750	4	100	210367	210386	210405
IS 36x4-p 6M	36	900	4	100	210368	210387	210406

2 x JUI 4 ( 211220)

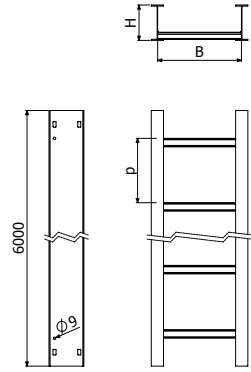

### IS H5 (NEMA 20A / 16B / 12C)



L = 6 m (20 ft)

	B		H		AL		
					p = 6" (150 mm)	p = 9" (230 mm)	p = 12" (300 mm)
	inch	mm	inch	mm	REF	REF	REF
IS 6x5-p 6M	6	150	5	125	214945	214946	214947
IS 9x5-p 6M	9	230	5	125	210369	210388	210407
IS 12x5-p 6M	12	300	5	125	210370	210389	210408
IS 18x5-p 6M	18	450	5	125	210371	210390	210409
IS 24x5-p 6M	24	600	5	125	210372	210391	210410
IS 30x5-p 6M	30	750	5	125	210373	210392	210411
IS 36x5-p 6M	36	900	5	125	210374	210393	210412

2 x JUI 5 ( 211221)

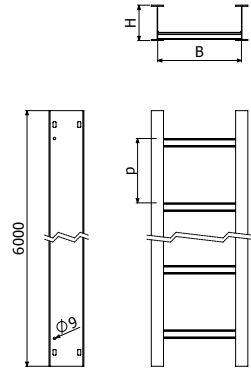

### IS H6 (NEMA 20B / 16C)



L = 6 m (20 ft)

	B		H		AL		
					p = 6" (150 mm)	p = 9" (230 mm)	p = 12" (300 mm)
	inch	mm	inch	mm	REF	REF	REF
IS 9x6-p 6M	9	230	6	150	210375	210394	210413
IS 12x6-p 6M	12	300	6	150	210376	210395	210414
IS 18x6-p 6M	18	450	6	150	210377	210396	210415
IS 24x6-p 6M	24	600	6	150	210378	210397	210416
IS 30x6-p 6M	30	750	6	150	210379	210398	210417
IS 36x6-p 6M	36	900	6	150	210380	210399	210418

2 x JUI 6 ( 211222)

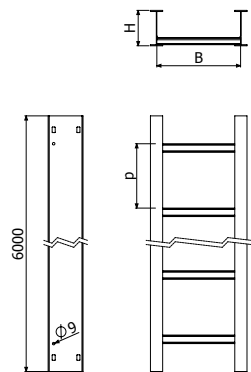

**IR H4**  
(NEMA 20B / 16C)



L = 6 m (20 ft)

	B		H		AL		
					p = 6" (150 mm)	p = 9" (230 mm)	p = 12" (300 mm)
	inch	mm	inch	mm	REF	REF	REF
IR 6x4-p 6M	6	150	4	100	210419	210438	210457
IR 9x4-p 6M	9	230	4	100	210420	210439	210458
IR 12x4-p 6M	12	300	4	100	210421	210440	210459
IR 18x4-p 6M	18	450	4	100	210422	210441	210460
IR 24x4-p 6M	24	600	4	100	210423	210442	210461
IR 30x4-p 6M	30	750	4	100	210424	210443	210462
IR 36x4-p 6M	36	900	4	100	210425	210444	210463

2 x JUI 4 ( 211220)

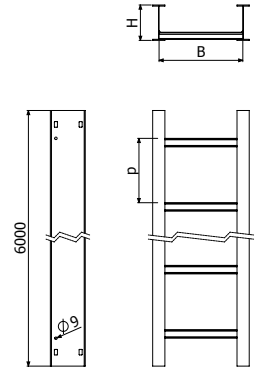

**IR H5**  
(NEMA 20BA / 16C)



L = 6 m (20 ft)

	B		H		AL		
					p = 6" (150 mm)	p = 9" (230 mm)	p = 12" (300 mm)
	inch	mm	inch	mm	REF	REF	REF
IR 6x5-p 6M	6	150	5	125	214948	214949	214950
IR 9x5-p 6M	9	230	5	125	210426	210445	210464
IR 12x5-p 6M	12	300	5	125	210427	210446	210465
IR 18x5-p 6M	18	450	5	125	210428	210447	210466
IR 24x5-p 6M	24	600	5	125	210429	210448	210467
IR 30x5-p 6M	30	750	5	125	210430	210449	210468
IR 36x5-p 6M	36	900	5	125	210431	210450	210469

2 x JUI 5 ( 211221)

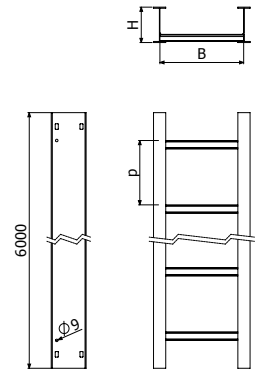

**IR H6**  
(NEMA 20C)



L = 6 m (20 ft)

	B		H		AL		
					p = 6" (150 mm)	p = 9" (230 mm)	p = 12" (300 mm)
	inch	mm	inch	mm	REF	REF	REF
IR 9x6-p 6M	9	230	6	150	210432	210451	210470
IR 12x6-p 6M	12	300	6	150	210433	210452	210471
IR 18x6-p 6M	18	450	6	150	210434	210453	210472
IR 24x6-p 6M	24	600	6	150	210435	210454	210473
IR 30x6-p 6M	30	750	6	150	210436	210455	210474
IR 36x6-p 6M	36	900	6	150	210437	210456	210475

2 x JUI 6 ( 211222)

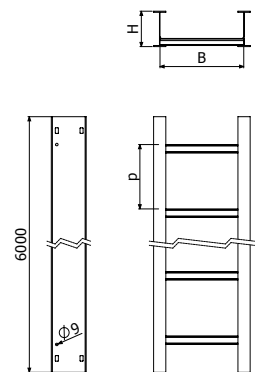

# BasorTrav / IL / IS / IR

ACCESSORIES



BasorTRAV



CPI



CCI



CXI



CRI



TEI



RII



RDI



PSI



JUI



JUI-A



JUI-B



BEV

CPI H4



CPI 'A' - 'R' 'B'x'H'



	A (°)	R		B		H		AL
		inch	mm	inch	mm	inch	mm	REF
CPI30-12 6x4	30	12	300	6	150	4	100	210476
CPI30-12 9x4	30	12	300	9	230	4	100	210477
CPI30-12 12x4	30	12	300	12	300	4	100	210478
CPI30-12 18x4	30	12	300	18	450	4	100	210479
CPI30-12 24x4	30	12	300	24	600	4	100	210480
CPI30-12 30x4	30	12	300	30	750	4	100	210481
CPI30-12 36x4	30	12	300	36	900	4	100	210482
CPI45-12 6x4	45	12	300	6	150	4	100	210483
CPI45-12 9x4	45	12	300	9	230	4	100	210484
CPI45-12 12x4	45	12	300	12	300	4	100	210485
CPI45-12 18x4	45	12	300	18	450	4	100	210486
CPI45-12 24x4	45	12	300	24	600	4	100	210487
CPI45-12 30x4	45	12	300	30	750	4	100	210488
CPI45-12 36x4	45	12	300	36	900	4	100	210489
CPI-12 6x4	90	12	300	6	150	4	100	210490
CPI-12 9x4	90	12	300	9	230	4	100	210491
CPI-12 12x4	90	12	300	12	300	4	100	210492
CPI-12 18x4	90	12	300	18	450	4	100	210493
CPI-12 24x4	90	12	300	24	600	4	100	210494
CPI-12 30x4	90	12	300	30	750	4	100	210495
CPI-12 36x4	90	12	300	36	900	4	100	210496
CPI30-24 6x4	30	24	600	6	150	4	100	210497
CPI30-24 9x4	30	24	600	9	230	4	100	210498
CPI30-24 12x4	30	24	600	12	300	4	100	210499
CPI30-24 18x4	30	24	600	18	450	4	100	210500
CPI30-24 24x4	30	24	600	24	600	4	100	210501
CPI30-24 30x4	30	24	600	30	750	4	100	210502
CPI30-24 36x4	30	24	600	36	900	4	100	210503
CPI45-24 6x4	45	24	600	6	150	4	100	210504
CPI45-24 9x4	45	24	600	9	230	4	100	210505
CPI45-24 12x4	45	24	600	12	300	4	100	210506
CPI45-24 18x4	45	24	600	18	450	4	100	210507
CPI45-24 24x4	45	24	600	24	600	4	100	210508
CPI45-24 30x4	45	24	600	30	750	4	100	210509
CPI45-24 36x4	45	24	600	36	900	4	100	210510
CPI-24 6x4	90	24	600	6	150	4	100	210511
CPI-24 9x4	90	24	600	9	230	4	100	210512
CPI-24 12x4	90	24	600	12	300	4	100	210513
CPI-24 18x4	90	24	600	18	450	4	100	210514
CPI-24 24x4	90	24	600	24	600	4	100	210515
CPI-24 30x4	90	24	600	30	750	4	100	210516
CPI-24 36x4	90	24	600	36	900	4	100	210517
CPI30-36 6x4	30	36	900	6	150	4	100	210518
CPI30-36 9x4	30	36	900	9	230	4	100	210519
CPI30-36 12x4	30	36	900	12	300	4	100	210520
CPI30-36 18x4	30	36	900	18	450	4	100	210521
CPI30-36 24x4	30	36	900	24	600	4	100	210522
CPI30-36 30x4	30	36	900	30	750	4	100	210523
CPI30-36 36x4	30	36	900	36	900	4	100	210524
CPI45-36 6x4	45	36	900	6	150	4	100	210525
CPI45-36 9x4	45	36	900	9	230	4	100	210526
CPI45-36 12x4	45	36	900	12	300	4	100	210527
CPI45-36 18x4	45	36	900	18	450	4	100	210528
CPI45-36 24x4	45	36	900	24	600	4	100	210529
CPI45-36 30x4	45	36	900	30	750	4	100	210530
CPI45-36 36x4	45	36	900	36	900	4	100	210531
CPI-36 6x4	90	36	900	6	150	4	100	210532
CPI-36 9x4	90	36	900	9	230	4	100	210533
CPI-36 12x4	90	36	900	12	300	4	100	210534
CPI-36 18x4	90	36	900	18	450	4	100	210535
CPI-36 24x4	90	36	900	24	600	4	100	210536
CPI-36 30x4	90	36	900	30	750	4	100	210537
CPI-36 36x4	90	36	900	36	900	4	100	210538

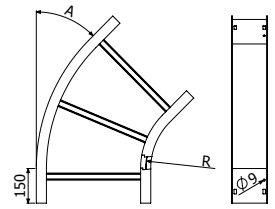
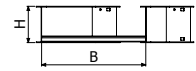

CPI 'A' - 'R' 'B'x'H'

2 x JUL 4 ( 211220)

CCI H4



CCI 'A' - 'R' 'B'x'H'

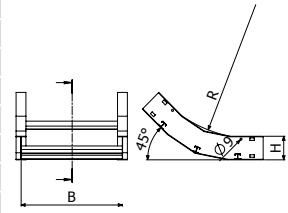

CCI 'A' - 'R' 'B'x'H'

	A (°)	R		B		H		AL
		inch	mm	inch	mm	inch	mm	REF
CCI30-12 6x4	30	12	300	6	150	4	100	210647
CCI30-12 9x4	30	12	300	9	230	4	100	210648
CCI30-12 12x4	30	12	300	12	300	4	100	210649
CCI30-12 18x4	30	12	300	18	450	4	100	210650
CCI30-12 24x4	30	12	300	24	600	4	100	210651
CCI30-12 30x4	30	12	300	30	750	4	100	210652
CCI30-12 36x4	30	12	300	36	900	4	100	210653
CCI45-12 6x4	45	12	300	6	150	4	100	210654
CCI45-12 9x4	45	12	300	9	230	4	100	210655
CCI45-12 12x4	45	12	300	12	300	4	100	210656
CCI45-12 18x4	45	12	300	18	450	4	100	210657
CCI45-12 24x4	45	12	300	24	600	4	100	210658
CCI45-12 30x4	45	12	300	30	750	4	100	210659
CCI45-12 36x4	45	12	300	36	900	4	100	210660
CCI-12 6x4	90	12	300	6	150	4	100	210661
CCI-12 9x4	90	12	300	9	230	4	100	210662
CCI-12 12x4	90	12	300	12	300	4	100	210663
CCI-12 18x4	90	12	300	18	450	4	100	210664
CCI-12 24x4	90	12	300	24	600	4	100	210665
CCI-12 30x4	90	12	300	30	750	4	100	210666
CCI-12 36x4	90	12	300	36	900	4	100	210667
CCI30-24 6x4	30	24	600	6	150	4	100	210668
CCI30-24 9x4	30	24	600	9	230	4	100	210669
CCI30-24 12x4	30	24	600	12	300	4	100	210670
CCI30-24 18x4	30	24	600	18	450	4	100	210671
CCI30-24 24x4	30	24	600	24	600	4	100	210672
CCI30-24 30x4	30	24	600	30	750	4	100	210673
CCI30-24 36x4	30	24	600	36	900	4	100	210674
CCI45-24 6x4	45	24	600	6	150	4	100	210675
CCI45-24 9x4	45	24	600	9	230	4	100	210676
CCI45-24 12x4	45	24	600	12	300	4	100	210677
CCI45-24 18x4	45	24	600	18	450	4	100	210678
CCI45-24 24x4	45	24	600	24	600	4	100	210679
CCI45-24 30x4	45	24	600	30	750	4	100	210680
CCI45-24 36x4	45	24	600	36	900	4	100	210681
CCI-24 6x4	90	24	600	6	150	4	100	210682
CCI-24 9x4	90	24	600	9	230	4	100	210683
CCI-24 12x4	90	24	600	12	300	4	100	210684
CCI-24 18x4	90	24	600	18	450	4	100	210685
CCI-24 24x4	90	24	600	24	600	4	100	210686
CCI-24 30x4	90	24	600	30	750	4	100	210687
CCI-24 36x4	90	24	600	36	900	4	100	210688
CCI30-36 6x4	30	36	900	6	150	4	100	210689
CCI30-36 9x4	30	36	900	9	230	4	100	210690
CCI30-36 12x4	30	36	900	12	300	4	100	210691
CCI30-36 18x4	30	36	900	18	450	4	100	210692
CCI30-36 24x4	30	36	900	24	600	4	100	210693
CCI30-36 30x4	30	36	900	30	750	4	100	210694
CCI30-36 36x4	30	36	900	36	900	4	100	210695
CCI45-36 6x4	45	36	900	6	150	4	100	210696
CCI45-36 9x4	45	36	900	9	230	4	100	210697
CCI45-36 12x4	45	36	900	12	300	4	100	210698
CCI45-36 18x4	45	36	900	18	450	4	100	210699
CCI45-36 24x4	45	36	900	24	600	4	100	210700
CCI45-36 30x4	45	36	900	30	750	4	100	210701
CCI45-36 36x4	45	36	900	36	900	4	100	210702
CCI-36 6x4	90	36	900	6	150	4	100	210703
CCI-36 9x4	90	36	900	9	230	4	100	210704
CCI-36 12x4	90	36	900	12	300	4	100	210705
CCI-36 18x4	90	36	900	18	450	4	100	210706
CCI-36 24x4	90	36	900	24	600	4	100	210707
CCI-36 30x4	90	36	900	30	750	4	100	210708
CCI-36 36x4	90	36	900	36	900	4	100	210709

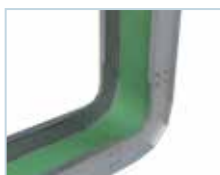

2 x JUL 4 ( 211220)

CXI H4



CXI 'A' - 'R' 'B'x'H'

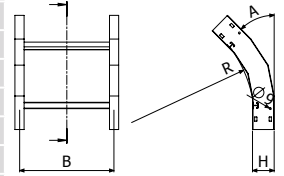

CXI 'A' - 'R' 'B'x'H'

	A (°)	R		B		H		AL
		inch	mm	inch	mm	inch	mm	REF
CXI30-12 6x4	30	12	300	6	150	4	100	210818
CXI30-12 9x4	30	12	300	9	230	4	100	210819
CXI30-12 12x4	30	12	300	12	300	4	100	210820
CXI30-12 18x4	30	12	300	18	450	4	100	210821
CXI30-12 24x4	30	12	300	24	600	4	100	210822
CXI30-12 30x4	30	12	300	30	750	4	100	210823
CXI30-12 36x4	30	12	300	36	900	4	100	210824
CXI45-12 6x4	45	12	300	6	150	4	100	210825
CXI45-12 9x4	45	12	300	9	230	4	100	210826
CXI45-12 12x4	45	12	300	12	300	4	100	210827
CXI45-12 18x4	45	12	300	18	450	4	100	210828
CXI45-12 24x4	45	12	300	24	600	4	100	210829
CXI45-12 30x4	45	12	300	30	750	4	100	210830
CXI45-12 36x4	45	12	300	36	900	4	100	210831
CXI-12 6x4	90	12	300	6	150	4	100	210832
CXI-12 9x4	90	12	300	9	230	4	100	210833
CXI-12 12x4	90	12	300	12	300	4	100	210834
CXI-12 18x4	90	12	300	18	450	4	100	210835
CXI-12 24x4	90	12	300	24	600	4	100	210836
CXI-12 30x4	90	12	300	30	750	4	100	210837
CXI-12 36x4	90	12	300	36	900	4	100	210838
CXI30-24 6x4	30	24	600	6	150	4	100	210839
CXI30-24 9x4	30	24	600	9	230	4	100	210840
CXI30-24 12x4	30	24	600	12	300	4	100	210841
CXI30-24 18x4	30	24	600	18	450	4	100	210842
CXI30-24 24x4	30	24	600	24	600	4	100	210843
CXI30-24 30x4	30	24	600	30	750	4	100	210844
CXI30-24 36x4	30	24	600	36	900	4	100	210845
CXI45-24 6x4	45	24	600	6	150	4	100	210846
CXI45-24 9x4	45	24	600	9	230	4	100	210847
CXI45-24 12x4	45	24	600	12	300	4	100	210848
CXI45-24 18x4	45	24	600	18	450	4	100	210849
CXI45-24 24x4	45	24	600	24	600	4	100	210850
CXI45-24 30x4	45	24	600	30	750	4	100	210851
CXI45-24 36x4	45	24	600	36	900	4	100	210852
CXI-24 6x4	90	24	600	6	150	4	100	210853
CXI-24 9x4	90	24	600	9	230	4	100	210854
CXI-24 12x4	90	24	600	12	300	4	100	210855
CXI-24 18x4	90	24	600	18	450	4	100	210856
CXI-24 24x4	90	24	600	24	600	4	100	210857
CXI-24 30x4	90	24	600	30	750	4	100	210858
CXI-24 36x4	90	24	600	36	900	4	100	210859
CXI30-36 6x4	30	36	900	6	150	4	100	210860
CXI30-36 9x4	30	36	900	9	230	4	100	210861
CXI30-36 12x4	30	36	900	12	300	4	100	210862
CXI30-36 18x4	30	36	900	18	450	4	100	210863
CXI30-36 24x4	30	36	900	24	600	4	100	210864
CXI30-36 30x4	30	36	900	30	750	4	100	210865
CXI30-36 36x4	30	36	900	36	900	4	100	210866
CXI45-36 6x4	45	36	900	6	150	4	100	210867
CXI45-36 9x4	45	36	900	9	230	4	100	210868
CXI45-36 12x4	45	36	900	12	300	4	100	210869
CXI45-36 18x4	45	36	900	18	450	4	100	210870
CXI45-36 24x4	45	36	900	24	600	4	100	210871
CXI45-36 30x4	45	36	900	30	750	4	100	210872
CXI45-36 36x4	45	36	900	36	900	4	100	210873
CXI-36 6x4	90	36	900	6	150	4	100	210874
CXI-36 9x4	90	36	900	9	230	4	100	210875
CXI-36 12x4	90	36	900	12	300	4	100	210876
CXI-36 18x4	90	36	900	18	450	4	100	210877
CXI-36 24x4	90	36	900	24	600	4	100	210878
CXI-36 30x4	90	36	900	30	750	4	100	210879
CXI-36 36x4	90	36	900	36	900	4	100	210880



CPI H5



CPI 'A' - 'R' 'B'x'H'

	A (°)	R		B		H		AL
		inch	mm	inch	mm	inch	mm	REF
CPI30-12 6x5	30	12	300	6	150	5	125	214951
CPI30-12 9x5	30	12	300	9	230	5	125	210539
CPI30-12 12x5	30	12	300	12	300	5	125	210540
CPI30-12 18x5	30	12	300	18	450	5	125	210541
CPI30-12 24x5	30	12	300	24	600	5	125	210542
CPI30-12 30x5	30	12	300	30	750	5	125	210543
CPI30-12 36x5	30	12	300	36	900	5	125	210544
CPI45-12 6x5	45	12	300	6	150	5	125	214952
CPI45-12 9x5	45	12	300	9	230	5	125	210545
CPI45-12 12x5	45	12	300	12	300	5	125	210546
CPI45-12 18x5	45	12	300	18	450	5	125	210547
CPI45-12 24x5	45	12	300	24	600	5	125	210548
CPI45-12 30x5	45	12	300	30	750	5	125	210549
CPI45-12 36x5	45	12	300	36	900	5	125	210550
CPI-12 6x5	90	12	300	6	150	5	125	214953
CPI-12 9x5	90	12	300	9	230	5	125	210551
CPI-12 12x5	90	12	300	12	300	5	125	210552
CPI-12 18x5	90	12	300	18	450	5	125	210553
CPI-12 24x5	90	12	300	24	600	5	125	210554
CPI-12 30x5	90	12	300	30	750	5	125	210555
CPI-12 36x5	90	12	300	36	900	5	125	210556
CPI30-24 6x5	30	24	600	6	150	5	125	214954
CPI30-24 9x5	30	24	600	9	230	5	125	210557
CPI30-24 12x5	30	24	600	12	300	5	125	210558
CPI30-24 18x5	30	24	600	18	450	5	125	210559
CPI30-24 24x5	30	24	600	24	600	5	125	210560
CPI30-24 30x5	30	24	600	30	750	5	125	210561
CPI30-24 36x5	30	24	600	36	900	5	125	210562
CPI45-24 6x5	45	24	600	6	150	5	125	214955
CPI45-24 9x5	45	24	600	9	230	5	125	210563
CPI45-24 12x5	45	24	600	12	300	5	125	210564
CPI45-24 18x5	45	24	600	18	450	5	125	210565
CPI45-24 24x5	45	24	600	24	600	5	125	210566
CPI45-24 30x5	45	24	600	30	750	5	125	210567
CPI45-24 36x5	45	24	600	36	900	5	125	210568
CPI-24 6x5	90	24	600	6	150	5	125	214956
CPI-24 9x5	90	24	600	9	230	5	125	210569
CPI-24 12x5	90	24	600	12	300	5	125	210570
CPI-24 18x5	90	24	600	18	450	5	125	210571
CPI-24 24x5	90	24	600	24	600	5	125	210572
CPI-24 30x5	90	24	600	30	750	5	125	210573
CPI-24 36x5	90	24	600	36	900	5	125	210574
CPI30-36 6x5	30	36	900	6	150	5	125	214957
CPI30-36 9x5	30	36	900	9	230	5	125	210575
CPI30-36 12x5	30	36	900	12	300	5	125	210576
CPI30-36 18x5	30	36	900	18	450	5	125	210577
CPI30-36 24x5	30	36	900	24	600	5	125	210578
CPI30-36 30x5	30	36	900	30	750	5	125	210579
CPI30-36 36x5	30	36	900	36	900	5	125	210580
CPI45-36 6x5	45	36	900	6	150	5	125	214958
CPI45-36 9x5	45	36	900	9	230	5	125	210581
CPI45-36 12x5	45	36	900	12	300	5	125	210582
CPI45-36 18x5	45	36	900	18	450	5	125	210583
CPI45-36 24x5	45	36	900	24	600	5	125	210584
CPI45-36 30x5	45	36	900	30	750	5	125	210585
CPI45-36 36x5	45	36	900	36	900	5	125	210586
CPI-36 6x5	90	36	900	6	150	5	125	214959
CPI-36 9x5	90	36	900	9	230	5	125	210587
CPI-36 12x5	90	36	900	12	300	5	125	210588
CPI-36 18x5	90	36	900	18	450	5	125	210589
CPI-36 24x5	90	36	900	24	600	5	125	210590
CPI-36 30x5	90	36	900	30	750	5	125	210591
CPI-36 36x5	90	36	900	36	900	5	125	210592

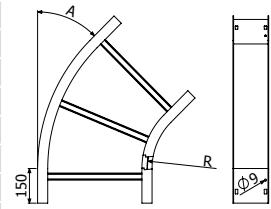
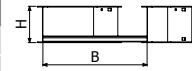

CPI 'A' - 'R' 'B'x'H'



2 x JUI 5 ( 211221)

CCI H5



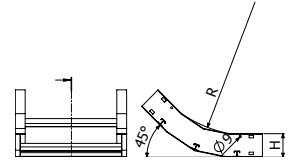

CCI 'A' - 'R' 'B'x'H'

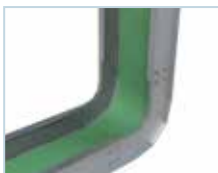

CCI 'A' - 'R' 'B'x'H'

	A (°)	R		B		H		AL
		inch	mm	inch	mm	inch	mm	REF
CCI30-12 6x5	30	12	300	6	150	5	125	214960
CCI30-12 9x5	30	12	300	9	230	5	125	210710
CCI30-12 12x5	30	12	300	12	300	5	125	210711
CCI30-12 18x5	30	12	300	18	450	5	125	210712
CCI30-12 24x5	30	12	300	24	600	5	125	210713
CCI30-12 30x5	30	12	300	30	750	5	125	210714
CCI30-12 36x5	30	12	300	36	900	5	125	210715
CCI45-12 6x5	45	12	300	6	150	5	125	214961
CCI45-12 9x5	45	12	300	9	230	5	125	210716
CCI45-12 12x5	45	12	300	12	300	5	125	210717
CCI45-12 18x5	45	12	300	18	450	5	125	210718
CCI45-12 24x5	45	12	300	24	600	5	125	210719
CCI45-12 30x5	45	12	300	30	750	5	125	210720
CCI45-12 36x5	45	12	300	36	900	5	125	210721
CCI-12 6x5	90	12	300	6	150	5	125	214962
CCI-12 9x5	90	12	300	9	230	5	125	210722
CCI-12 12x5	90	12	300	12	300	5	125	210723
CCI-12 18x5	90	12	300	18	450	5	125	210724
CCI-12 24x5	90	12	300	24	600	5	125	210725
CCI-12 30x5	90	12	300	30	750	5	125	210726
CCI-12 36x5	90	12	300	36	900	5	125	210727
CCI30-24 6x5	30	24	600	6	150	5	125	214963
CCI30-24 9x5	30	24	600	9	230	5	125	210728
CCI30-24 12x5	30	24	600	12	300	5	125	210729
CCI30-24 18x5	30	24	600	18	450	5	125	210730
CCI30-24 24x5	30	24	600	24	600	5	125	210731
CCI30-24 30x5	30	24	600	30	750	5	125	210732
CCI30-24 36x5	30	24	600	36	900	5	125	210733
CCI45-24 6x5	45	24	600	6	150	5	125	214964
CCI45-24 9x5	45	24	600	9	230	5	125	210734
CCI45-24 12x5	45	24	600	12	300	5	125	210735
CCI45-24 18x5	45	24	600	18	450	5	125	210736
CCI45-24 24x5	45	24	600	24	600	5	125	210737
CCI45-24 30x5	45	24	600	30	750	5	125	210738
CCI45-24 36x5	45	24	600	36	900	5	125	210739
CCI-24 6x5	90	24	600	6	150	5	125	214965
CCI-24 9x5	90	24	600	9	230	5	125	210740
CCI-24 12x5	90	24	600	12	300	5	125	210741
CCI-24 18x5	90	24	600	18	450	5	125	210742
CCI-24 24x5	90	24	600	24	600	5	125	210743
CCI-24 30x5	90	24	600	30	750	5	125	210744
CCI-24 36x5	90	24	600	36	900	5	125	210745
CCI30-36 6x5	30	36	900	6	150	5	125	214966
CCI30-36 9x5	30	36	900	9	230	5	125	210746
CCI30-36 12x5	30	36	900	12	300	5	125	210747
CCI30-36 18x5	30	36	900	18	450	5	125	210748
CCI30-36 24x5	30	36	900	24	600	5	125	210749
CCI30-36 30x5	30	36	900	30	750	5	125	210750
CCI30-36 36x5	30	36	900	36	900	5	125	210751
CCI45-36 6x5	45	36	900	6	150	5	125	214967
CCI45-36 9x5	45	36	900	9	230	5	125	210752
CCI45-36 12x5	45	36	900	12	300	5	125	210753
CCI45-36 18x5	45	36	900	18	450	5	125	210754
CCI45-36 24x5	45	36	900	24	600	5	125	210755
CCI45-36 30x5	45	36	900	30	750	5	125	210756
CCI45-36 36x5	45	36	900	36	900	5	125	210757
CCI-36 6x5	90	36	900	6	150	5	125	214968
CCI-36 9x5	90	36	900	9	230	5	125	210758
CCI-36 12x5	90	36	900	12	300	5	125	210759
CCI-36 18x5	90	36	900	18	450	5	125	210760
CCI-36 24x5	90	36	900	24	600	5	125	210761
CCI-36 30x5	90	36	900	30	750	5	125	210762
CCI-36 36x5	90	36	900	36	900	5	125	210763



 2 x JUI 5 ( 211221)

CXI H5



CXI 'A' - 'R' 'B'x'H'

	A (°)	R		B		H		AL
		inch	mm	inch	mm	inch	mm	REF
CXI30-12 6x5	30	12	300	6	150	5	125	214969
CXI30-12 9x5	30	12	300	9	230	5	125	210881
CXI30-12 12x5	30	12	300	12	300	5	125	210882
CXI30-12 18x5	30	12	300	18	450	5	125	210883
CXI30-12 24x5	30	12	300	24	600	5	125	210884
CXI30-12 30x5	30	12	300	30	750	5	125	210885
CXI30-12 36x5	30	12	300	36	900	5	125	210886
CXI45-12 6x5	45	12	300	6	150	5	125	214970
CXI45-12 9x5	45	12	300	9	230	5	125	210887
CXI45-12 12x5	45	12	300	12	300	5	125	210888
CXI45-12 18x5	45	12	300	18	450	5	125	210889
CXI45-12 24x5	45	12	300	24	600	5	125	210890
CXI45-12 30x5	45	12	300	30	750	5	125	210891
CXI45-12 36x5	45	12	300	36	900	5	125	210892
CXI-12 6x5	90	12	300	6	150	5	125	214971
CXI-12 9x5	90	12	300	9	230	5	125	210893
CXI-12 12x5	90	12	300	12	300	5	125	210894
CXI-12 18x5	90	12	300	18	450	5	125	210895
CXI-12 24x5	90	12	300	24	600	5	125	210896
CXI-12 30x5	90	12	300	30	750	5	125	210897
CXI-12 36x5	90	12	300	36	900	5	125	210898
CXI30-24 6x5	30	24	600	6	150	5	125	214972
CXI30-24 9x5	30	24	600	9	230	5	125	210899
CXI30-24 12x5	30	24	600	12	300	5	125	210900
CXI30-24 18x5	30	24	600	18	450	5	125	210901
CXI30-24 24x5	30	24	600	24	600	5	125	210902
CXI30-24 30x5	30	24	600	30	750	5	125	210903
CXI30-24 36x5	30	24	600	36	900	5	125	210904
CXI45-24 6x5	45	24	600	6	150	5	125	214973
CXI45-24 9x5	45	24	600	9	230	5	125	210905
CXI45-24 12x5	45	24	600	12	300	5	125	210906
CXI45-24 18x5	45	24	600	18	450	5	125	210907
CXI45-24 24x5	45	24	600	24	600	5	125	210908
CXI45-24 30x5	45	24	600	30	750	5	125	210909
CXI45-24 36x5	45	24	600	36	900	5	125	210910
CXI-24 6x5	90	24	600	6	150	5	125	214974
CXI-24 9x5	90	24	600	9	230	5	125	210911
CXI-24 12x5	90	24	600	12	300	5	125	210912
CXI-24 18x5	90	24	600	18	450	5	125	210913
CXI-24 24x5	90	24	600	24	600	5	125	210914
CXI-24 30x5	90	24	600	30	750	5	125	210915
CXI-24 36x5	90	24	600	36	900	5	125	210916
CXI30-36 6x5	30	36	900	6	150	5	125	214975
CXI30-36 9x5	30	36	900	9	230	5	125	210917
CXI30-36 12x5	30	36	900	12	300	5	125	210918
CXI30-36 18x5	30	36	900	18	450	5	125	210919
CXI30-36 24x5	30	36	900	24	600	5	125	210920
CXI30-36 30x5	30	36	900	30	750	5	125	210921
CXI30-36 36x5	30	36	900	36	900	5	125	210922
CXI45-36 6x5	45	36	900	6	150	5	125	214976
CXI45-36 9x5	45	36	900	9	230	5	125	210923
CXI45-36 12x5	45	36	900	12	300	5	125	210924
CXI45-36 18x5	45	36	900	18	450	5	125	210925
CXI45-36 24x5	45	36	900	24	600	5	125	210926
CXI45-36 30x5	45	36	900	30	750	5	125	210927
CXI45-36 36x5	45	36	900	36	900	5	125	210928
CXI-36 6x5	90	36	900	6	150	5	125	214977
CXI-36 9x5	90	36	900	9	230	5	125	210929
CXI-36 12x5	90	36	900	12	300	5	125	210930
CXI-36 18x5	90	36	900	18	450	5	125	210931
CXI-36 24x5	90	36	900	24	600	5	125	210932
CXI-36 30x5	90	36	900	30	750	5	125	210933
CXI-36 36x5	90	36	900	36	900	5	125	210934

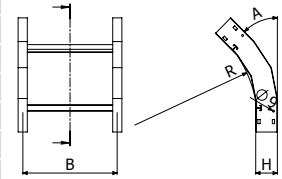

CXI 'A' - 'R' 'B'x'H'

 2 x JUI 5 ( 211221)

## CPI H6



CPI 'A' - 'R' 'B'x'H'

	A (°)	R		B		H		AL
		inch	mm	inch	mm	inch	mm	REF
CPI30-12 9X6	30	12	300	9	230	6	150	210593
CPI30-12 12X6	30	12	300	12	300	6	150	210594
CPI30-12 18X6	30	12	300	18	450	6	150	210595
CPI30-12 24X6	30	12	300	24	600	6	150	210596
CPI30-12 30X6	30	12	300	30	750	6	150	210597
CPI30-12 36X6	30	12	300	36	900	6	150	210598
CPI45-12 9X6	45	12	300	9	230	6	150	210599
CPI45-12 12X6	45	12	300	12	300	6	150	210600
CPI45-12 18X6	45	12	300	18	450	6	150	210601
CPI45-12 24X6	45	12	300	24	600	6	150	210602
CPI45-12 30X6	45	12	300	30	750	6	150	210603
CPI45-12 36X6	45	12	300	36	900	6	150	210604
CPI90-12 9X6	90	12	300	9	230	6	150	210605
CPI90-12 12X6	90	12	300	12	300	6	150	210606
CPI90-12 18X6	90	12	300	18	450	6	150	210607
CPI90-12 24X6	90	12	300	24	600	6	150	210608
CPI90-12 30X6	90	12	300	30	750	6	150	210609
CPI90-12 36X6	90	12	300	36	900	6	150	210610
CPI30-24 9X6	30	24	600	9	230	6	150	210611
CPI30-24 12X6	30	24	600	12	300	6	150	210612
CPI30-24 18X6	30	24	600	18	450	6	150	210613
CPI30-24 24X6	30	24	600	24	600	6	150	210614
CPI30-24 30X6	30	24	600	30	750	6	150	210615
CPI30-24 36X6	30	24	600	36	900	6	150	210616
CPI45-24 9X6	45	24	600	9	230	6	150	210617
CPI45-24 12X6	45	24	600	12	300	6	150	210618
CPI45-24 18X6	45	24	600	18	450	6	150	210619
CPI45-24 24X6	45	24	600	24	600	6	150	210620
CPI45-24 30X6	45	24	600	30	750	6	150	210621
CPI45-24 36X6	45	24	600	36	900	6	150	210622
CPI90-24 9X6	90	24	600	9	230	6	150	210623
CPI90-24 12X6	90	24	600	12	300	6	150	210624
CPI90-24 18X6	90	24	600	18	450	6	150	210625
CPI90-24 24X6	90	24	600	24	600	6	150	210626
CPI90-24 30X6	90	24	600	30	750	6	150	210627
CPI90-24 36X6	90	24	600	36	900	6	150	210628
CPI30-36 9X6	30	36	900	9	230	6	150	210629
CPI30-36 12X6	30	36	900	12	300	6	150	210630
CPI30-36 18X6	30	36	900	18	450	6	150	210631
CPI30-36 24X6	30	36	900	24	600	6	150	210632
CPI30-36 30X6	30	36	900	30	750	6	150	210633
CPI30-36 36X6	30	36	900	36	900	6	150	210634
CPI45-36 9X6	45	36	900	9	230	6	150	210635
CPI45-36 12X6	45	36	900	12	300	6	150	210636
CPI45-36 18X6	45	36	900	18	450	6	150	210637
CPI45-36 24X6	45	36	900	24	600	6	150	210638
CPI45-36 30X6	45	36	900	30	750	6	150	210639
CPI45-36 36X6	45	36	900	36	900	6	150	210640
CPI90-36 9X6	90	36	900	9	230	6	150	210641
CPI90-36 12X6	90	36	900	12	300	6	150	210642
CPI90-36 18X6	90	36	900	18	450	6	150	210643
CPI90-36 24X6	90	36	900	24	600	6	150	210644
CPI90-36 30X6	90	36	900	30	750	6	150	210645
CPI90-36 36X6	90	36	900	36	900	6	150	210646

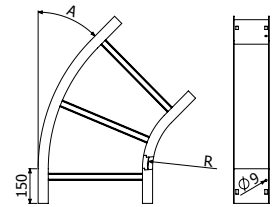
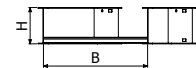

CPI 'A' - 'R' 'B'x'H'



 2 x JUI 6 ( 211222)

## CCI H6



CCI 'A' - 'R' 'B'x'H'

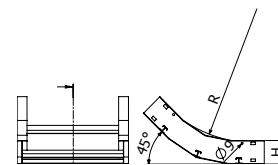

CCI 'A' - 'R' 'B'x'H'

	A (°)	R		B		H		AL
		inch	mm	inch	mm	inch	mm	REF
CCI30-12 9X6	30	12	300	9	230	6	150	210764
CCI30-12 12X6	30	12	300	12	300	6	150	210765
CCI30-12 18X6	30	12	300	18	450	6	150	210766
CCI30-12 24X6	30	12	300	24	600	6	150	210767
CCI30-12 30X6	30	12	300	30	750	6	150	210768
CCI30-12 36X6	30	12	300	36	900	6	150	210769
CCI45-12 9X6	45	12	300	9	230	6	150	210770
CCI45-12 12X6	45	12	300	12	300	6	150	210771
CCI45-12 18X6	45	12	300	18	450	6	150	210772
CCI45-12 24X6	45	12	300	24	600	6	150	210773
CCI45-12 30X6	45	12	300	30	750	6	150	210774
CCI45-12 36X6	45	12	300	36	900	6	150	210775
CCI90-12 9X6	90	12	300	9	230	6	150	210776
CCI90-12 12X6	90	12	300	12	300	6	150	210777
CCI90-12 18X6	90	12	300	18	450	6	150	210778
CCI90-12 24X6	90	12	300	24	600	6	150	210779
CCI90-12 30X6	90	12	300	30	750	6	150	210780
CCI90-12 36X6	90	12	300	36	900	6	150	210781
CCI30-24 9X6	30	24	600	9	230	6	150	210782
CCI30-24 12X6	30	24	600	12	300	6	150	210783
CCI30-24 18X6	30	24	600	18	450	6	150	210784
CCI30-24 24X6	30	24	600	24	600	6	150	210785
CCI30-24 30X6	30	24	600	30	750	6	150	210786
CCI30-24 36X6	30	24	600	36	900	6	150	210787
CCI45-24 9X6	45	24	600	9	230	6	150	210788
CCI45-24 12X6	45	24	600	12	300	6	150	210789
CCI45-24 18X6	45	24	600	18	450	6	150	210790
CCI45-24 24X6	45	24	600	24	600	6	150	210791
CCI45-24 30X6	45	24	600	30	750	6	150	210792
CCI45-24 36X6	45	24	600	36	900	6	150	210793
CCI90-24 9X6	90	24	600	9	230	6	150	210794
CCI90-24 12X6	90	24	600	12	300	6	150	210795
CCI90-24 18X6	90	24	600	18	450	6	150	210796
CCI90-24 24X6	90	24	600	24	600	6	150	210797
CCI90-24 30X6	90	24	600	30	750	6	150	210798
CCI90-24 36X6	90	24	600	36	900	6	150	210799
CCI30-36 9X6	30	36	900	9	230	6	150	210800
CCI30-36 12X6	30	36	900	12	300	6	150	210801
CCI30-36 18X6	30	36	900	18	450	6	150	210802
CCI30-36 24X6	30	36	900	24	600	6	150	210803
CCI30-36 30X6	30	36	900	30	750	6	150	210804
CCI30-36 36X6	30	36	900	36	900	6	150	210805
CCI45-36 9X6	45	36	900	9	230	6	150	210806
CCI45-36 12X6	45	36	900	12	300	6	150	210807
CCI45-36 18X6	45	36	900	18	450	6	150	210808
CCI45-36 24X6	45	36	900	24	600	6	150	210809
CCI45-36 30X6	45	36	900	30	750	6	150	210810
CCI45-36 36X6	45	36	900	36	900	6	150	210811
CCI90-36 9X6	90	36	900	9	230	6	150	210812
CCI90-36 12X6	90	36	900	12	300	6	150	210813
CCI90-36 18X6	90	36	900	18	450	6	150	210814
CCI90-36 24X6	90	36	900	24	600	6	150	210815
CCI90-36 30X6	90	36	900	30	750	6	150	210816
CCI90-36 36X6	90	36	900	36	900	6	150	210817

 2 x JUI 6 ( 211222)

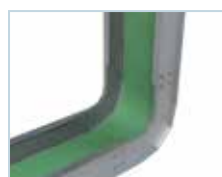

## CXI H6



CXI 'A' - 'R' 'B'x'H'

	A (°)	R		B		H		AL
		inch	mm	inch	mm	inch	mm	REF
CXI30-12 9X6	30	12	300	9	230	6	150	210935
CXI30-12 12X6	30	12	300	12	300	6	150	210936
CXI30-12 18X6	30	12	300	18	450	6	150	210937
CXI30-12 24X6	30	12	300	24	600	6	150	210938
CXI30-12 30X6	30	12	300	30	750	6	150	210939
CXI30-12 36X6	30	12	300	36	900	6	150	210940
CXI45-12 9X6	45	12	300	9	230	6	150	210941
CXI45-12 12X6	45	12	300	12	300	6	150	210942
CXI45-12 18X6	45	12	300	18	450	6	150	210943
CXI45-12 24X6	45	12	300	24	600	6	150	210944
CXI45-12 30X6	45	12	300	30	750	6	150	210945
CXI45-12 36X6	45	12	300	36	900	6	150	210946
CXI90-12 9X6	90	12	300	9	230	6	150	210947
CXI90-12 12X6	90	12	300	12	300	6	150	210948
CXI90-12 18X6	90	12	300	18	450	6	150	210949
CXI90-12 24X6	90	12	300	24	600	6	150	210950
CXI90-12 30X6	90	12	300	30	750	6	150	210951
CXI90-12 36X6	90	12	300	36	900	6	150	210952
CXI30-24 9X6	30	24	600	9	230	6	150	210953
CXI30-24 12X6	30	24	600	12	300	6	150	210954
CXI30-24 18X6	30	24	600	18	450	6	150	210955
CXI30-24 24X6	30	24	600	24	600	6	150	210956
CXI30-24 30X6	30	24	600	30	750	6	150	210957
CXI30-24 36X6	30	24	600	36	900	6	150	210958
CXI45-24 9X6	45	24	600	9	230	6	150	210959
CXI45-24 12X6	45	24	600	12	300	6	150	210960
CXI45-24 18X6	45	24	600	18	450	6	150	210961
CXI45-24 24X6	45	24	600	24	600	6	150	210962
CXI45-24 30X6	45	24	600	30	750	6	150	210963
CXI45-24 36X6	45	24	600	36	900	6	150	210964
CXI90-24 9X6	90	24	600	9	230	6	150	210965
CXI90-24 12X6	90	24	600	12	300	6	150	210966
CXI90-24 18X6	90	24	600	18	450	6	150	210967
CXI90-24 24X6	90	24	600	24	600	6	150	210968
CXI90-24 30X6	90	24	600	30	750	6	150	210969
CXI90-24 36X6	90	24	600	36	900	6	150	210970
CXI30-36 9X6	30	36	900	9	230	6	150	210971
CXI30-36 12X6	30	36	900	12	300	6	150	210972
CXI30-36 18X6	30	36	900	18	450	6	150	210973
CXI30-36 24X6	30	36	900	24	600	6	150	210974
CXI30-36 30X6	30	36	900	30	750	6	150	210975
CXI30-36 36X6	30	36	900	36	900	6	150	210976
CXI45-36 9X6	45	36	900	9	230	6	150	210977
CXI45-36 12X6	45	36	900	12	300	6	150	210978
CXI45-36 18X6	45	36	900	18	450	6	150	210979
CXI45-36 24X6	45	36	900	24	600	6	150	210980
CXI45-36 30X6	45	36	900	30	750	6	150	210981
CXI45-36 36X6	45	36	900	36	900	6	150	210982
CXI90-36 9X6	90	36	900	9	230	6	150	210983
CXI90-36 12X6	90	36	900	12	300	6	150	210984
CXI90-36 18X6	90	36	900	18	450	6	150	210985
CXI90-36 24X6	90	36	900	24	600	6	150	210986
CXI90-36 30X6	90	36	900	30	750	6	150	210987
CXI90-36 36X6	90	36	900	36	900	6	150	210988

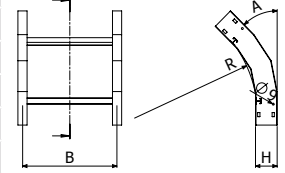

CXI 'A' - 'R' 'B'x'H'

 2 x JUI 6 ( 211222)

TEI H4, H5, H6



TEI-'R' 'B'x'H'

	R		B		H		AL
	inch	mm	inch	mm	inch	mm	REF
TEI-12 6x4	12	300	6	150	4	100	210989
TEI-12 9x4	12	300	9	230	4	100	210990
TEI-12 12x4	12	300	12	300	4	100	210991
TEI-12 18x4	12	300	18	450	4	100	210992
TEI-12 24x4	12	300	24	600	4	100	210993
TEI-12 30x4	12	300	30	750	4	100	210994
TEI-12 36x4	12	300	36	900	4	100	210995
TEI-24 6x4	24	600	6	150	4	100	210996
TEI-24 9x4	24	600	9	230	4	100	210997
TEI-24 12x4	24	600	12	300	4	100	210998
TEI-24 18x4	24	600	18	450	4	100	210999
TEI-24 24x4	24	600	24	600	4	100	211000
TEI-24 30x4	24	600	30	750	4	100	211001
TEI-24 36x4	24	600	36	900	4	100	211002
TEI-36 6x4	36	900	6	150	4	100	211003
TEI-36 9x4	36	900	9	230	4	100	211004
TEI-36 12x4	36	900	12	300	4	100	211005
TEI-36 18x4	36	900	18	450	4	100	211006
TEI-36 24x4	36	900	24	600	4	100	211007
TEI-36 30x4	36	900	30	750	4	100	211008
TEI-36 36x4	36	900	36	900	4	100	211009
TEI-12 6x5	12	300	6	150	5	125	214978
TEI-12 9x5	12	300	9	230	5	125	211010
TEI-12 12x5	12	300	12	300	5	125	211011
TEI-12 18x5	12	300	18	450	5	125	211012
TEI-12 24x5	12	300	24	600	5	125	211013
TEI-12 30x5	12	300	30	750	5	125	211014
TEI-12 36x5	12	300	36	900	5	125	211015
TEI-24 6x5	24	600	6	150	5	125	214979
TEI-24 9x5	24	600	9	230	5	125	211016
TEI-24 12x5	24	600	12	300	5	125	211017
TEI-24 18x5	24	600	18	450	5	125	211018
TEI-24 24x5	24	600	24	600	5	125	211019
TEI-24 30x5	24	600	30	750	5	125	211020
TEI-24 36x5	24	600	36	900	5	125	211021
TEI-36 6x5	36	900	6	150	5	125	214980
TEI-36 9x5	36	900	9	230	5	125	211022
TEI-36 12x5	36	900	12	300	5	125	211023
TEI-36 18x5	36	900	18	450	5	125	211024
TEI-36 24x5	36	900	24	600	5	125	211025
TEI-36 30x5	36	900	30	750	5	125	211026
TEI-36 36x5	36	900	36	900	5	125	211027
TEI-12 9x6	12	300	9	230	6	150	211028
TEI-12 12x6	12	300	12	300	6	150	211029
TEI-12 18x6	12	300	18	450	6	150	211030
TEI-12 24x6	12	300	24	600	6	150	211031
TEI-12 30x6	12	300	30	750	6	150	211032
TEI-12 36x6	12	300	36	900	6	150	211033
TEI-24 9x6	24	600	9	230	6	150	211034
TEI-24 12x6	24	600	12	300	6	150	211035
TEI-24 18x6	24	600	18	450	6	150	211036
TEI-24 24x6	24	600	24	600	6	150	211037
TEI-24 30x6	24	600	30	750	6	150	211038
TEI-24 36x6	24	600	36	900	6	150	211039
TEI-36 9x6	36	900	9	230	6	150	211040
TEI-36 12x6	36	900	12	300	6	150	211041
TEI-36 18x6	36	900	18	450	6	150	211042
TEI-36 24x6	36	900	24	600	6	150	211043
TEI-36 30x6	36	900	30	750	6	150	211044
TEI-36 36x6	36	900	36	900	6	150	211045

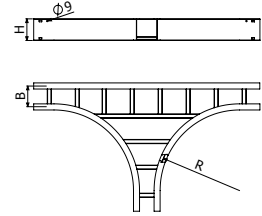

TEI-'R' 'B'x'H'

- 2 x JUI 4 ( 211220)
- 2 x JUI 5 ( 211221)
- 2 x JUI 6 ( 211222)

CRI H4, H5, H6



CRI-'R' 'B'x'H'

	R		B		H		AL
	inch	mm	inch	mm	inch	mm	REF
CRI-12 6x4	12	300	6	150	4	100	211046
CRI-12 9x4	12	300	9	230	4	100	211047
CRI-12 12x4	12	300	12	300	4	100	211048
CRI-12 18x4	12	300	18	450	4	100	211049
CRI-12 24x4	12	300	24	600	4	100	211050
CRI-12 30x4	12	300	30	750	4	100	211051
CRI-12 36x4	12	300	36	900	4	100	211052
CRI-24 6x4	24	600	6	150	4	100	211053
CRI-24 9x4	24	600	9	230	4	100	211054
CRI-24 12x4	24	600	12	300	4	100	211055
CRI-24 18x4	24	600	18	450	4	100	211056
CRI-24 24x4	24	600	24	600	4	100	211057
CRI-24 30x4	24	600	30	750	4	100	211058
CRI-24 36x4	24	600	36	900	4	100	211059
CRI-36 6x4	36	900	6	150	4	100	211060
CRI-36 9x4	36	900	9	230	4	100	211061
CRI-36 12x4	36	900	12	300	4	100	211062
CRI-36 18x4	36	900	18	450	4	100	211063
CRI-36 24x4	36	900	24	600	4	100	211064
CRI-36 30x4	36	900	30	750	4	100	211065
CRI-36 36x4	36	900	36	900	4	100	211066
CRI-12 6x5	12	300	6	150	5	125	214981
CRI-12 9x5	12	300	9	230	5	125	211067
CRI-12 12x5	12	300	12	300	5	125	211068
CRI-12 18x5	12	300	18	450	5	125	211069
CRI-12 24x5	12	300	24	600	5	125	211070
CRI-12 30x5	12	300	30	750	5	125	211071
CRI-12 36x5	12	300	36	900	5	125	211072
CRI-24 6x5	24	600	6	150	5	125	214982
CRI-24 9x5	24	600	9	230	5	125	211073
CRI-24 12x5	24	600	12	300	5	125	211074
CRI-24 18x5	24	600	18	450	5	125	211075
CRI-24 24x5	24	600	24	600	5	125	211076
CRI-24 30x5	24	600	30	750	5	125	211077
CRI-24 36x5	24	600	36	900	5	125	211078
CRI-36 6x5	36	900	6	150	5	125	214983
CRI-36 9x5	36	900	9	230	5	125	211079
CRI-36 12x5	36	900	12	300	5	125	211080
CRI-36 18x5	36	900	18	450	5	125	211081
CRI-36 24x5	36	900	24	600	5	125	211082
CRI-36 30x5	36	900	30	750	5	125	211083
CRI-36 36x5	36	900	36	900	5	125	211084
CRI-12 9x6	12	300	9	230	6	150	211085
CRI-12 12x6	12	300	12	300	6	150	211086
CRI-12 18x6	12	300	18	450	6	150	211087
CRI-12 24x6	12	300	24	600	6	150	211088
CRI-12 30x6	12	300	30	750	6	150	211089
CRI-12 36x6	12	300	36	900	6	150	211090
CRI-24 9x6	24	600	9	230	6	150	211091
CRI-24 12x6	24	600	12	300	6	150	211092
CRI-24 18x6	24	600	18	450	6	150	211093
CRI-24 24x6	24	600	24	600	6	150	211094
CRI-24 30x6	24	600	30	750	6	150	211095
CRI-24 36x6	24	600	36	900	6	150	211096
CRI-36 9x6	36	900	9	230	6	150	211097
CRI-36 12x6	36	900	12	300	6	150	211098
CRI-36 18x6	36	900	18	450	6	150	211099
CRI-36 24x6	36	900	24	600	6	150	211100
CRI-36 30x6	36	900	30	750	6	150	211101
CRI-36 36x6	36	900	36	900	6	150	211102

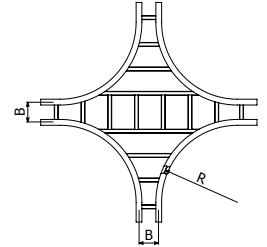
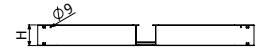

CRI-'R' 'B'x'H'

 2 x JUL 4 ( 211220)  
 2 x JUL 5 ( 211221)  
 2 x JUL 6 ( 211222)



## RII H4, H5, H6



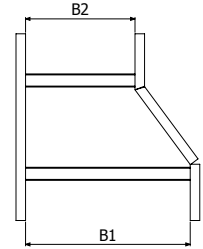

RII-'B1'/B2'x'H'

	B1		B2		H		AL
	inch	mm	inch	mm	inch	mm	REF
RII 9/6x4	9	230	6	150	4	100	211103
RII 12/9x4	12	300	9	230	4	100	211104
RII 12/6x4	12	300	6	150	4	100	211105
RII 18/12x4	18	450	12	300	4	100	211106
RII 18/9x4	18	450	9	230	4	100	211107
RII 18/6x4	18	450	6	150	4	100	211108
RII 24/18x4	24	600	18	450	4	100	211109
RII 24/12x4	24	600	12	300	4	100	211110
RII 24/9x4	24	600	9	230	4	100	211111
RII 30/24x4	30	750	24	600	4	100	211112
RII 30/18x4	30	750	18	450	4	100	211113
RII 30/12x4	30	750	12	300	4	100	211114
RII 36/30x4	36	900	30	750	4	100	211115
RII 36/24x4	36	900	24	600	4	100	211116
RII 36/18x4	36	900	18	450	4	100	211117
RII 9/6x5	9	230	6	150	5	125	214984
RII 12/6x5	12	300	6	230	5	125	214985
RII 12/9x5	12	300	9	230	5	125	211118
RII 18/6x5	18	450	6	150	5	125	214986
RII 18/12x5	18	450	12	300	5	125	211119
RII 18/9x5	18	450	9	230	5	125	211120
RII 24/18x5	24	600	18	450	5	125	211121
RII 24/12x5	24	600	12	300	5	125	211122
RII 24/9x5	24	600	9	230	5	125	211123
RII 30/24x5	30	750	24	600	5	125	211124
RII 30/18x5	30	750	18	450	5	125	211125
RII 30/12x5	30	750	12	300	5	125	211126
RII 36/30x5	36	900	30	750	5	125	211127
RII 36/24x5	36	900	24	600	5	125	211128
RII 36/18x5	36	900	18	450	5	125	211129
RII 12/9x6	12	300	9	230	6	150	211130
RII 18/12x6	18	450	12	300	6	150	211131
RII 18/9x6	18	450	9	230	6	150	211132
RII 24/18x6	24	600	18	450	6	150	211133
RII 24/12x6	24	600	12	300	6	150	211134
RII 24/9x6	24	600	9	230	6	150	211135
RII 30/24x6	30	750	24	600	6	150	211136
RII 30/18x6	30	750	18	450	6	150	211137
RII 30/12x6	30	750	12	300	6	150	211138
RII 36/30x6	36	900	30	750	6	150	211139
RII 36/24x6	36	900	24	600	6	150	211140
RII 36/18x6	36	900	18	450	6	150	211141

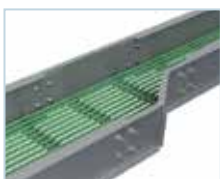

RII-'B1'/B2'x'H'



  $B2 \leq B1$   
 2 x JUI 4 ( 211220)  
 2 x JUI 5 ( 211221)  
 2 x JUI 6 ( 211222)

## RCI H4, H5, H6



RCI-'B1'/B2'x'H'

	B1		B2		H		AL
	inch	mm	inch	mm	inch	mm	REF
RCI 9/6x4	9	230	6	150	4	100	211142
RCI 12/9x4	12	300	9	230	4	100	211143
RCI 12/6x4	12	300	6	150	4	100	211144
RCI 18/12x4	18	450	12	300	4	100	211145
RCI 18/9x4	18	450	9	230	4	100	211146
RCI 18/6x4	18	450	6	150	4	100	211147
RCI 24/18x4	24	600	18	450	4	100	211148
RCI 24/12x4	24	600	12	300	4	100	211149
RCI 24/9x4	24	600	9	230	4	100	211150
RCI 30/24x4	30	750	24	600	4	100	211151
RCI 30/18x4	30	750	18	450	4	100	211152
RCI 30/12x4	30	750	12	300	4	100	211153
RCI 36/30x4	36	900	30	750	4	100	211154
RCI 36/24x4	36	900	24	600	4	100	211155
RCI 36/18x4	36	900	18	450	4	100	211156
RCI 9/6x5	9	230	6	150	5	125	214987
RCI 12/9x5	12	300	9	230	5	125	211157
RCI 12/6x5	12	300	6	230	5	125	214988
RCI 18/12x5	18	450	12	300	5	125	211158
RCI 18/9x5	18	450	9	230	5	125	211159
RCI 18/6x5	18	450	6	150	5	125	214989
RCI 24/18x5	24	600	18	450	5	125	211160
RCI 24/12x5	24	600	12	300	5	125	211161
RCI 24/9x5	24	600	9	230	5	125	211162
RCI 30/24x5	30	750	24	600	5	125	211163
RCI 30/18x5	30	750	18	450	5	125	211164
RCI 30/12x5	30	750	12	300	5	125	211165
RCI 36/30x5	36	900	30	750	5	125	211166
RCI 36/24x5	36	900	24	600	5	125	211167
RCI 36/18x5	36	900	18	450	5	125	211168
RCI 12/9x6	12	300	9	230	6	150	211169
RCI 18/12x6	18	450	12	300	6	150	211170
RCI 18/9x6	18	450	9	230	6	150	211171
RCI 24/18x6	24	600	18	450	6	150	211172
RCI 24/12x6	24	600	12	300	6	150	211173
RCI 24/9x6	24	600	9	230	6	150	211174
RCI 30/24x6	30	750	24	600	6	150	211175
RCI 30/18x6	30	750	18	450	6	150	211176
RCI 30/12x6	30	750	12	300	6	150	211177
RCI 36/30x6	36	900	30	750	6	150	211178
RCI 36/24x6	36	900	24	600	6	150	211179
RCI 36/18x6	36	900	18	450	6	150	211180

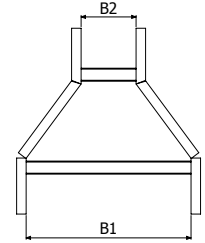
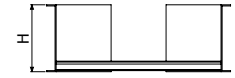

RCI-'B1'/B2'x'H'



B2 ≤ B1  
2 x JUI 4 ( 211220)  
2 x JUI 5 ( 211221)  
2 x JUI 6 ( 211222)

RDI H4, H5, H6



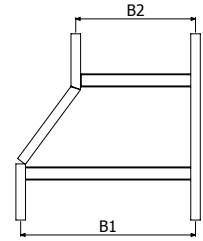
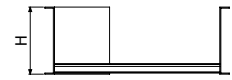

RDI-'B1'/B2'x'H'

	B1		B2		H		AL
	inch	mm	inch	mm	inch	mm	REF
RDI 9/6x4	9	230	6	150	4	100	211181
RDI 12/9x4	12	300	9	230	4	100	211182
RDI 12/6x4	12	300	6	150	4	100	211183
RDI 18/12x4	18	450	12	300	4	100	211184
RDI 18/9x4	18	450	9	230	4	100	211185
RDI 18/6x4	18	450	6	150	4	100	211186
RDI 24/18x4	24	600	18	450	4	100	211187
RDI 24/12x4	24	600	12	300	4	100	211188
RDI 24/9x4	24	600	9	230	4	100	211189
RDI 30/24x4	30	750	24	600	4	100	211190
RDI 30/18x4	30	750	18	450	4	100	211191
RDI 30/12x4	30	750	12	300	4	100	211192
RDI 36/30x4	36	900	30	750	4	100	211193
RDI 36/24x4	36	900	24	600	4	100	211194
RDI 36/18x4	36	900	18	450	4	100	211195
RDI 9/6x5	9	230	6	150	5	125	214990
RDI 12/9x5	12	300	9	230	5	125	211196
RDI 12/6x5	12	300	6	230	5	125	214991
RDI 18/12x5	18	450	12	300	5	125	211197
RDI 18/9x5	18	450	9	230	5	125	211198
RDI 18/6x5	18	450	6	150	5	125	214992
RDI 24/18x5	24	600	18	450	5	125	211199
RDI 24/12x5	24	600	12	300	5	125	211200
RDI 24/9x5	24	600	9	230	5	125	211201
RDI 30/24x5	30	750	24	600	5	125	211202
RDI 30/18x5	30	750	18	450	5	125	211203
RDI 30/12x5	30	750	12	300	5	125	211204
RDI 36/30x5	36	900	30	750	5	125	211205
RDI 36/24x5	36	900	24	600	5	125	211206
RDI 36/18x5	36	900	18	450	5	125	211207
RDI 12/9x6	12	300	9	230	6	150	211208
RDI 18/12x6	18	450	12	300	6	150	211209
RDI 18/9x6	18	450	9	230	6	150	211210
RDI 24/18x6	24	600	18	450	6	150	211211
RDI 24/12x6	24	600	12	300	6	150	211212
RDI 24/9x6	24	600	9	230	6	150	211213
RDI 30/24x6	30	750	24	600	6	150	211214
RDI 30/18x6	30	750	18	450	6	150	211215
RDI 30/12x6	30	750	12	300	6	150	211216
RDI 36/30x6	36	900	30	750	6	150	211217
RDI 36/24x6	36	900	24	600	6	150	211218
RDI 36/18x6	36	900	18	450	6	150	211219

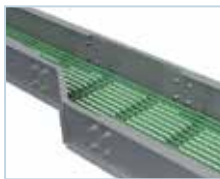

RDI-'B1'/B2'x'H'



 B2 ≤ B1  
 2 x JU1 4 ( 211220)  
 2 x JU1 5 ( 211221)  
 2 x JU1 6 ( 211222)

## TI



L = 3 m (10 ft)

	B		e	AL
	inch	mm	mm	REF
TI 6 3M	6	150	1,5	212080
TI 9 3M	9	230	1,5	212081
TI 12 3M	12	300	1,5	212082
TI 18 3M	18	450	1,5	212083
TI 24 3M	24	600	1,5	212084
TI 30 3M	30	750	1,5	212085
TI 36 3M	36	900	1,5	212086

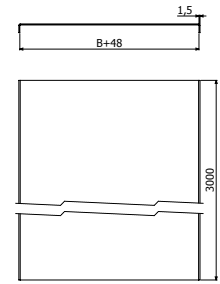

4 x PTI ( 212095 ) → 1 x TI

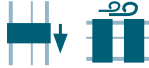

## T2AI



L = 3 m (10 ft)

	B		e	AL
	inch	mm	mm	REF
T2AI 6 3M	6	150	1,5	212087
T2AI 9 3M	9	230	1,5	212088
T2AI 12 3M	12	300	1,5	212089
T2AI 18 3M	18	450	1,5	212090
T2AI 24 3M	24	600	1,5	212091
T2AI 30 3M	30	750	1,5	212092
T2AI 36 3M	36	900	1,5	212093

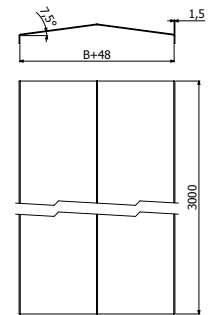

4 x PT2AI ( 212094 ) → 1 x T2AI

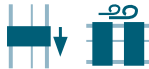

## PTI



	Pap	e	AL
	N-m	mm	REF
PTI	6	3	212095

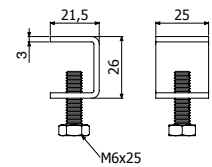

## PT2AI



	Pap	e	AL
	N-m	mm	REF
PT2AI	6	3	212094

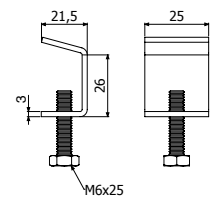

## PSI

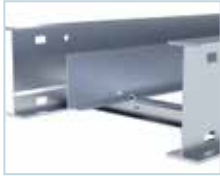

	H		AL
	inch	mm	REF
PSI 4	4	100	218701
PSI 5	5	125	218702
PSI 6	6	150	218703
DIN7504 4,8X19 (i316)	-	-	217610

4 x DIN7504 (1000 <-> 1000 mm)

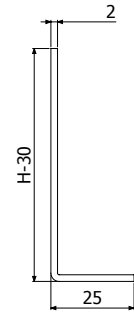

## JUI



	H		X	AL
	inch	mm	mm	REF
JUI 4	4	100	94	211220
JUI 5	5	125	114	211221
JUI 6	6	150	144	211222

4/50 x B3 i304 ( 212096)

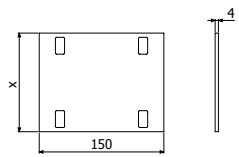

## JUI-A



	H		X	AL
	inch	mm	mm	REF
JUI-A 4	4	100	94	211223
JUI-A 5	5	125	114	211224
JUI-A 6	6	150	144	211225

4/50 x B3 i304 ( 212096)

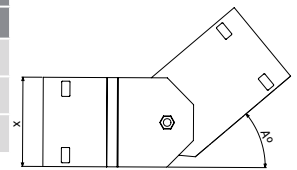

Amáx=75°

## JUI-L



	H		X	AL
	inch	mm	mm	REF
JUI-L 4	4	100	94	215062
JUI-L 5	5	125	114	215063
JUI-L 6	6	150	144	215064

4/50 x B3 i304 ( 212096)

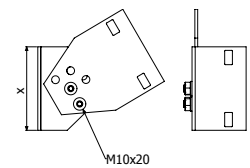

## JUI-B



	H		X	AL
	inch	mm	mm	REF
JUI-B 4	4	100	94	211236
JUI-B 5	5	125	114	211237
JUI-B 6	6	150	144	211238

4/50 x B3 i304 ( 212096)

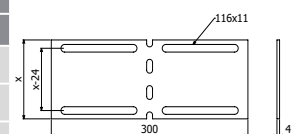

**BI**



	e	AL
	mm	REF
BIS	4	214472
BIR	4	215445

 SP4/SP4D --> BIS/BIR + DIN933 M10X30 ( 217547 - i304 ) + TM41 M10 ( 218525 - i304 )  
 BIS -> IL / IS  
 BIR -> IR

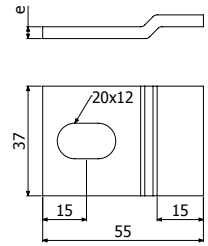

**BEV**

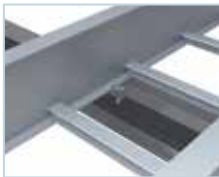

	H		GC	i304
	inch	mm	REF	REF
BEV	6	150	211805	214473

 10

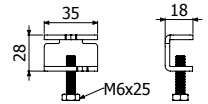

**B3**



	Pap	i304	i316
	N-m	REF	REF
B3-50	35	212096	215575

 15

