

CAD-Bibliothek  
CAD Library

---

**Aluminium-Systeme**  
Fenstersysteme

## **Schüco Fenster AWS 75 BS.SI<sup>+</sup>**

---

**Aluminium Systems**  
Window Systems

## **Schüco Window AWS 75 BS.SI<sup>+</sup>**

---

Einflügeliges Fenster  
Single-vent window

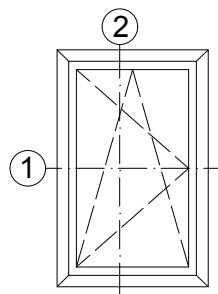

Stulpfenster  
Double-vent window

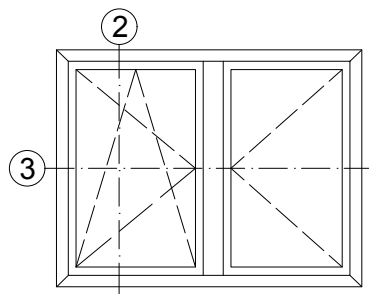

Zweiflügeliges Fenster  
Vent + vent

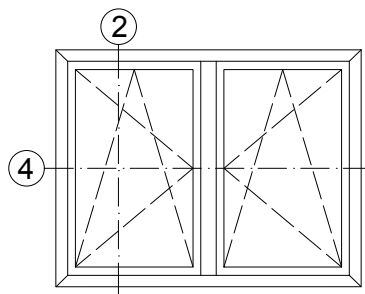

Einflügeliges Fenster mit Festfeld  
Single-vent window with fixed light

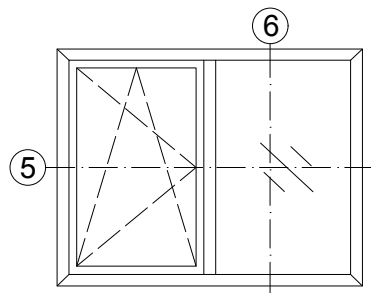

Zweiflügeliges Fenster mit Oberlicht  
Vent + vent with toplight

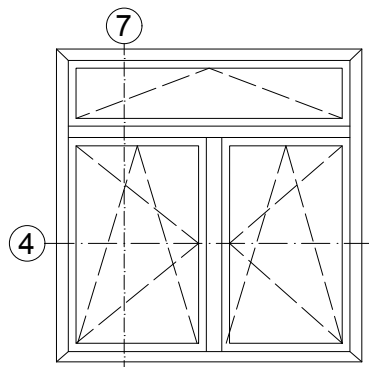

Stulpfenster mit Oberlicht  
Double-vent window with toplight

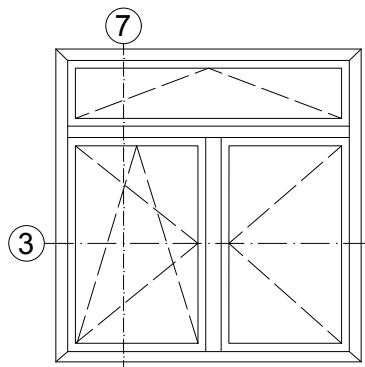

Zweiflügeliges Fenster mit Unterlicht  
Vent + vent with bottom light

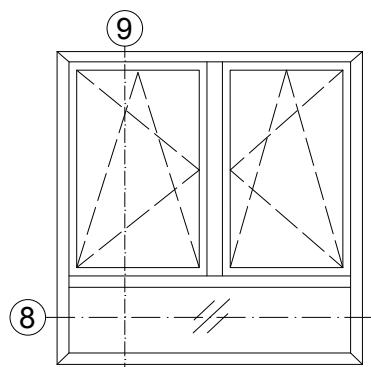

Fenstertür  
Window door

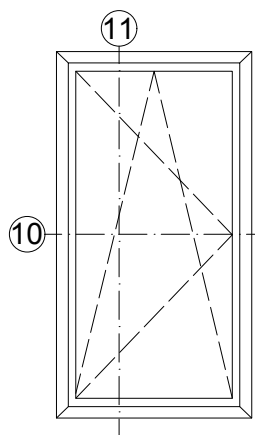

Einsatzelemente sind in Fassadensysteme zu finden  
Insert units can be found in façade systems

Technische Informationen

Technical information

Prüfungen und Normen ** Tests and standards	
Wärmedämmung nach DIN EN ISO 1077-2 Thermal insulation in accordance with DIN EN ISO 1077-2	Uf = 1,3 - 1,6 W/(m²K)
Schalldämmung nach DIN EN ISO 140-3 Sound reduction in accordance with DIN EN ISO 140-3	bis Rw 45 dB Up to Rw 45 dB
Einbruchhemmung nach DIN V ENV 1627 Burglar resistance in accordance with DIN V ENV 1627	Klasse WK2 (RC 2) Class WK2 (RC 2)
Luftdurchlässigkeit nach DIN EN 12207 Air permeability in accordance with DIN EN 12207	Klasse 4 Class 4
Schlagregendichtheit nach DIN EN 12208 Watertightness in accordance with DIN EN 12208	Klasse 9a Class 9a
Windlastwiderstand nach DIN EN 12210 * Wind load resistance in accordance with DIN EN 12210	Klasse C5/B5 Class C5 / B5
Mechanische Beanspruchung nach DIN EN 13115 Mechanical loading in accordance with DIN EN 13115	Klasse 4 Class 4
Dauerfunktion nach DIN EN 12400 Durability in accordance with DIN EN 12400	Klasse 3 Class 3

\* Durchbiegungsverhalten profilabhängig  
The amount of deflection will depend on the profile

\*\* Die Angaben beschreiben die Bestwerte des Gesamtsystems.  
Die Eigenschaften einer jeweils gewählten Ausführungsvariante oder  
Elementkombination sind im Einzelfall anhand der ausführlichen  
Prüfdokumentation zu bestimmen.  
The information describes the optimum values of the entire system.  
The properties of a selected design option or unit combination have to be determined  
individually based on the comprehensive test documentation.

Elementbeispiele - Innen öffnend  
Unit examples - Inward-opening

AB0000040

0403

Schüco AWS 75 BS.SI+

Einflügeliges Fenster  
Single-vent window

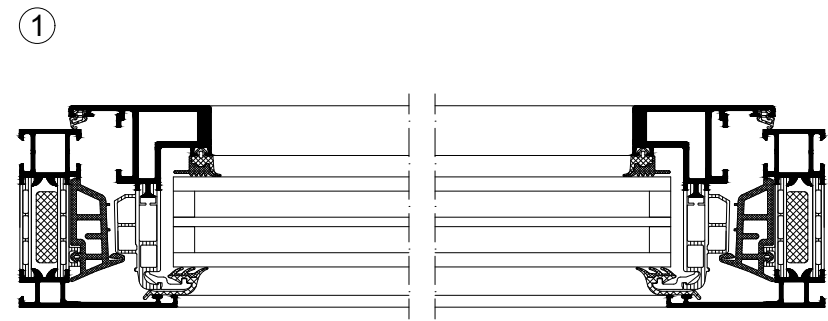
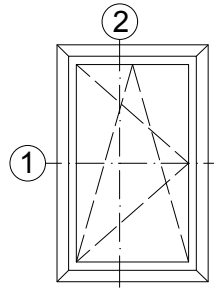

Stulpfenster  
Double-vent window

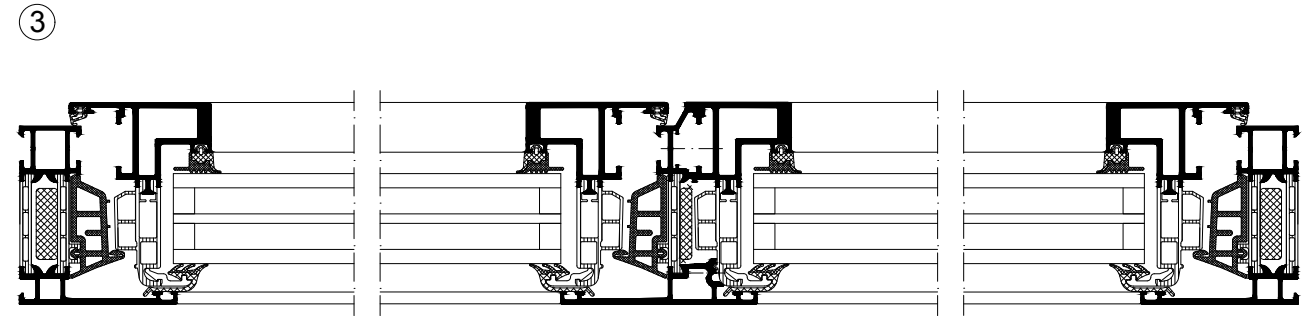
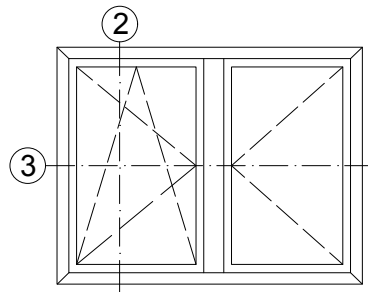

Zweiflügeliges Fenster  
Vent + vent

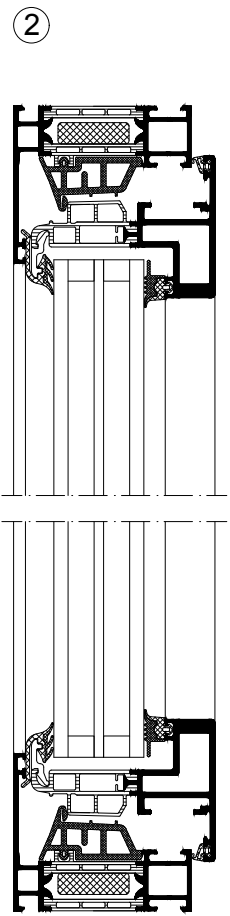
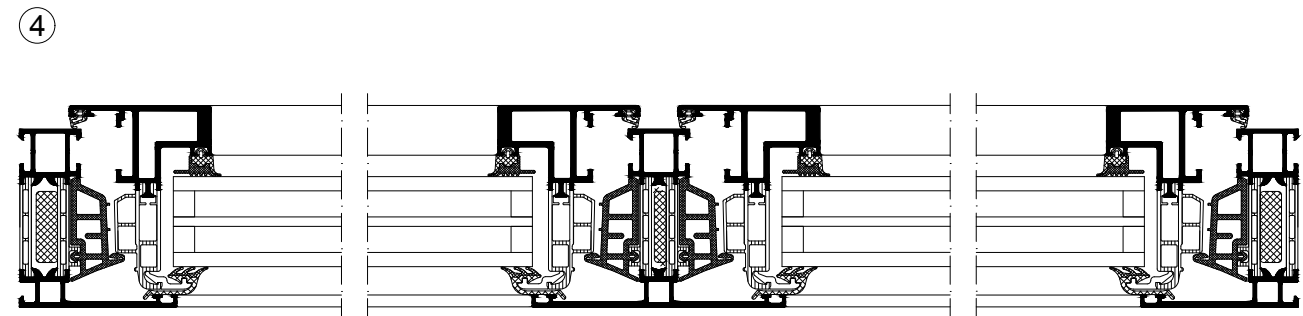
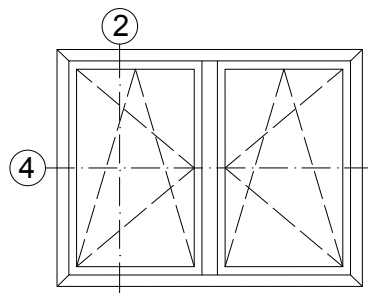

Elementschnitte - Innen öffnend  
Unit section details - Inward-opening

AB0000041

0403

Schüco AWS 75 BS.SI<sup>+</sup>

Einflügliges Fenster mit Festfeld  
Single-vent window with fixed light

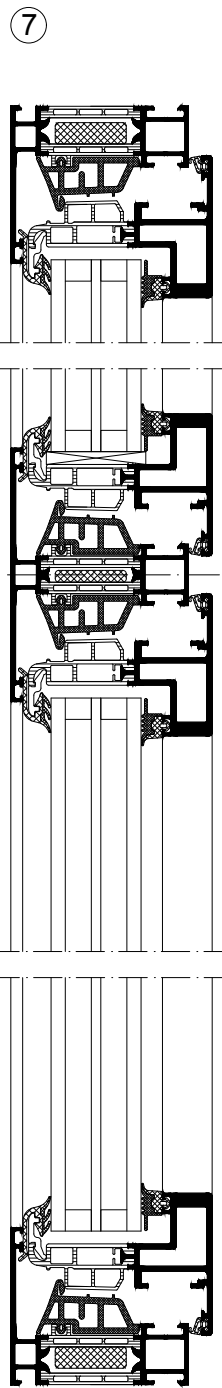
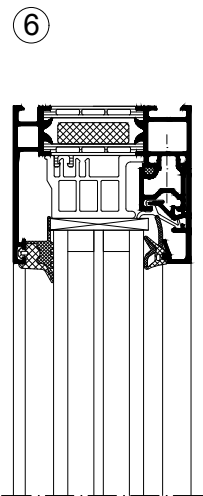
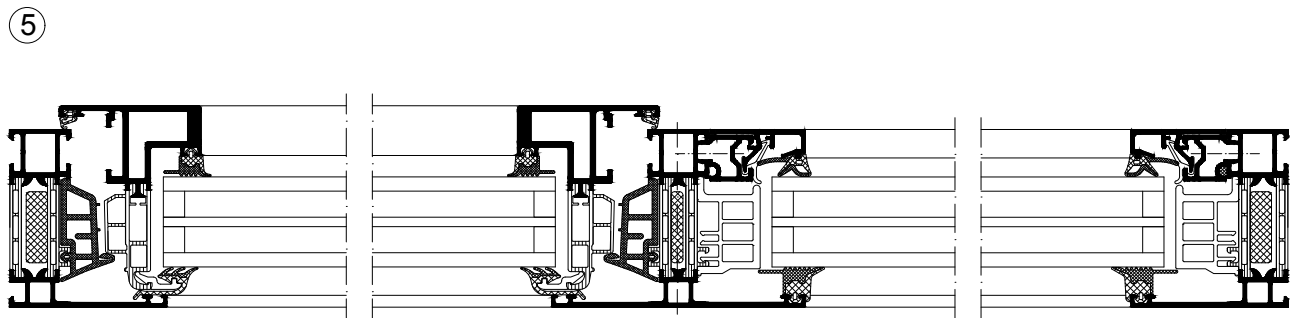
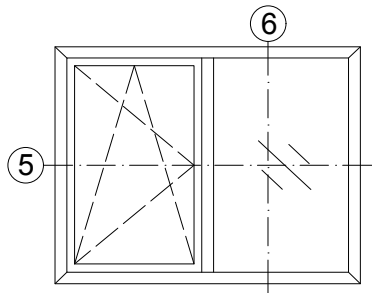

Zweiflügeliges Fenster mit Oberlicht  
Vent + vent with toplight

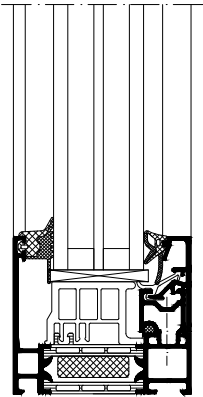
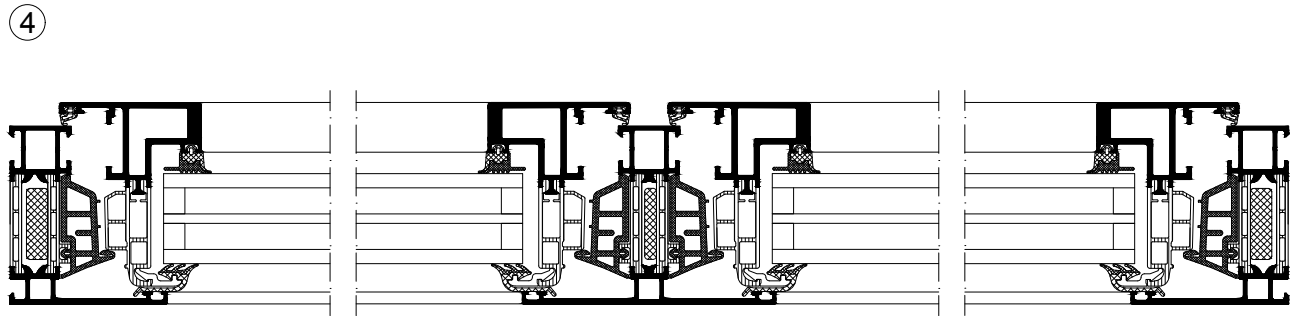
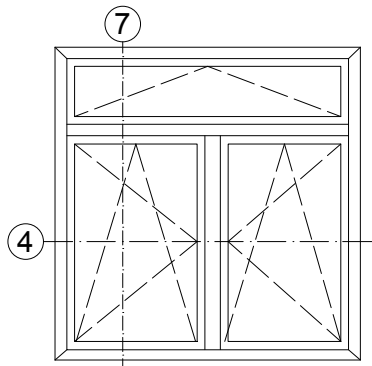

Stulpfenster mit Oberlicht  
Double-vent window with toplight

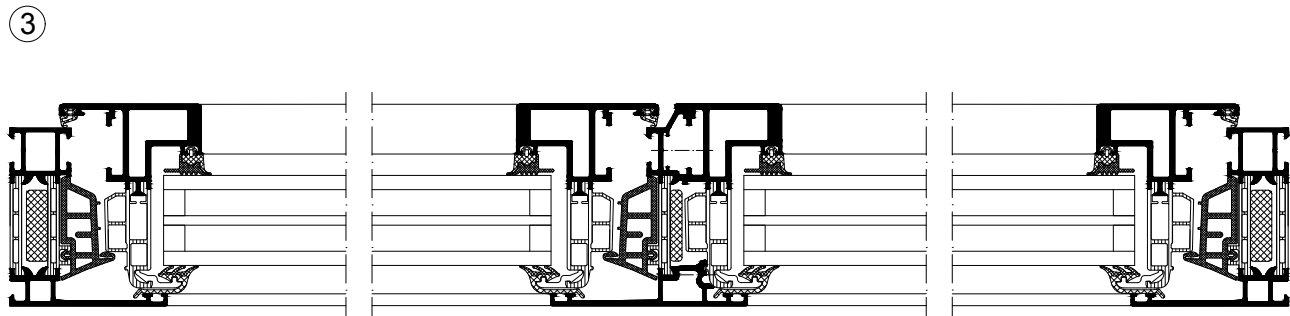
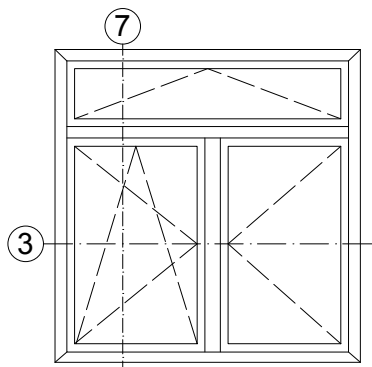

Elementschnitte - Innen öffnend  
Unit section details - Inward-opening

AB0000042

0403

Schüco AWS 75 BS.SI<sup>+</sup>

Zweiflügliges Fenster mit Unterlicht  
Vent + vent with bottom light

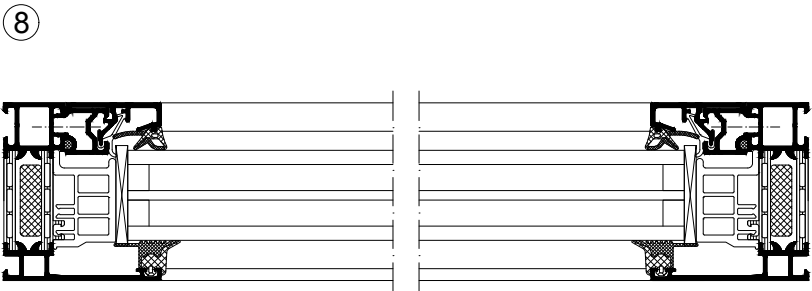
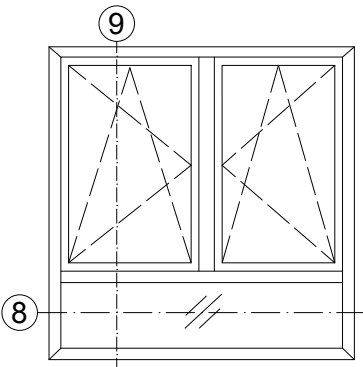

Fenstertür  
Window door

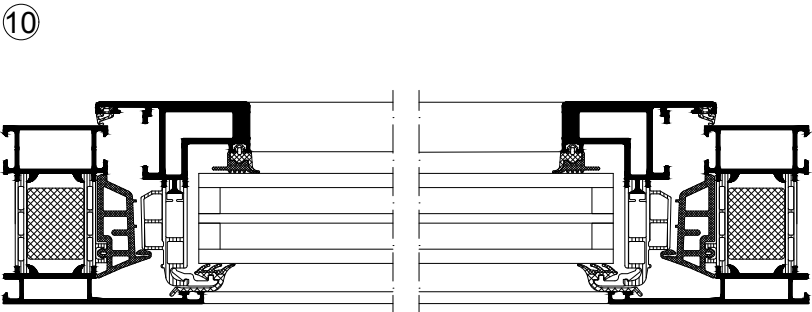
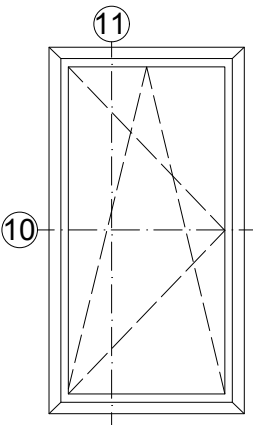

9

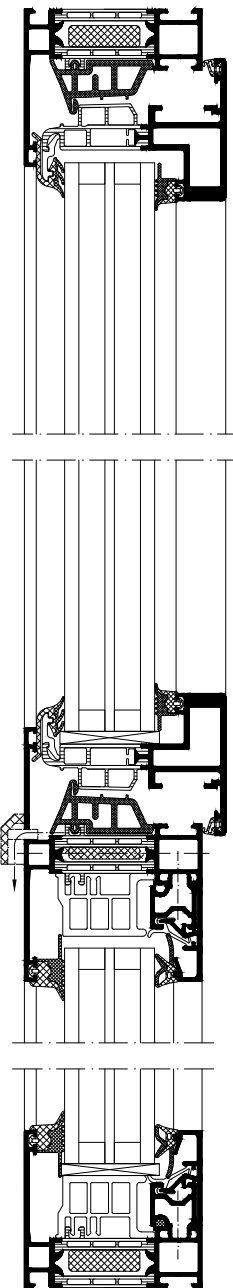

11

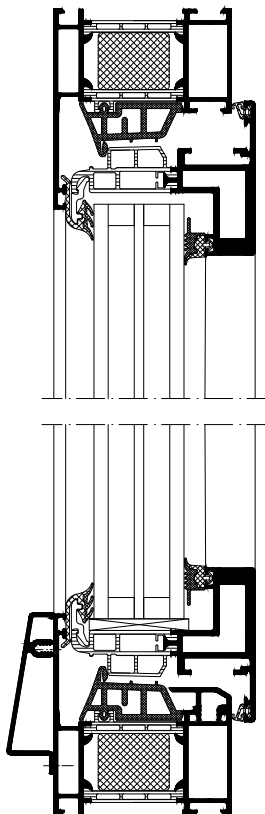

Elementschnitte - Innen öffnend  
Unit section details - Inward-opening

AB0000043

0403

Schüco AWS 75 BS.SI<sup>+</sup>

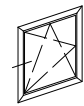

Blendrahmenprofil  
Outer frame profile

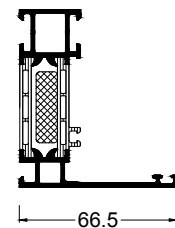
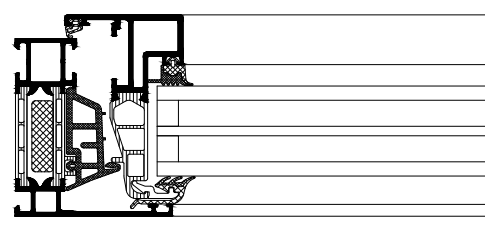

66.5

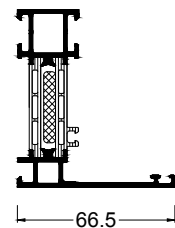

66.5

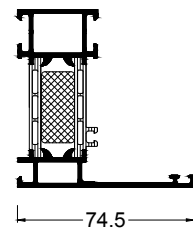

74.5

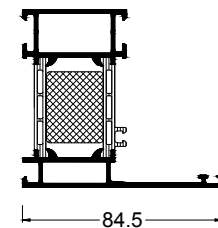

84.5

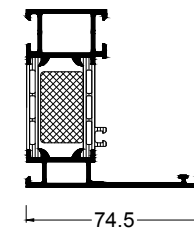

74.5

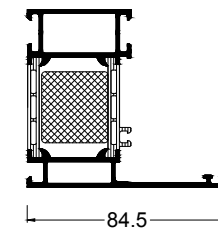

84.5

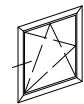

Flügelprofil  
Vent profile

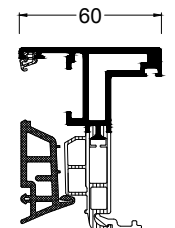
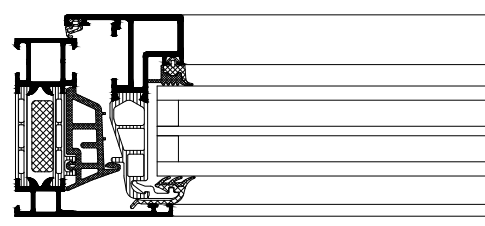

60  
12

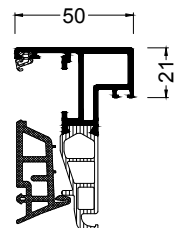

50  
21

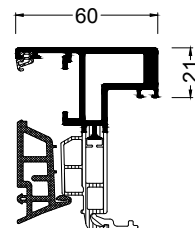

60  
21

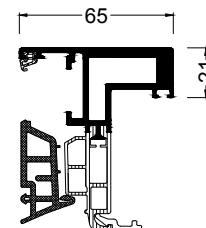

65  
21

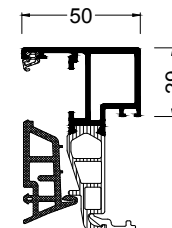

50  
29

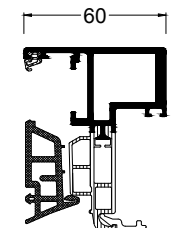

60  
29

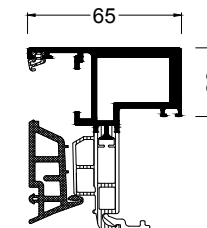

65  
29

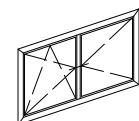

Stulpprofil und Stulpflügelprofil  
Double-vent profile and double-vent vent profile

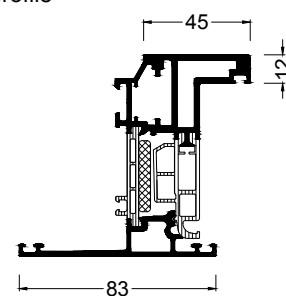
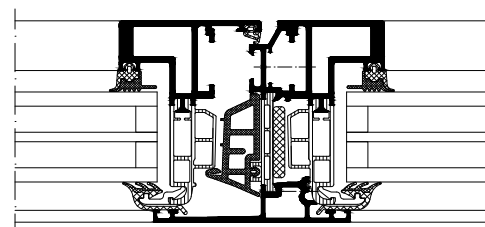

45  
12  
83

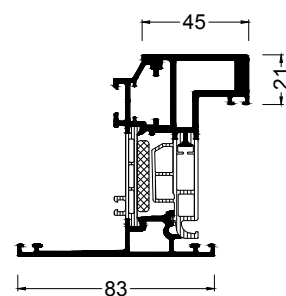

45  
21  
83

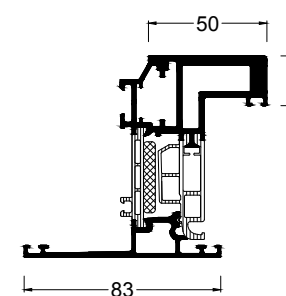

50  
21  
83

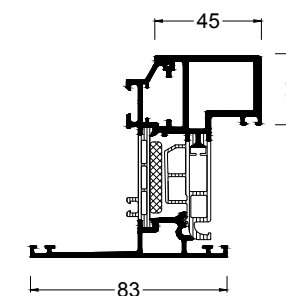

45  
30  
83

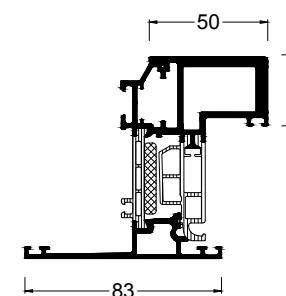

50  
30  
83

Profilsysteme - Innen öffnend

AB0000044

Profile systems - Inward-opening

0403

Schüco AWS 75 BS.SI<sup>+</sup>

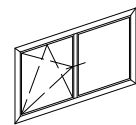

Riegel / Pfosten  
Transom/mullion

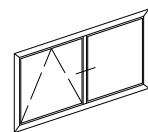
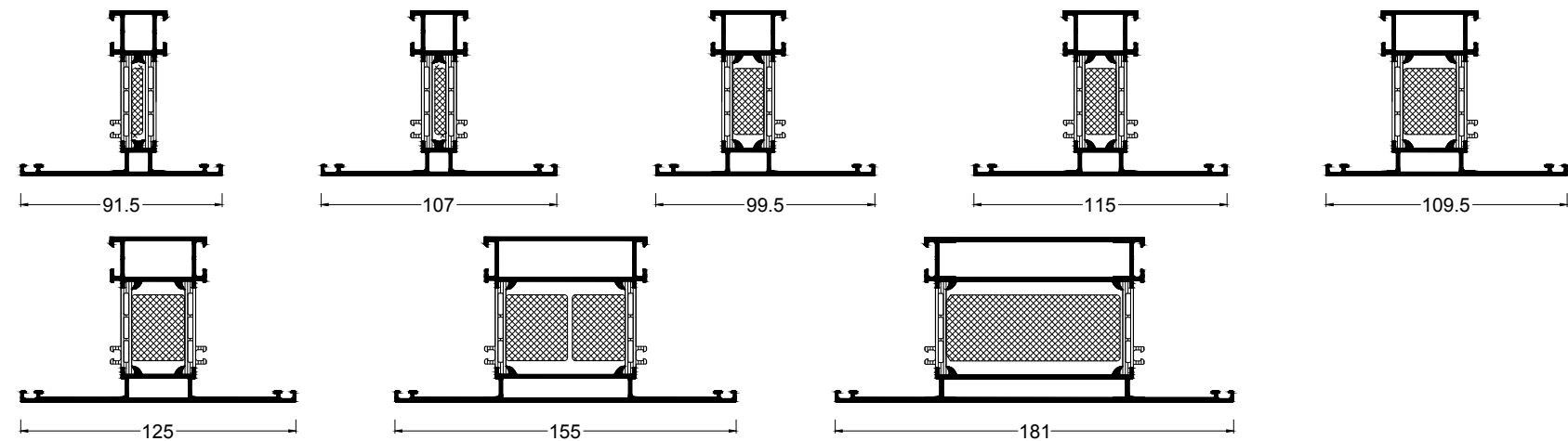
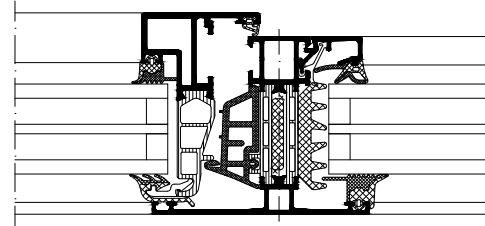

Dehnungs- und Montagestoß  
Expansion and assembly joint

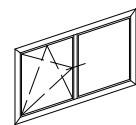
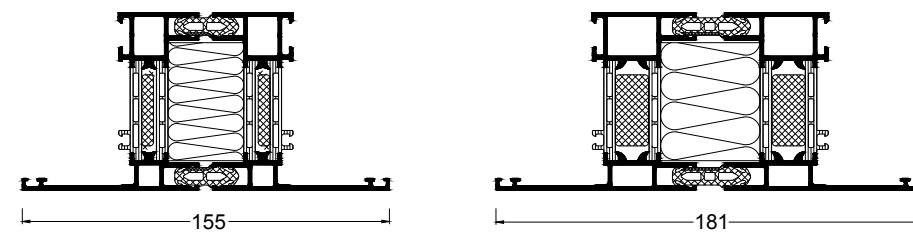
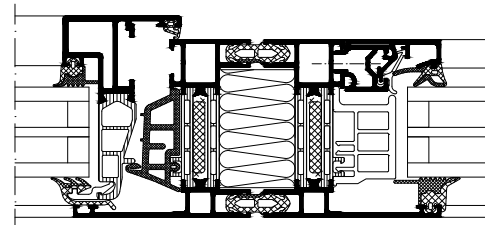

Kopplungspfosten  
Coupling mullion

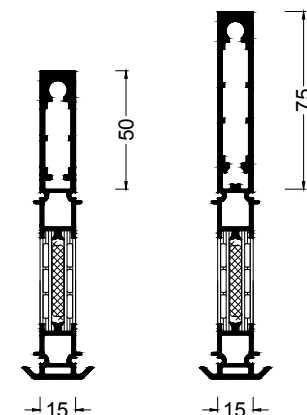
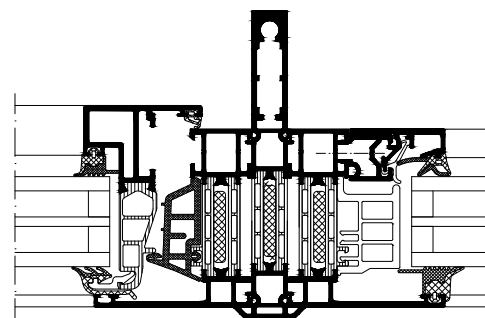

Profilsysteme - Innen öffnend  
Profile systems - Inward-opening

AB0000045

0403

Schüco AWS 75 BS.SI<sup>+</sup>



AWS 75.SI+  
AWS 75.SI+

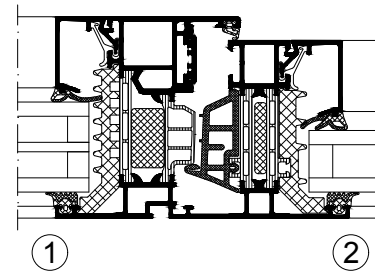

AWS 75.RL.SI+  
AWS 75.RL.SI+

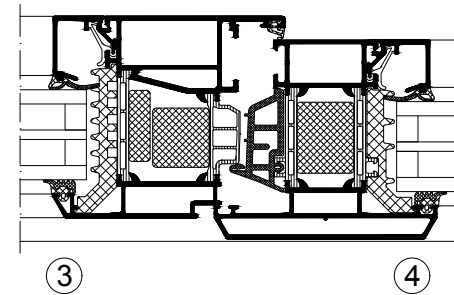

AWS 75.BS.SI+ / AWS 75.BS.HI  
AWS 75.BS.SI+ / AWS 75.BS.HI

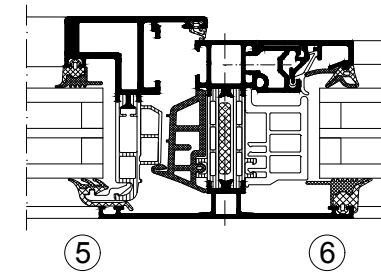

- ① \* 3-fach Verglasung - Flügel - AWS 75.SI+  
Triple glazing - vent - AWS 75.SI+

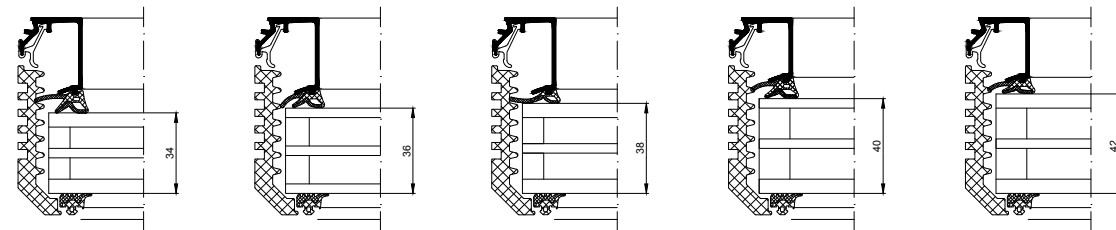

- ② \* 3-fach Verglasung - Pfosten / Blendrahmen - AWS 75.SI+  
Triple glazing - mullion / outer frame - AWS 75.SI+

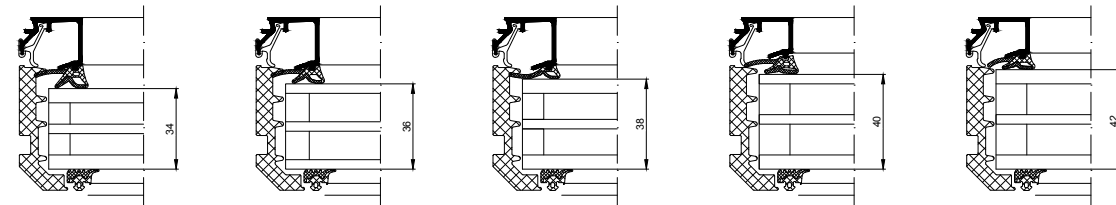

- ③ \* 3-fach Verglasung - Flügel - AWS 75.RL.SI+  
Triple glazing - vent - AWS 75.RL.SI+

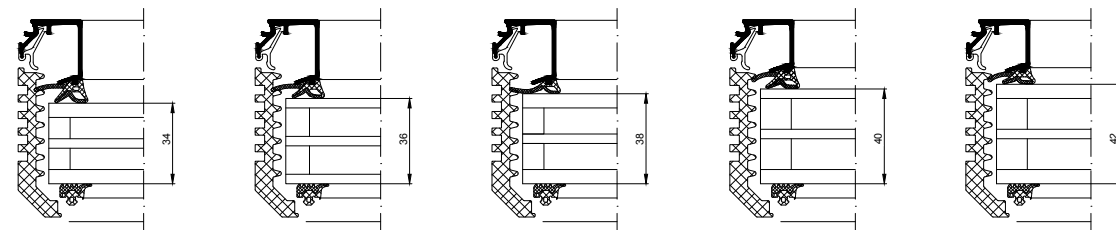

- ④ \* 3-fach Verglasung - Pfosten / Blendrahmen - AWS 75.RL.SI+  
Triple glazing - mullion / outer frame - AWS 75.RL.SI+

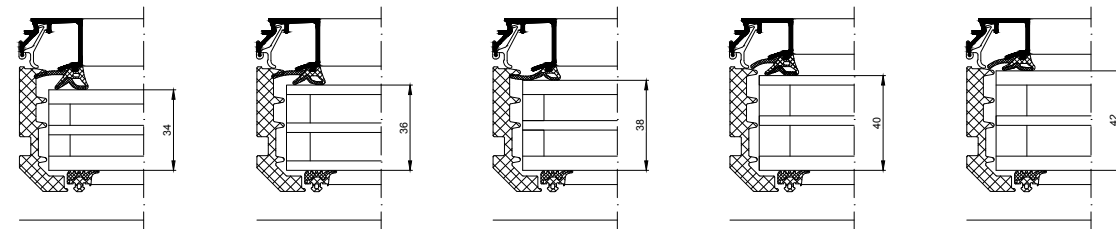

- ⑤ 3-fach Verglasung - Flügel - AWS 75.BS.SI+ und AWS 75.BS.HI  
Triple glazing - vent - AWS 75.BS.SI+ and AWS 75.BS.HI

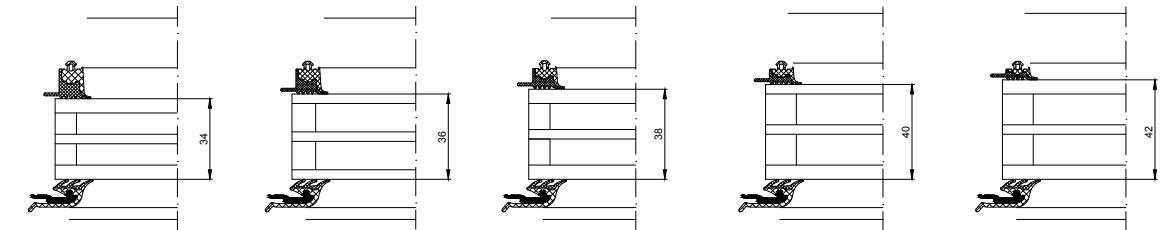

- ⑥ 3-fach Verglasung - Pfosten / Blendrahmen - AWS 75.BS.SI+ und AWS 75.BS.HI  
Triple glazing - mullion / outer frame - AWS 75.BS.SI+ and AWS 75.BS.HI

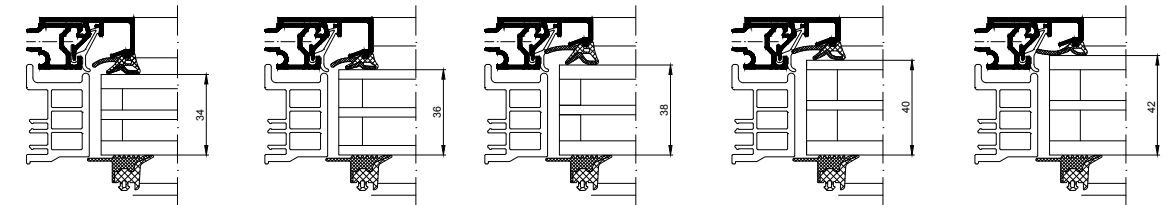

- \* Alternative Glasleisten - Gestaltungsleisten  
\* Alternative glazing beads - feature glazing beads



Profilsysteme - Verglasung  
Profile systems - Glazing

AB0000046

0302

Schüco AWS 75.BS.SI+



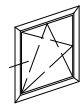

TipTronic Flügelprofil  
TipTronic vent profile

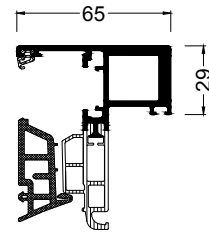
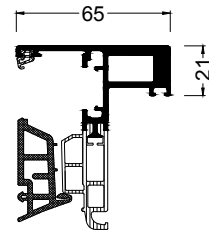
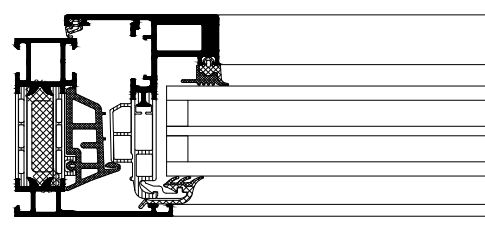

Profilsysteme - Innen öffnend  
- TipTronic  
Profile systems - Inward-opening  
- TipTronic

AB0000047

0403

Schüco AWS 75 BS.SI<sup>+</sup>

Wand mit WDVS - Anschluss in der Dämmebene  
Wall with composite thermal insulation system - attachment at insulation level

Oberer Anschluss  
Top attachment

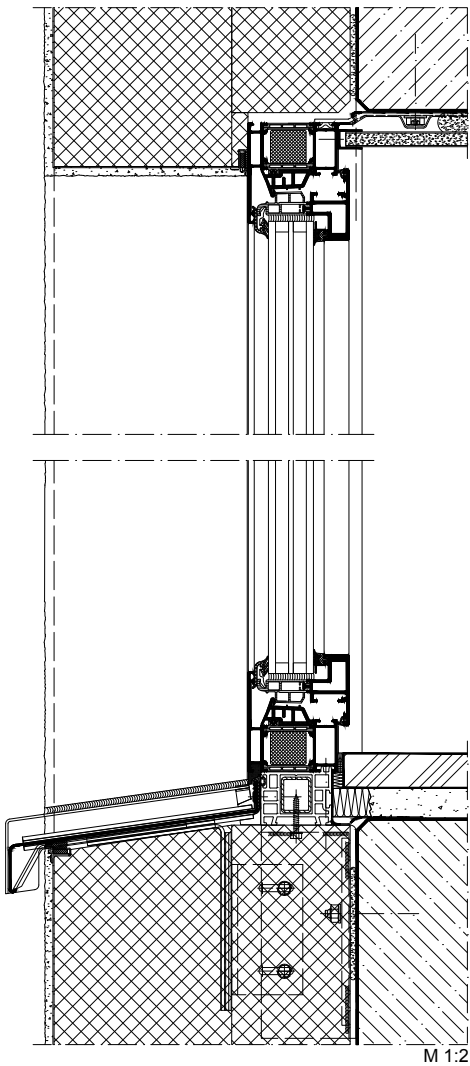

Unterer Anschluss  
Bottom attachment

Seitlicher Anschluss  
Side attachment

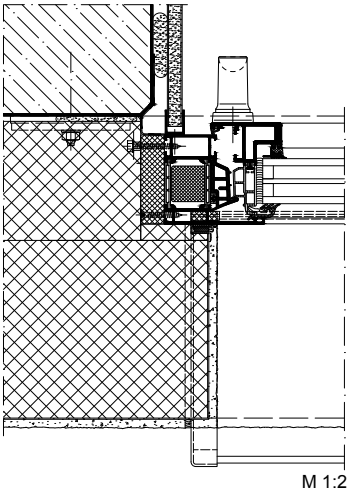

Zweischaliges Mauerwerk  
Double-skin masonry

Oberer Anschluss  
Top attachment

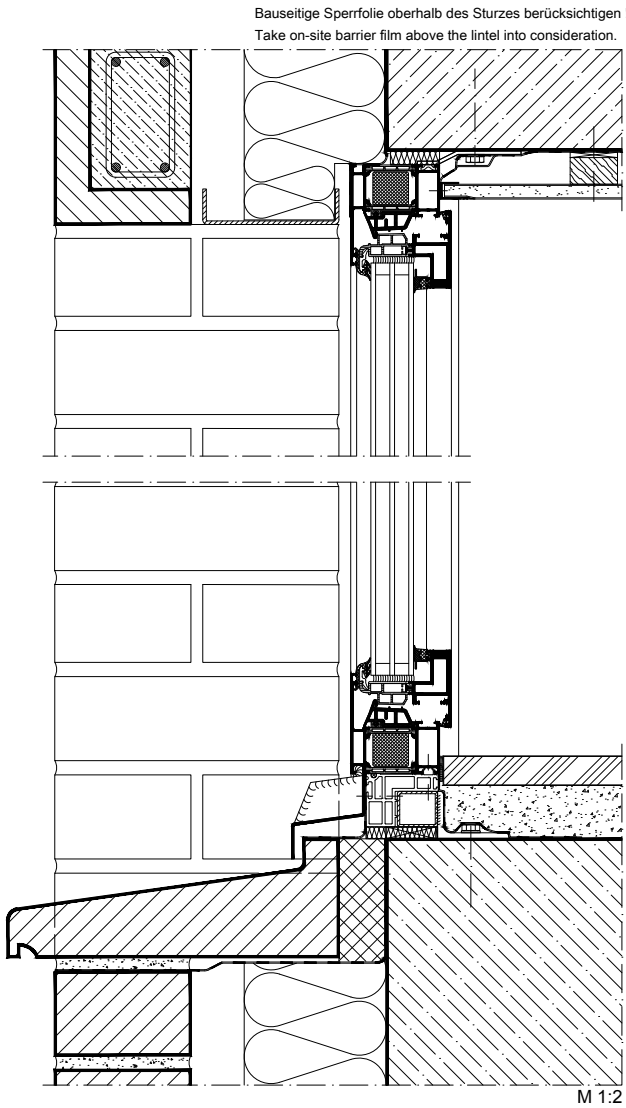

Unterer Anschluss  
Bottom attachment

Seitlicher Anschluss  
Side attachment

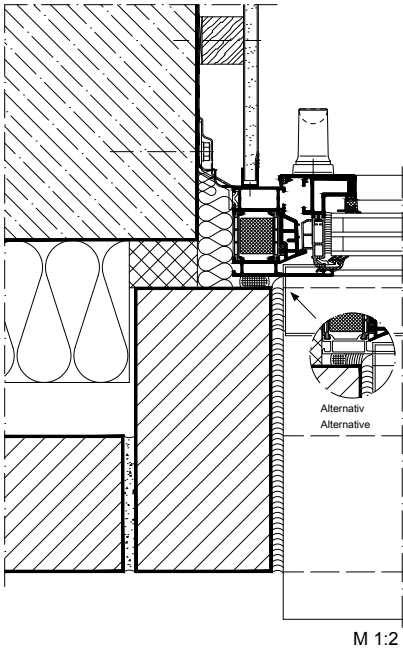

Baukörperanschlüsse - Innen öffnend  
Attachments to building structure  
- Inward-opening

AB0000048

0403

Schüco AWS 75 BS.SI<sup>+</sup>