

Einflügelige Tür
Single-leaf door

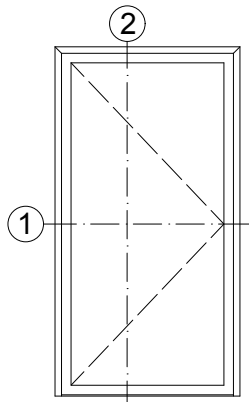

Zweiflügelige Tür
Double-leaf door

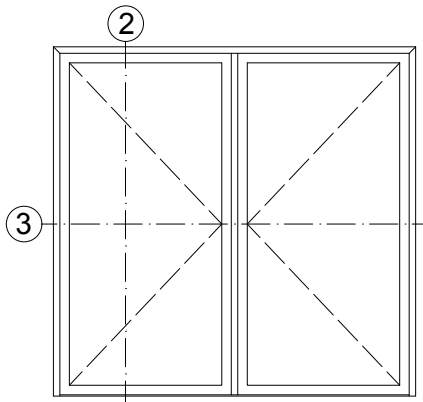

Zweiflügelige Tür mit Festfeld
Double-leaf door with fixed light

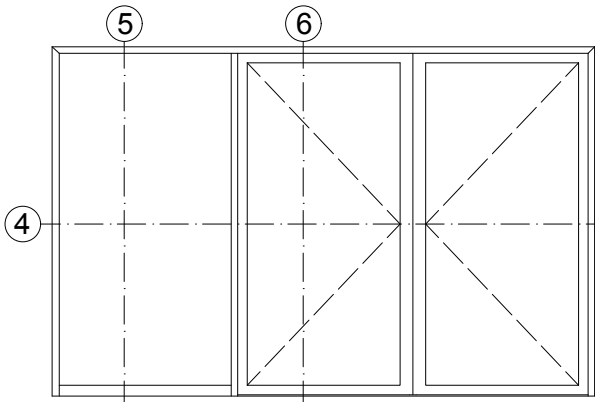

Einflügelige Tür mit Oberlicht
Single-leaf door with toplight

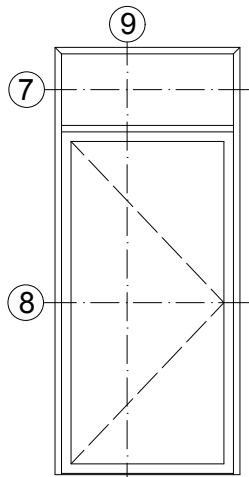

Einflügelige Tür mit Festfeld
Single-leaf door with fixed light

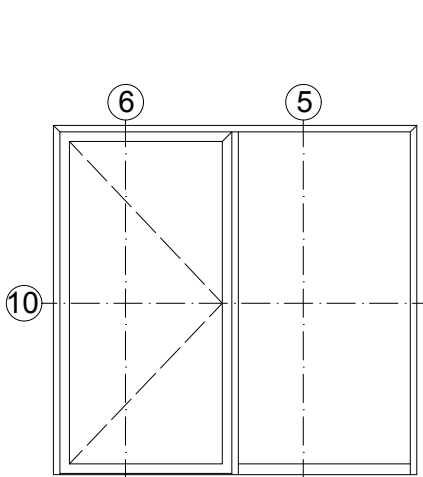

Zweiflügelige Tür mit Festfeld und Oberlicht
Double-leaf door with fixed light and toplight

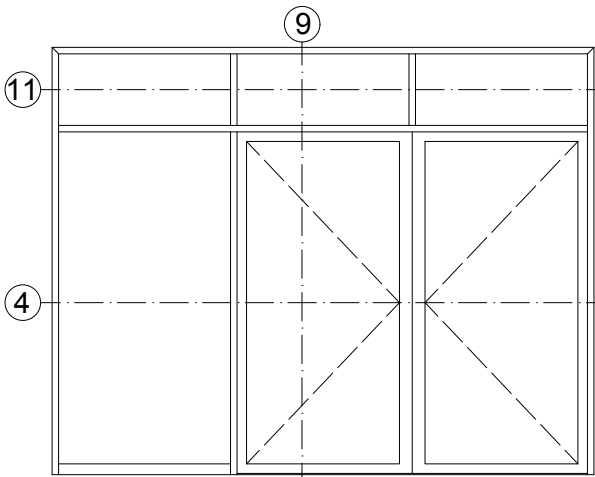

Einsatzelemente sind in Fassadensysteme zu finden
Insert units can be found in façade systems

Technische Informationen
Technical information

Prüfungen und Normen ** Tests and standards	
Wärmedämmung nach DIN EN ISO 1077-2 Thermal insulation in accordance with DIN EN ISO 1077-2	Uf = 2,21 W/(m²K)
Schalldämmung nach DIN EN ISO 140-3 Sound reduction in accordance with DIN EN ISO 140-3	bis Rw 43 dB Up to Rw 43 dB
Einbruchhemmung nach DIN V ENV 1627 (DIN EN 1627) Burglar resistance in accordance with DIN V ENV 1627 (DIN EN 1627)	Klasse WK3 (RC 3) Class WK3 (RC 3)
Luftdurchlässigkeit nach DIN EN 12207 Air permeability in accordance with DIN EN 12207	Klasse 2 Class 2
Schlagregendichtheit nach DIN EN 12208 Watertightness in accordance with DIN EN 12208	Klasse 5A Class 5A
Windlastwiderstand nach DIN EN 12210 * Wind load resistance in accordance with DIN EN 12210	Klasse 2 Class 2
Mechanische Beanspruchung nach DIN EN 13115 Mechanical loading in accordance with DIN EN 13115	Klasse 2 Class 2
Dauerfunktion nach DIN EN 12400 Durability in accordance with DIN EN 12400	Klasse 6 Class 6

* Durchbiegungsverhalten profilabhängig
The amount of deflection will depend on the profile

** Die Angaben beschreiben die Bestwerte des Gesamtsystems bei innen als auch außen öffnenden Ausführungen. Die Eigenschaften einer jeweils gewählten Ausführungsvariante oder Elementkombination sind im Einzelfall anhand der ausführlichen Prüfdokumentation zu bestimmen.
The information describes the optimum values of the entire system for both inward and outward-opening designs. The properties of a selected design option or unit combination have to be determined individually based on the comprehensive test documentation.

Elementbeispiele
- Innen öffnend, flächenbündig
Unit examples
- Inward-opening, flush-fitted

AB2000155

0201

Schüco ADS 70 HD

Einflügelige Tür
Single-leaf door

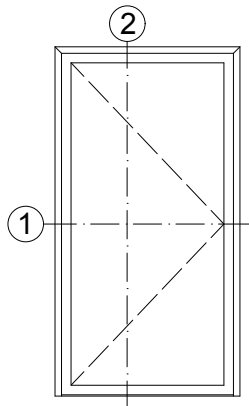

①



① Flügelüberdeckend einseitig
Leaf-enclosing on one side

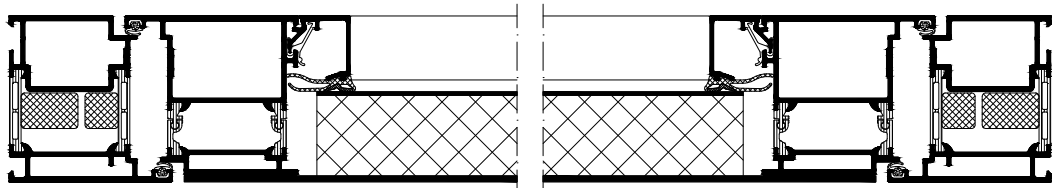

Flügelüberdeckend einseitig
Leaf-enclosing on one side

②

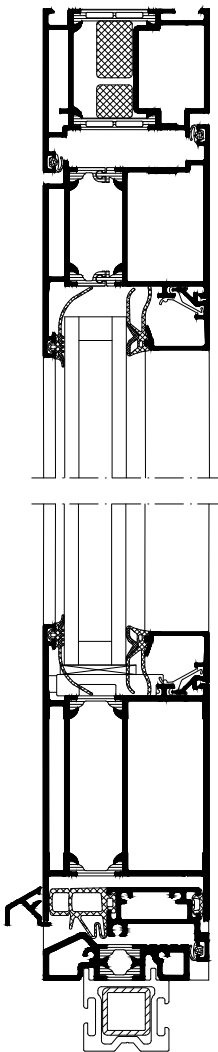

②

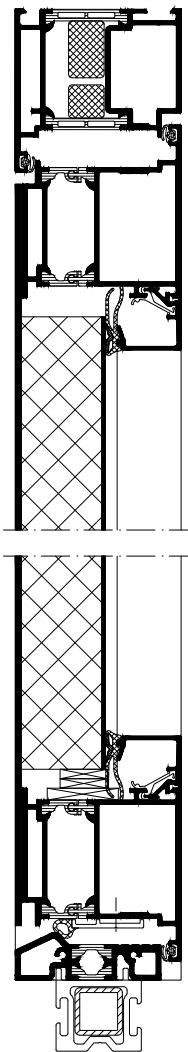

Elementschnitte
- Innen öffnend, flächenbündig
Unit section details
- Inward-opening, flush-fitted

AB2000156

0201

Schüco ADS 70 HD

Zweiflügelige Tür
Double-leaf door

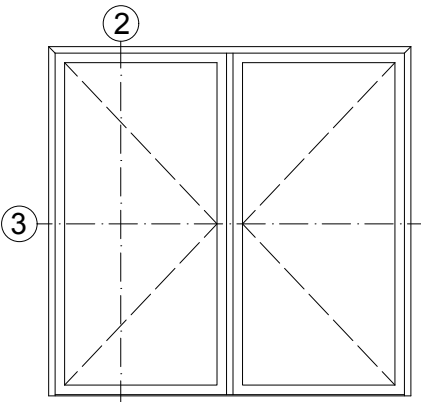

3

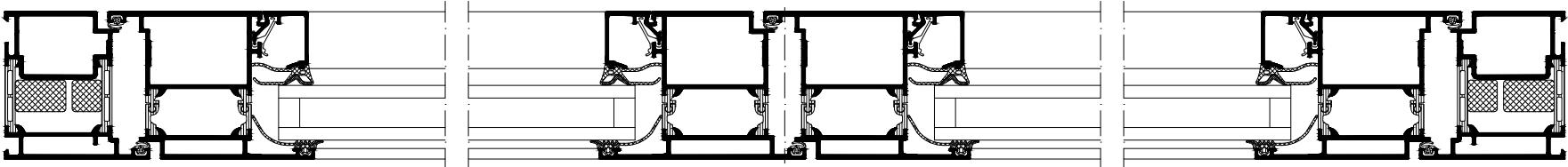

3

Flügelüberdeckend einseitig
Leaf-enclosing on one side

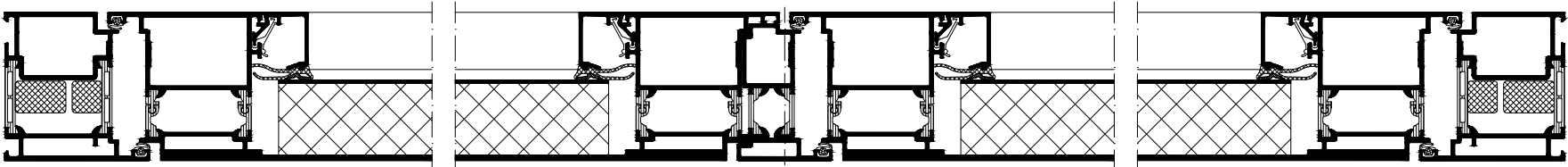

Flügelüberdeckend einseitig
Leaf-enclosing on one side

2

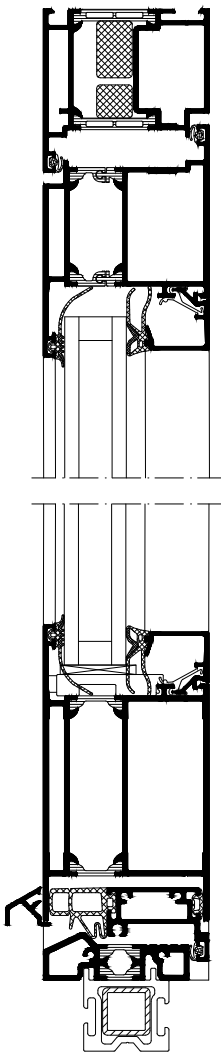

2

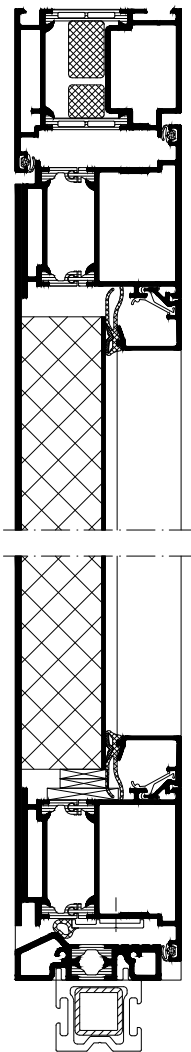

Elementschnitte
- Innen öffnend, flächenbündig
Unit section details
- Inward-opening, flush-fitted

AB2000157

0201

Schüco ADS 70 HD

Zweiflügelige Tür mit Festfeld
Double-leaf door with fixed light

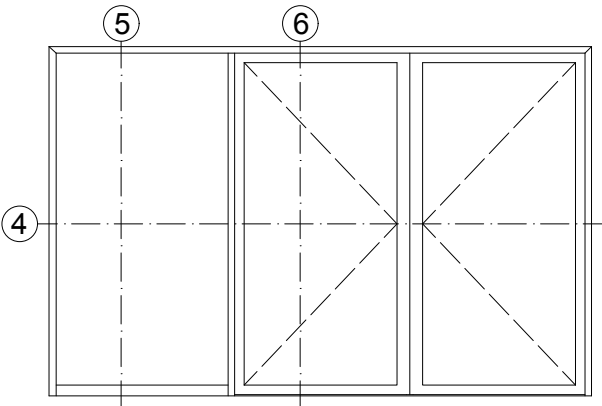

④

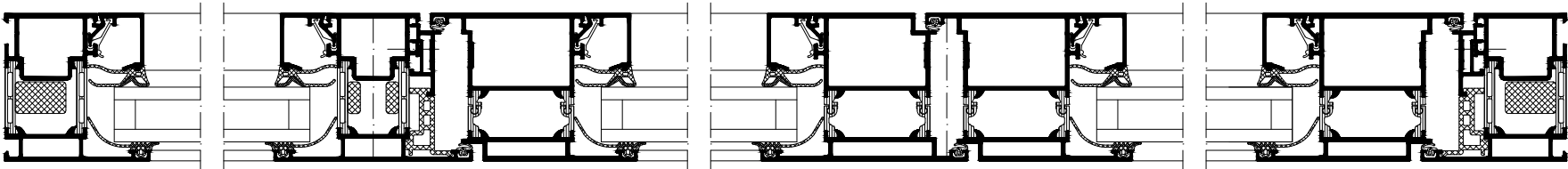

⑤

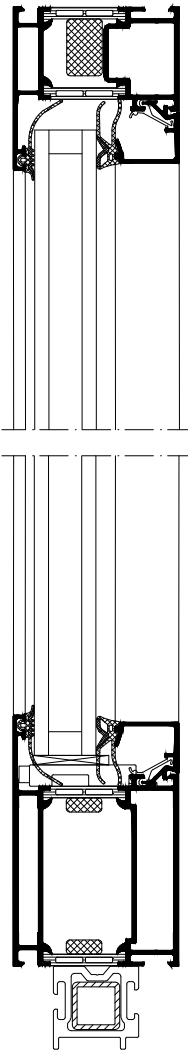

⑥

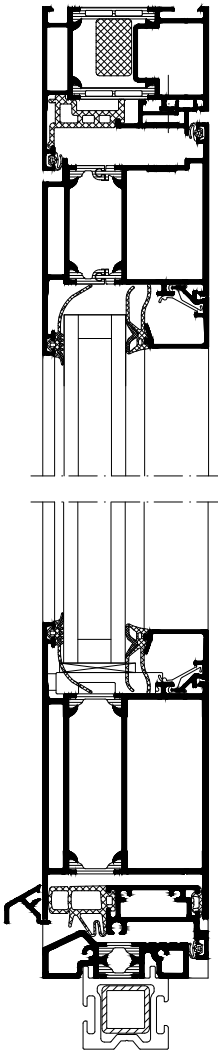

Elementschnitte
- Innen öffnend, flächenbündig
Unit section details
- Inward-opening, flush-fitted

AB2000158

0201

Schüco ADS 70 HD

Einflügelige Tür mit Oberlicht
Single-leaf door with toplight

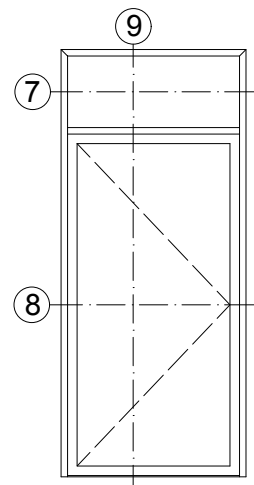

7

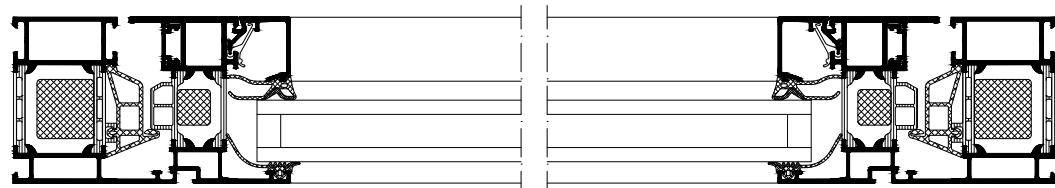

8

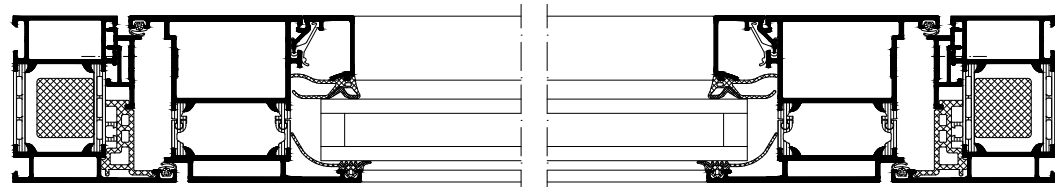

9

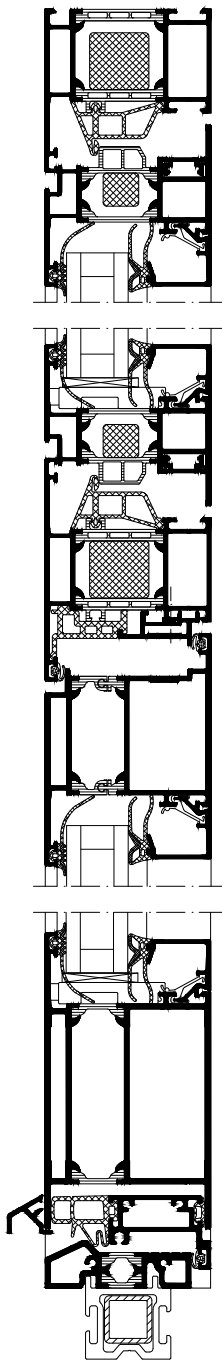

Elementschnitte
- Innen öffnend, flächenbündig
Unit section details
- Inward-opening, flush-fitted

AB2000159

0201

Schüco ADS 70 HD

Einflügelige Tür mit Festfeld
Single-leaf door with fixed light

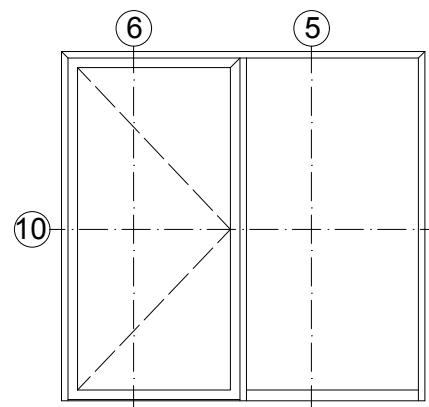

10

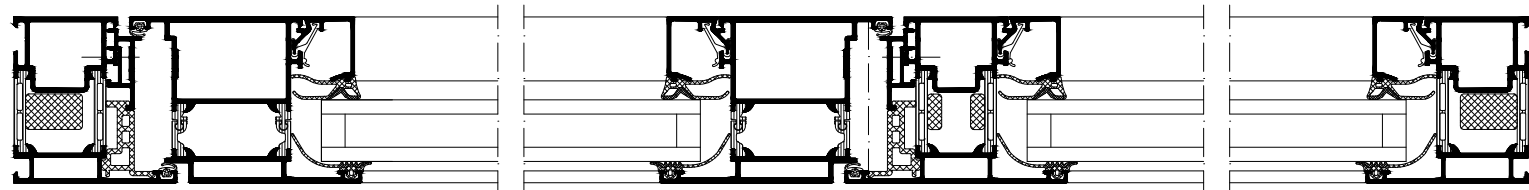

6

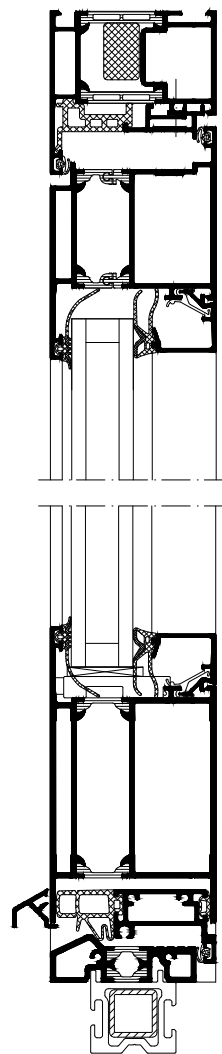

5

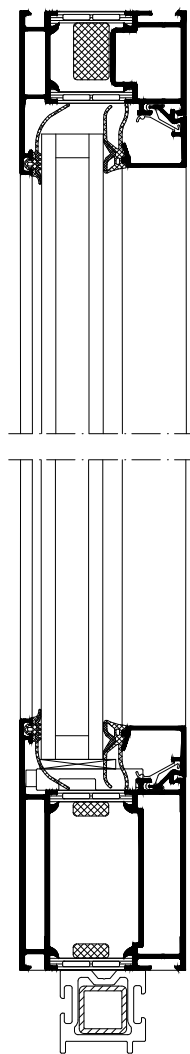

Elementschnitte
- Innen öffnend, flächenbündig
Unit section details
- Inward-opening, flush-fitted

AB2000160

0201

Schüco ADS 70 HD

Zweiflügelige Tür mit Festfeld und Oberlicht
Double-leaf door with fixed light and toplight

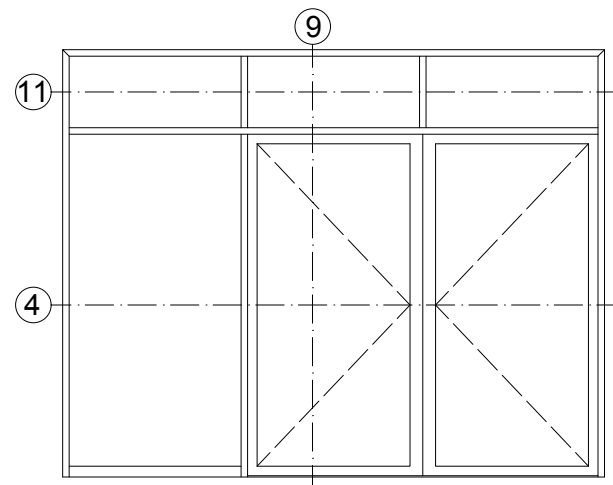

11

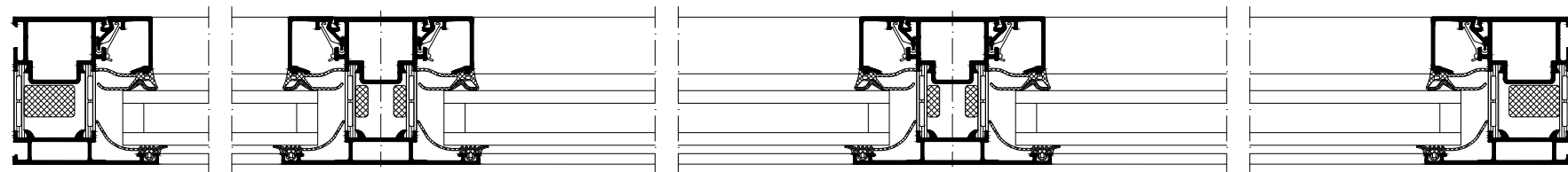

4

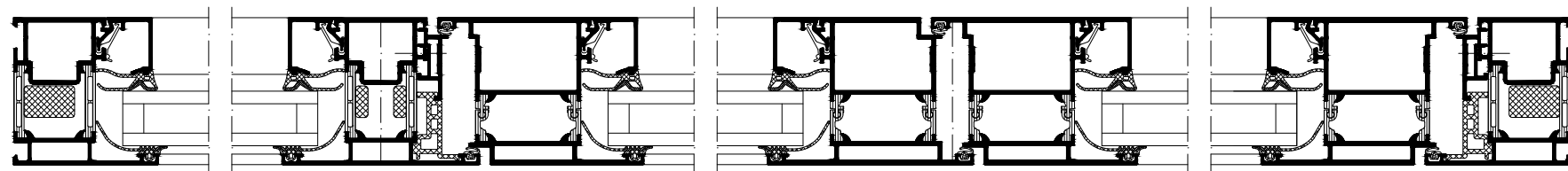

9

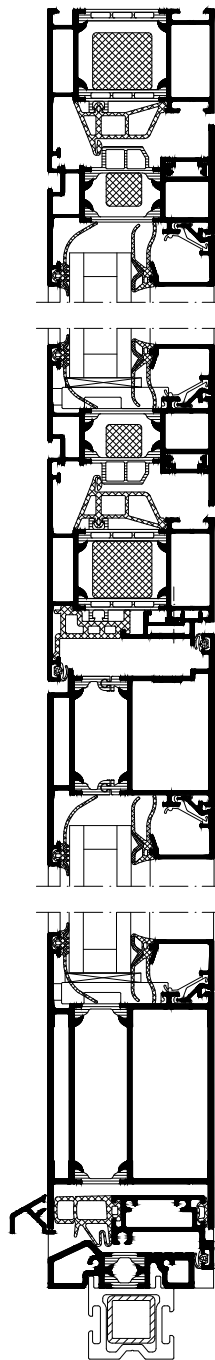

Elementschnitte
- Innen öffnend, flächenbündig
Unit section details
- Inward-opening, flush-fitted

AB2000161

0201

Schüco ADS 70 HD

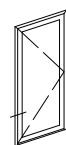

Blendraahmenprofil
Outer frame profile

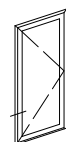
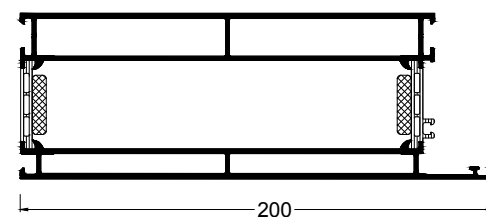
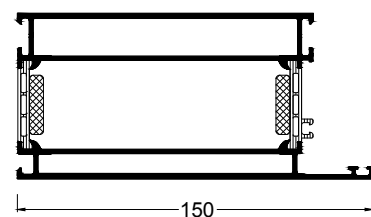
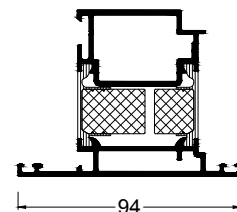
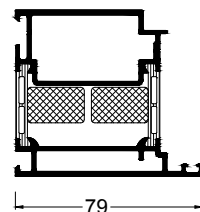
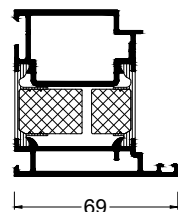
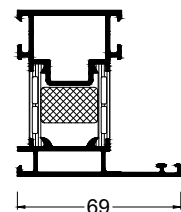
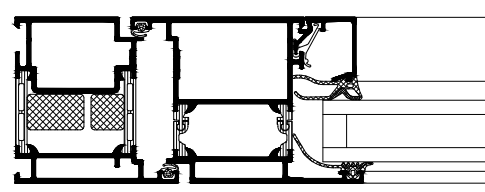

Blendraahmenverbreiterungsprofil
Outer frame extension profile

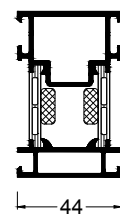
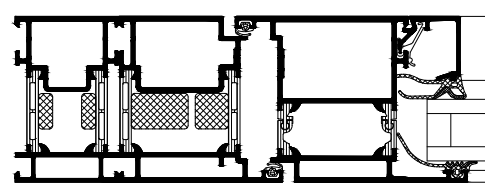

Wechselprofil
Reverse rebate profile

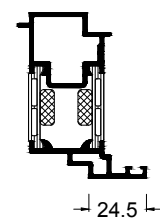
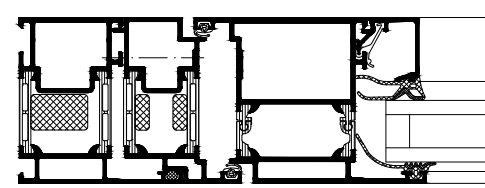

Profilsysteme
- Innen öffnend, flächenbündig
Profile systems
- Inward-opening, flush-fitted

AB2000162

0201

Schüco ADS 70 HD



Flügelprofil
Leaf profile

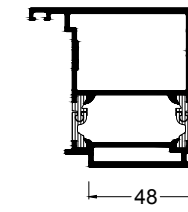
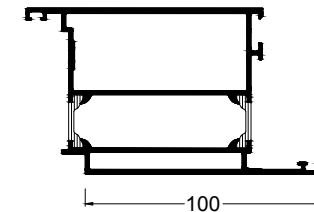
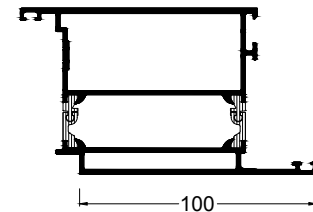
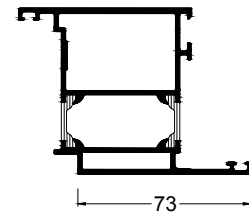
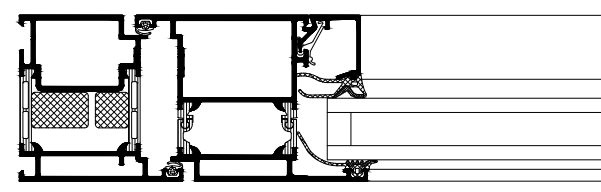

Flügelüberdeckend einseitig
Leaf-enclosing on one side

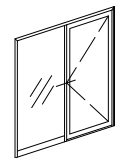

Statikpfosten
Structural mullion

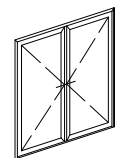
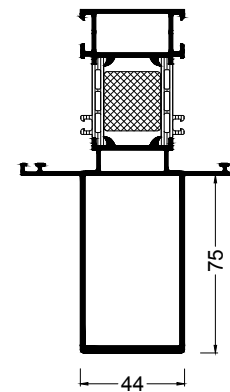
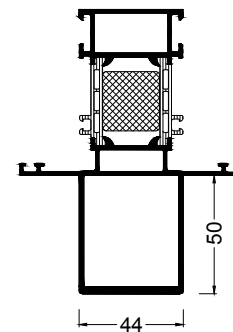
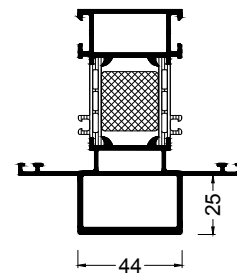
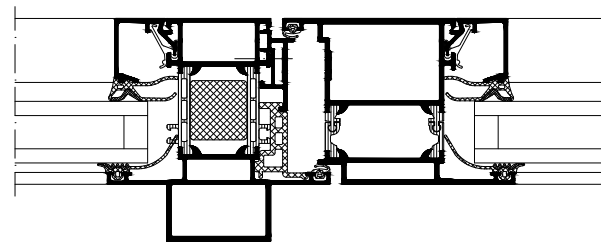

Stulpprofil
Meeting stile profile

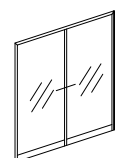
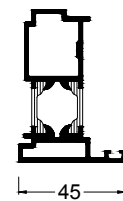
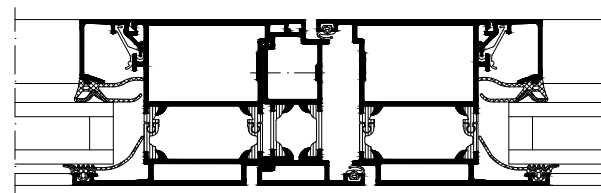

Riegel/Pfosten
Transom/mullion

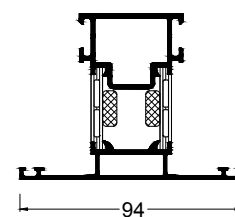
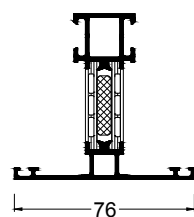
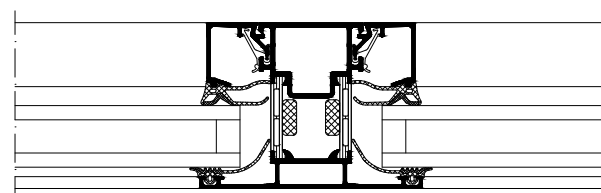

Profilsysteme
- Innen öffnend, flächenbündig
Profile systems
- Inward-opening, flush-fitted

AB2000163

0201

Schüco ADS 70 HD

<div data-bbox="291 237 378 377"> </div> <div data-bbox="495 301 582 366"> <p>Profile Profiles</p> </div> <div data-bbox="698 183 873 247"> <p>Sockel Festfeld Sill, fixed light</p> </div> <div data-bbox="262 398 480 873"> </div> <div data-bbox="611 431 1121 786"> </div> <div data-bbox="291 991 422 1056"> <p>Varianten Options</p> </div> <div data-bbox="262 1088 509 1563"> </div>	<div data-bbox="1572 237 1659 377"> </div> <div data-bbox="1776 301 1863 366"> <p>Profile Profiles</p> </div> <div data-bbox="2009 183 2285 247"> <p>Sockel Öffnungselement Sill, opening unit</p> </div> <div data-bbox="1572 398 1761 873"> </div> <div data-bbox="1892 431 2402 786"> </div> <div data-bbox="1572 991 1703 1056"> <p>Varianten Options</p> </div> <div data-bbox="1543 1088 2664 1563"> </div>				
<div data-bbox="29 2058 582 2091"> <p>A-12 Systemzeichnungen • System drawings</p> </div> <div data-bbox="1106 2058 1543 2091"> <p>10.2017 / CAD-Bibliothek / CAD Library</p> </div>	<div data-bbox="2169 1800 2868 2058"> <table> <tr> <td data-bbox="2169 1800 2693 1940"> <p>Profilsysteme - Innen öffnend, flächenbündig</p> <p>Profile systems - Inward-opening, flush-fitted</p> </td><td data-bbox="2693 1800 2868 1940"> <p>AB2000164</p> </td></tr> <tr> <td data-bbox="2169 1940 2693 2058"> <p>Schüco ADS 70 HD</p> </td><td data-bbox="2693 1940 2868 2058"> <p>0201</p> </td></tr> </table> </div> <div data-bbox="1951 2058 2868 2123"> <p>Technische Änderungen vorbehalten. Alle Rechte vorbehalten. • Subject to change without notice. All rights reserved. Sous réserve de modifications techniques. Tous droits réservés. • Technische wijzigingen voorbehouden. Alle rechten voorbehouden. ©Schüco International KG, Bielefeld, Germany.</p> </div>	<p>Profilsysteme - Innen öffnend, flächenbündig</p> <p>Profile systems - Inward-opening, flush-fitted</p>	<p>AB2000164</p>	<p>Schüco ADS 70 HD</p>	<p>0201</p>
<p>Profilsysteme - Innen öffnend, flächenbündig</p> <p>Profile systems - Inward-opening, flush-fitted</p>	<p>AB2000164</p>				
<p>Schüco ADS 70 HD</p>	<p>0201</p>				

Wand mit WDVS
Wall with composite
thermal insulation
system

Oberer Anschluss
Top attachment

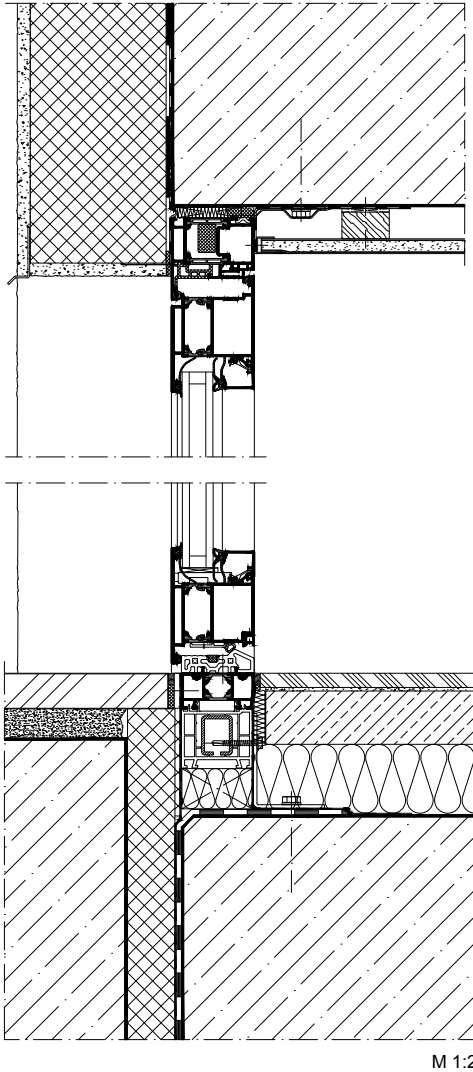

Unterer Anschluss
Bottom attachment

Seitlicher Anschluss
Side attachment

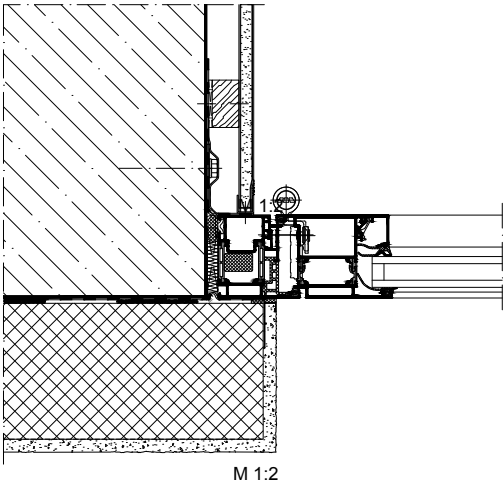

Baukörperanschlüsse
- Innen öffnend, flächenbündig
Attachments to building structure
- Inward-opening, flush-fitted

AB2000165

0201

Schüco ADS 70 HD

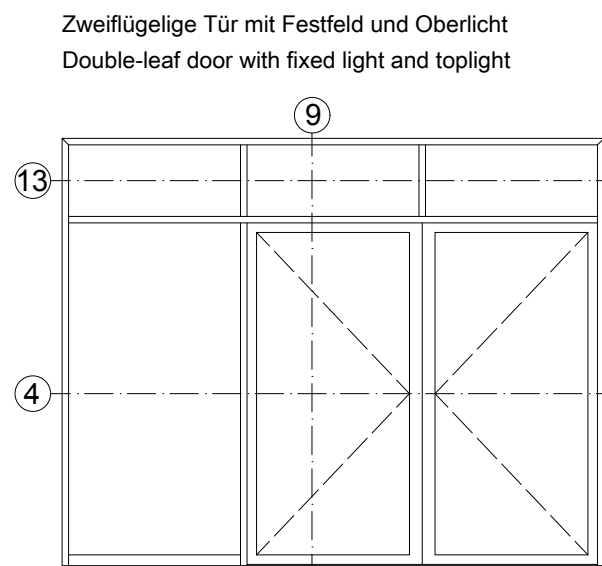
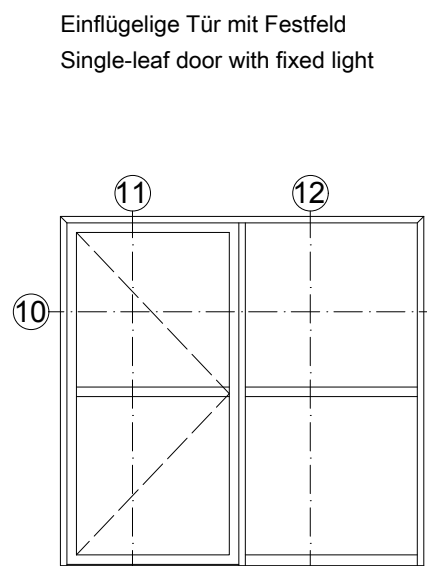
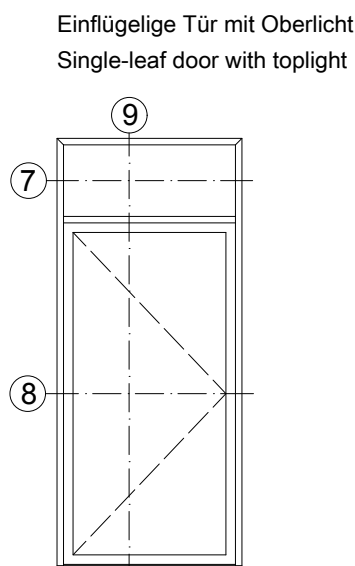
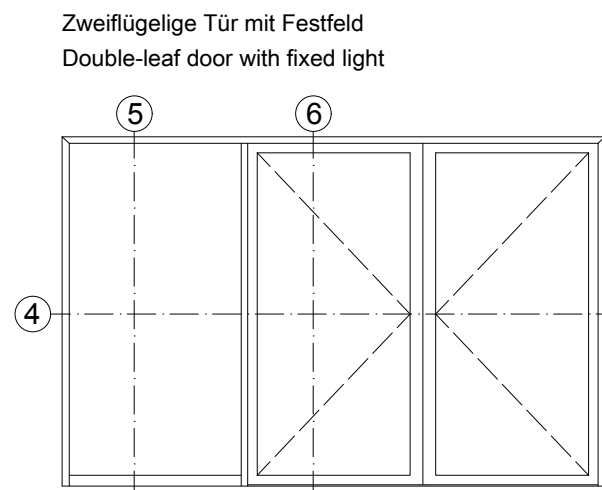
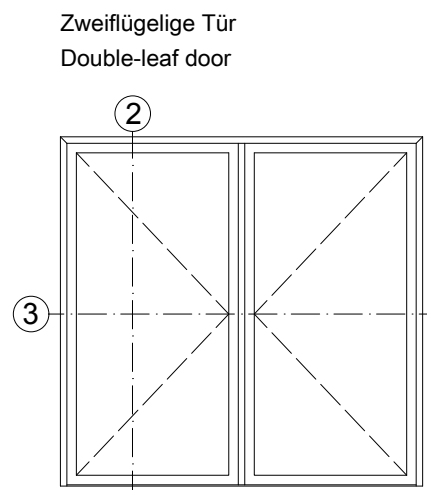
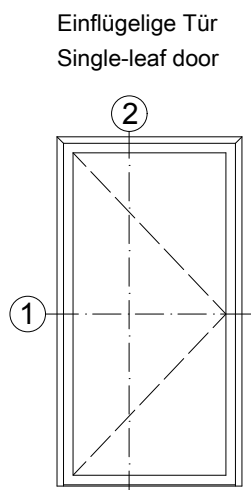

Technische Informationen

Technical information

Prüfungen und Normen **

Tests and standards

Wärmedämmung nach DIN EN ISO 1077-2 Thermal insulation in accordance with DIN EN ISO 1077-2	Uf = 2,21 W/(m²K)
Schalldämmung nach DIN EN ISO 140-3 Sound reduction in accordance with DIN EN ISO 140-3	bis Rw 43 dB Up to Rw 43 dB
Einbruchhemmung nach DIN V ENV 1627 (DIN EN 1627) Burglar resistance in accordance with DIN V ENV 1627 (DIN EN 1627)	Klasse WK3 (RC 3) Class WK3 (RC 3)
Luftdurchlässigkeit nach DIN EN 12207 Air permeability in accordance with DIN EN 12207	Klasse 2 Class 2
Schlagregendichtheit nach DIN EN 12208 Watertightness in accordance with DIN EN 12208	Klasse 5A Class 5A
Windlastwiderstand nach DIN EN 12210 * Wind load resistance in accordance with DIN EN 12210	Klasse 2 Class 2
Mechanische Beanspruchung nach DIN EN 13115 Mechanical loading in accordance with DIN EN 13115	Klasse 2 Class 2
Dauerfunktion nach DIN EN 12400 Durability in accordance with DIN EN 12400	Klasse 6 Class 6

* Durchbiegungsverhalten profilabhängig
The amount of deflection will depend on the profile

** Die Angaben beschreiben die Bestwerte des Gesamtsystems bei innen als auch außen öffnenden Ausführungen. Die Eigenschaften einer jeweils gewählten Ausführungsvariante oder Elementkombination sind im Einzelfall anhand der ausführlichen Prüfdokumentation zu bestimmen.
The information describes the optimum values of the entire system for both inward and outward-opening designs. The properties of a selected design option or unit combination have to be determined individually based on the comprehensive test documentation.

Elementbeispiele
- Innen öffnend, aufschlagend
Unit examples
- Inward-opening, face-fitted

AB2000176

0201

Schüco ADS 70 HD

Einflügelige Tür
Single-leaf door

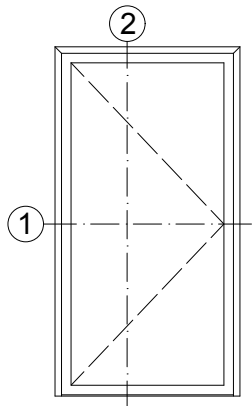

①

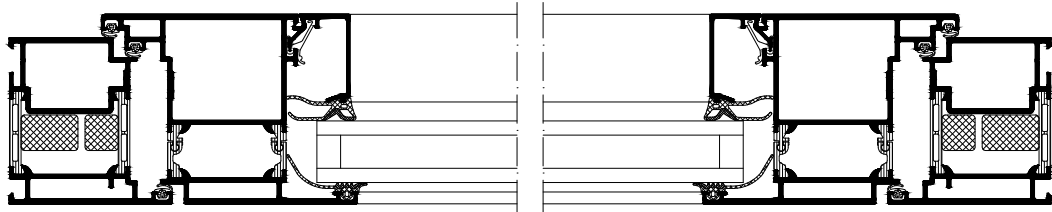

①

Flügelüberdeckend einseitig
Leaf-enclosing on one side

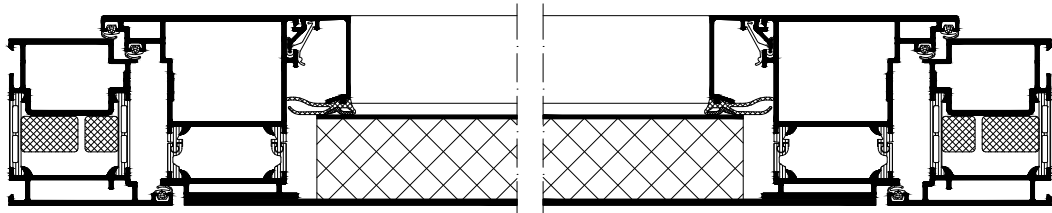

Flügelüberdeckend einseitig
Leaf-enclosing on one side

②

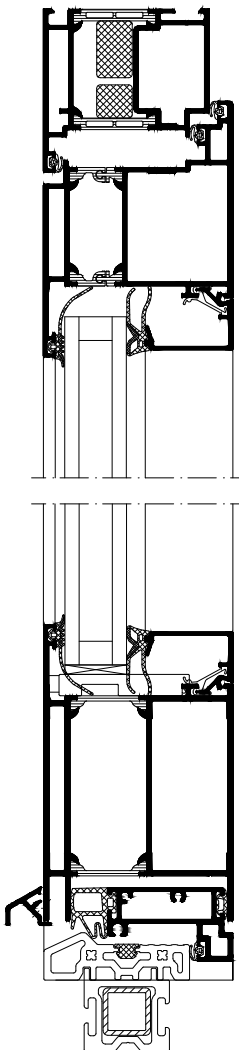

②

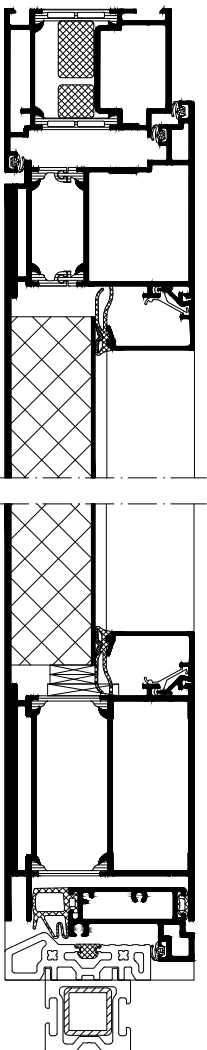

Elementschnitte
- Innen öffnend, aufschlagend
Unit section details
- Inward-opening, face-fitted

AB2000177

0201

Schüco ADS 70 HD

Zweiflügelige Tür
Double-leaf door

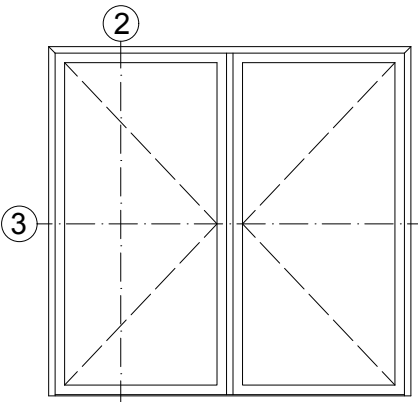

3

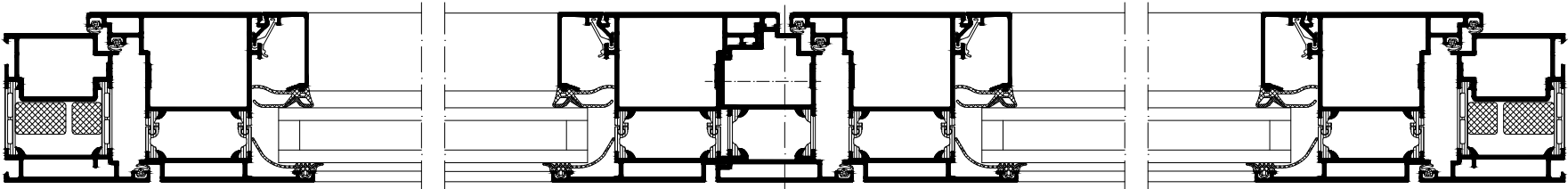

3

Flügelüberdeckend einseitig
Leaf-enclosing on one side

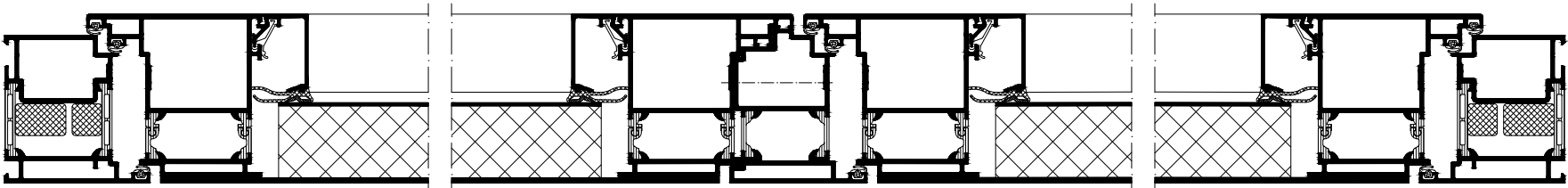

Flügelüberdeckend einseitig
Leaf-enclosing on one side

2

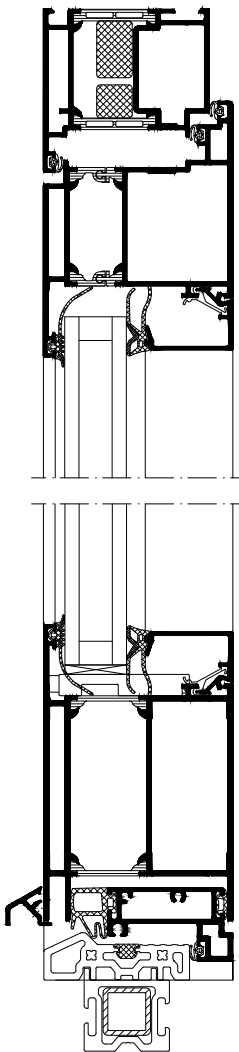

2

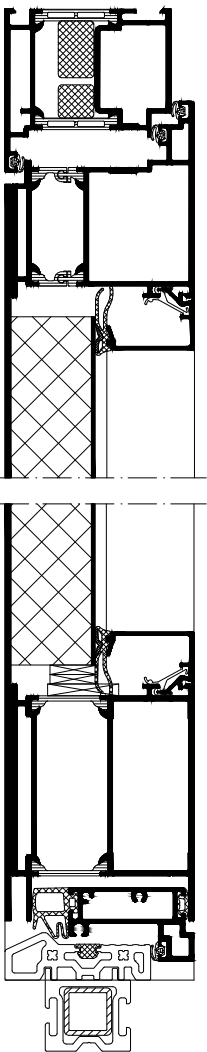

Elementschnitte
- Innen öffnend, aufschlagend
Unit section details
- Inward-opening, face-fitted

AB2000178

0201

Schüco ADS 70 HD

Zweiflügelige Tür mit Festfeld
Double-leaf door with fixed light

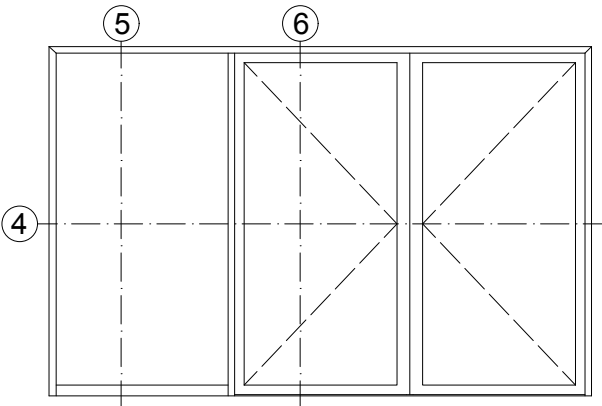

④

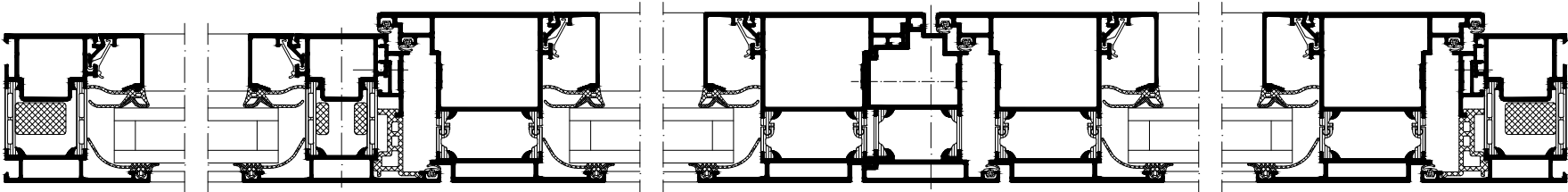

⑤

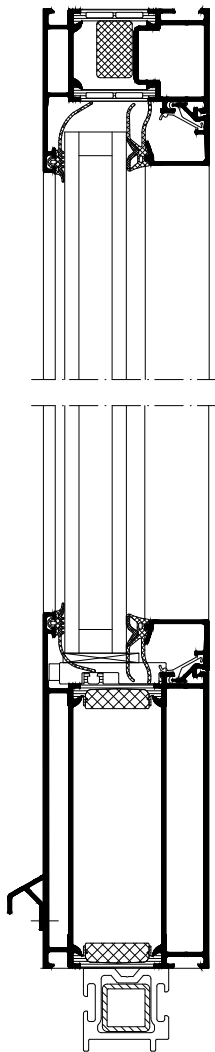

⑥

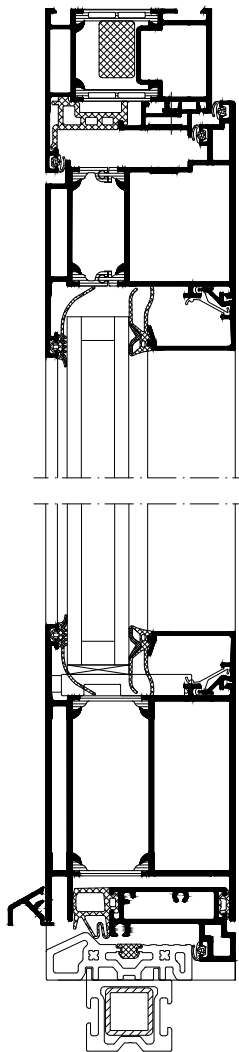

Elementschnitte
- Innen öffnend, aufschlagend
Unit section details
- Inward-opening, face-fitted

AB2000179

0201

Schüco ADS 70 HD

Einflügelige Tür mit Oberlicht
Single-leaf door with toplight

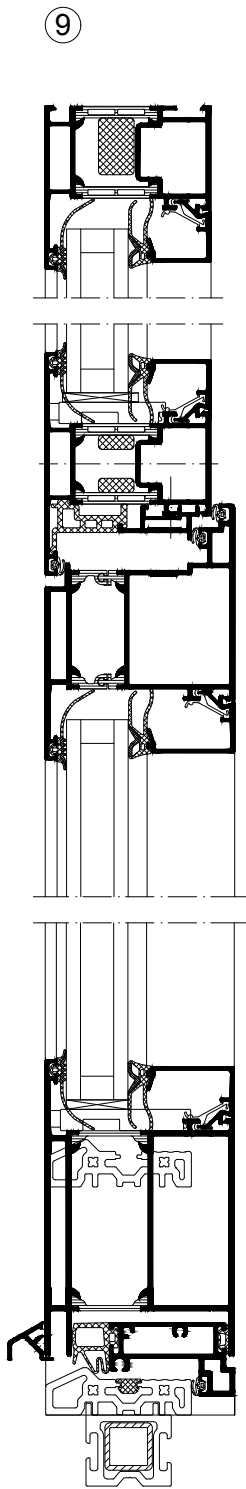
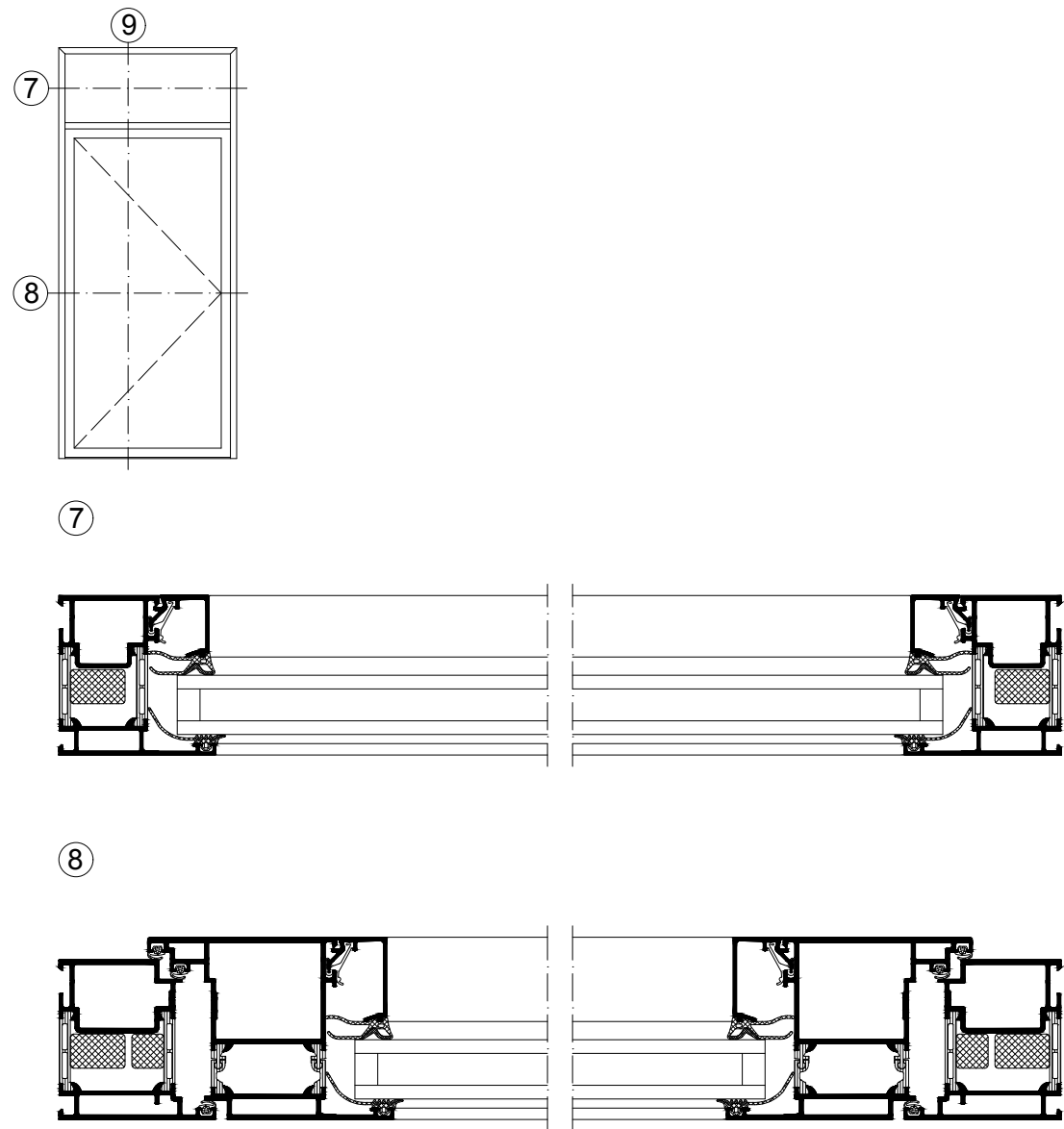

Elementschnitte
- Innen öffnend, aufschlagend
Unit section details
- Inward-opening, face-fitted

AB2000180

0201

Schüco ADS 70 HD

Einflügelige Tür mit Festfeld
Single-leaf door with fixed light

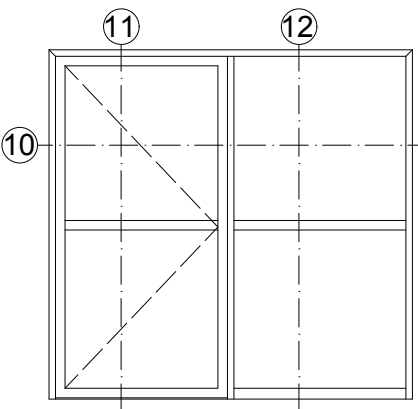

10

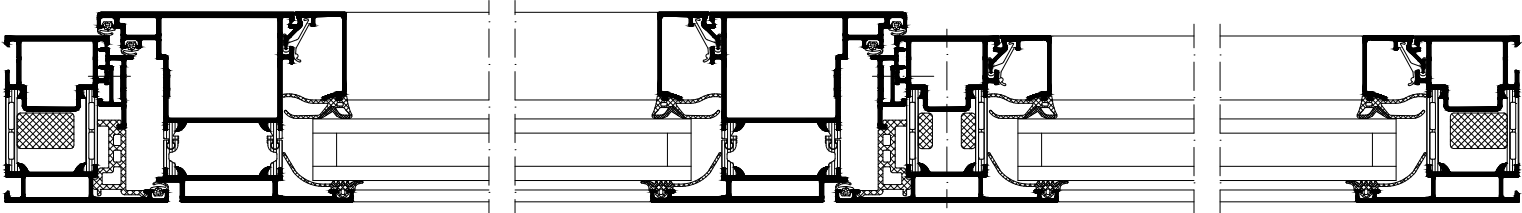

11

12

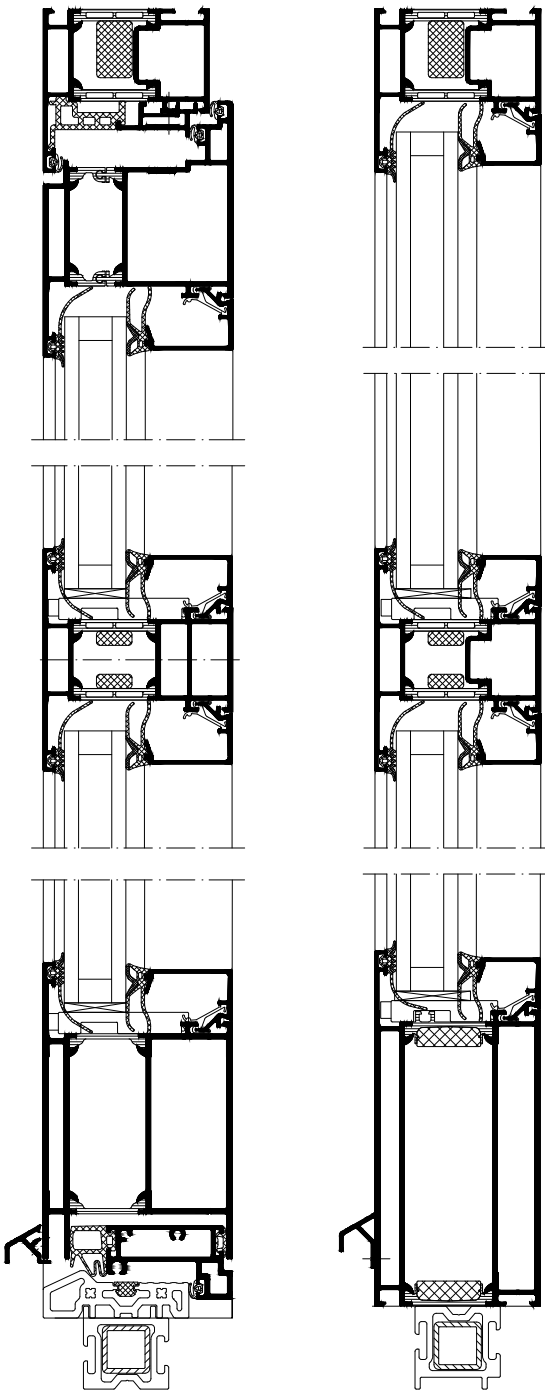

Elementschnitte
- Innen öffnend, aufschlagend
Unit section details
- Inward-opening, face-fitted

AB2000181

0201

Schüco ADS 70 HD

Zweiflügelige Tür mit Festfeld und Oberlicht
Double-leaf door with fixed light and toplight

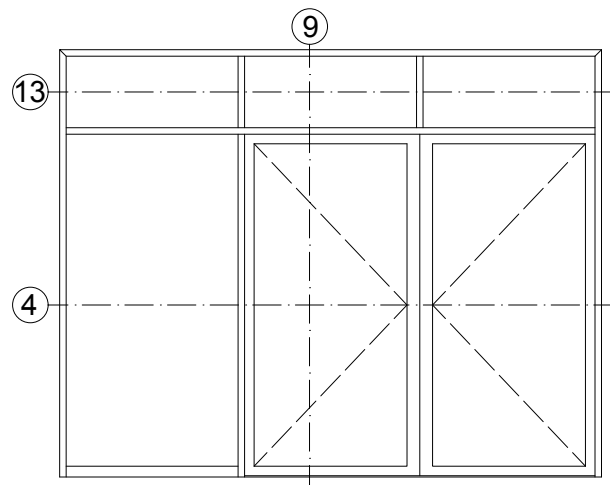

13

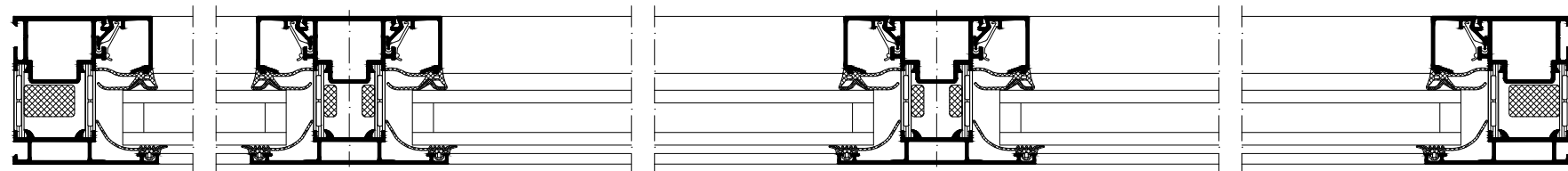

4

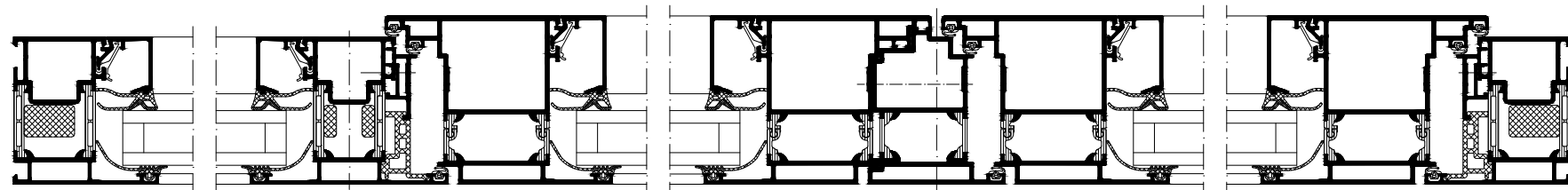

9

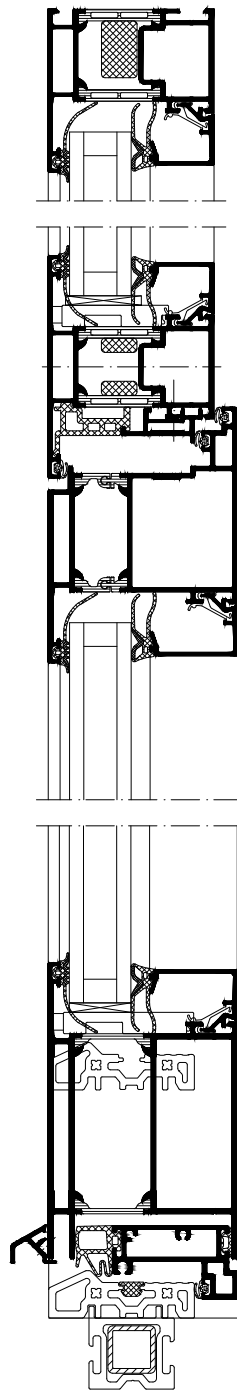

Elementschnitte
- Innen öffnend, aufschlagend
Unit section details
- Inward-opening, face-fitted

AB2000182

0201

Schüco ADS 70 HD

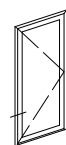

Blendraahmenprofil
Outer frame profile

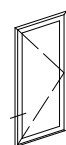
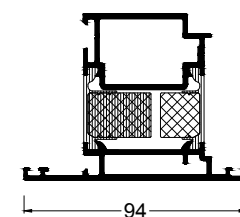
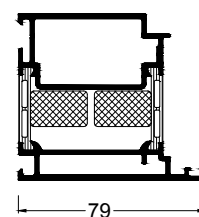
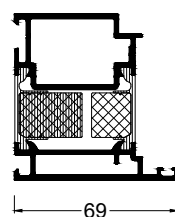
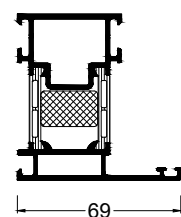
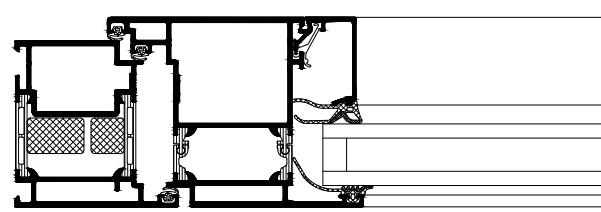

Flügelprofil
Leaf profile

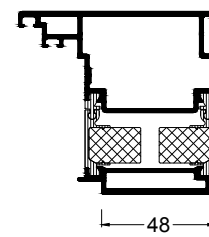
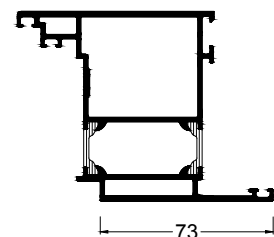
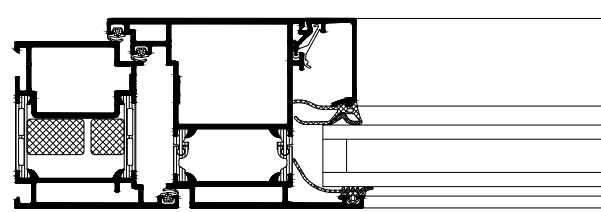

Flügelüberdeckend einseitig
Leaf-enclosing on one side

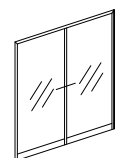

Riegel/Pfosten
Transom/mullion

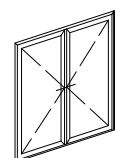
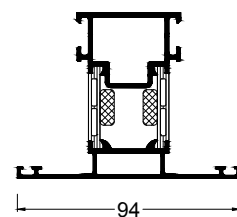
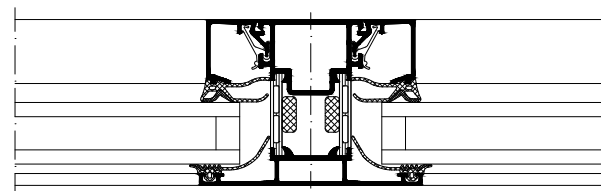

Stulpprofil
Meeting stile profile

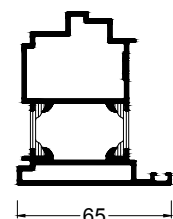
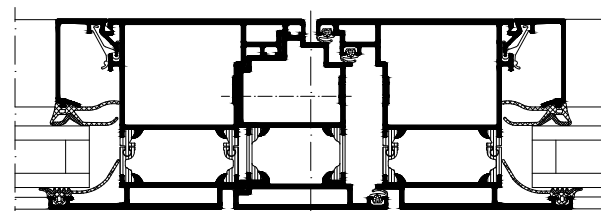

Profilsysteme
- Innen öffnend, aufschlagend
Profile systems
- Inward-opening, face-fitted

AB2000183

0201

Schüco ADS 70 HD

Einflügelige Tür
Single-leaf door

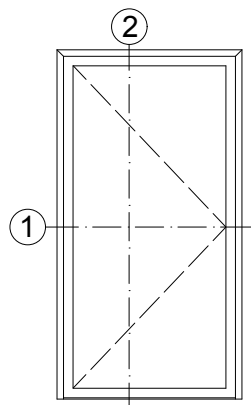

Zweiflügelige Tür
Double-leaf door

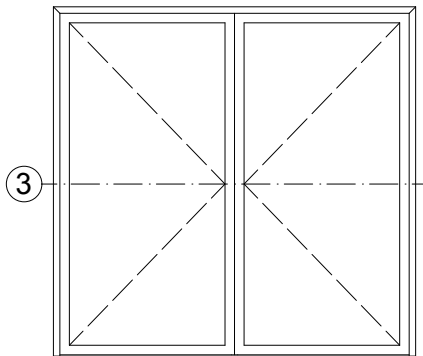

Elementbeispiele
- Innen öffnend mit Klemmschutz
Unit examples
- Inward-opening with finger-trap
protection

AB2000184

0201

Schüco ADS 70 HD

Einflügelige Tür
Single-leaf door

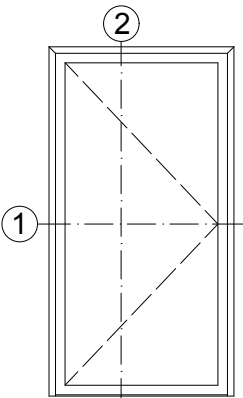

Zweiflügelige Tür
Double-leaf door

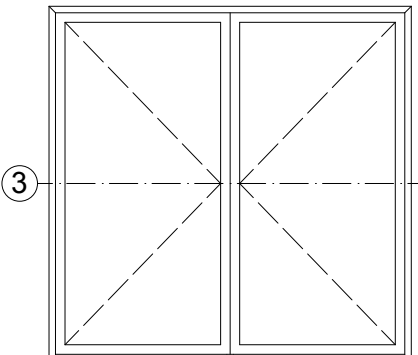

①



②



③

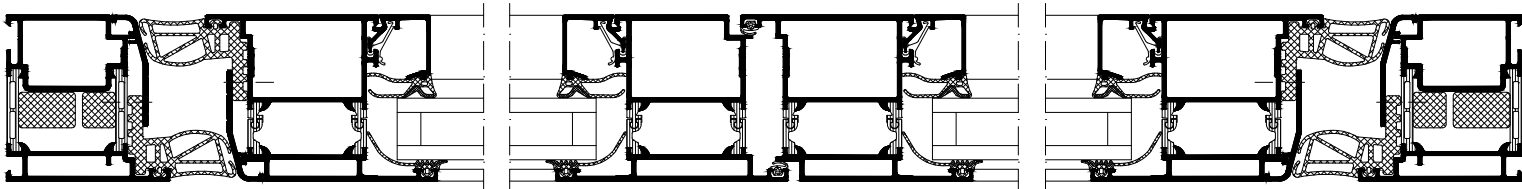

Elementschnitte - Innen öffnend mit
Klemmschutz

AB2000185

Unit section details
- Inward-opening with finger-trap
protection

0201

Schüco ADS 70 HD